

SOIL/SITE EVALUATION
for ON-SITE WASTEWATER SYSTEM

Owner: *GARY MORRISON* Applicant: _____ Date Evaluated: *4-26-21*
 Address: *174 Bayles Rd* Design Flow (.1949): *360 GPD* Property Size: _____
 Proposed Facility: *SFD* Property Recorded: _____
 Location of Site: _____
 Water Supply: Public Individual Well Spring Other
 Evaluation Method: Auger Boring Pit Cut
 Type of Wastewater: Sewage Industrial Process Mixed

P R O F I L E #	.1940 Landscape Position/ Slope %	Horizon Depth (In.)	SOIL MORPHOLOGY .1941		OTHER PROFILE FACTORS				Profile Class & LTAR
			.1941 Structure/ Texture	.1941 Consistence Mineralogy	.1942 Soil Wetness/ Color	.1943 Soil Depth (IN.)	.1956 Sapro Class	.1944 Restr Horiz	
1	<i>L</i> <i>25%</i>	<i>0-8</i>	<i>LS(A) Gr</i>		<i>10YR 7/1 ≥ 44"</i>	<i>> 48"</i>	—	—	<i>PS .5</i> <i>Group</i> <i>III</i>
		<i>8-12</i>	<i>LS Gr</i>						
		<i>12-48</i>	<i>SC1 SBk</i>						
2	<i>L</i> <i>25%</i>	<i>0-8</i>	<i>LS(A) Gr</i>		<i>10YR 7/1 ≥ 26"</i>	<i>> 48"</i>	—	—	<i>PS .5</i> <i>Group</i> <i>III</i>
		<i>8-10</i>	<i>LS Gr</i>						
		<i>10-48</i>	<i>SC1 SBk</i>						
3	<i>L</i> <i>25%</i>	<i>0-8</i>	<i>LS(A) Gr</i>		<i>10YR 7/1 ≥ 14"</i>	<i>> 48"</i>	—	—	<i>PS .5</i> <i>Group</i> <i>III</i> <i>(6" of cover)</i>
		<i>8-10</i>	<i>LS Gr</i>						
		<i>10-48</i>	<i>SC1 SBk</i>						
4	<i>L</i> <i>25%</i>	<i>0-8</i>	<i>LS(A) Gr</i>		<i>> 48"</i>	<i>> 48"</i>	—	—	<i>PS .5</i> <i>Group</i> <i>III</i>
		<i>8-12</i>	<i>LS Gr</i>						
		<i>12-48</i>	<i>SC1 SBk</i>						

Description	Initial System	Repair System	Other Factors (.1946): Site Classification (.1948): <i>PS</i> Evaluated By: <i>M Osborn REHT</i> Others Present:
Available Space (.1945)	<input checked="" type="checkbox"/>	<input checked="" type="checkbox"/>	
System Type(s)	<i>25% reduction</i>	<i>25% reduction</i>	
Site LTAR	<i>.5</i>	<i>.5</i>	

COMMENTS: _____

LANDSCAPE POSITIONS	GROUP	TEXTURES	.1955 LTAR	CONSISTENCE MOIST	WET
R-RIDGE	I	S-SAND	1.2 - 0.8	VFR-VERY FRIABLE	NS-NON-STICKY
S-SHOULDER SLOPE		LS-LOAMY SAND		FR-FRIABLE	SS-SLIGHTLY STICKY
L-LINEAR SLOPE	II	SL-SANDY LOAM	0.8 - 0.6	FI-FIRM	S-STICKY
FS-FOOT SLOPE		L-LOAM		VFI-VERY FIRM	VS-VERY STICKY
N-NOSE SLOPE	III	SI-SILT	0.6 - 0.3	EFI-EXTREMELY FIRM	NP-NON-PLASTIC
H-HEAD SLOPE		SIL-SILT LOAM		SP-SLIGHTLY STICKY	
CC-CONCLAVE SLOPE		CL-CLAY LOAM		P-PLASTIC	
CV-CONVEX SLOPE		SCL-SANDY CLAY LOAM		VP-VERY PLASTIC	
T-TERRACE	IV	SIC-SILTY CLAY	0.4 - 0.1		
FP-FLOOD PLAN		C-CLAY			
		SC-SANDY CLAY			

STRUCTURE
 SG-SINGLE GRAIN
 M-MASSIVE
 CR-CRUMB
 GR-GRANULAR
 SBK-SUBANGULAR BLOCKY
 ABK-ANGULAR BLOCKY
 PL-PLATY
 PR-PRISMATIC

MINERALOGY
 SLIGHTLY EXPANSIVE
 EXPANSIVE

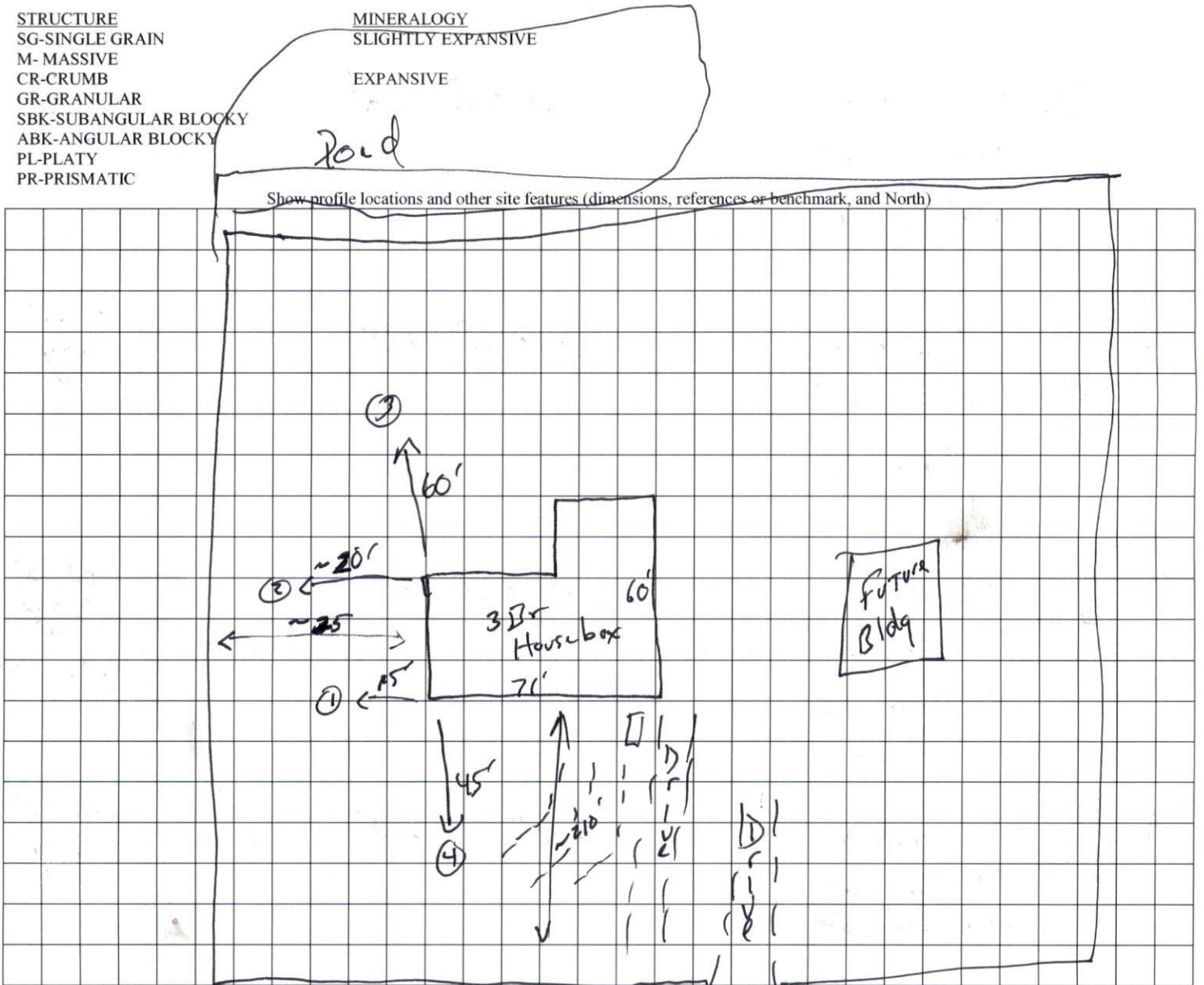

Show profile locations and other site features (dimensions, references or benchmark, and North)

(Need Irons)

Bayles
 (3) 60'x3