

SFD 2104-0024

SOIL/SITE EVALUATION
for ON-SITE WASTEWATER SYSTEM

Owner: Robert Boyer Applicant: Bogie Landing Dr
 Address: SFD Date Evaluated: 5-5-21
 Proposed Facility: SFD Design Flow (.1949): 360 GPD Property Size:
 Location of Site: Property Recorded:
 Water Supply: Public Individual Well Spring Other
 Evaluation Method: Auger Boring Pit Cut
 Type of Wastewater: Sewage Industrial Process Mixed

P R O F I L E #	.1940 Landscape Position/ Slope %	Horizon Depth (In.)	SOIL MORPHOLOGY .1941		OTHER PROFILE FACTORS				Profile Class & LTAR
			.1941 Structure/ Texture	.1941 Consistence Mineralogy	.1942 Soil Wetness/ Color	.1943 Soil Depth (IN.)	.1956 Sapro Class	.1944 Restr Horiz	
1.	L	0-8	LS(A) Gr	Vfr/ns/wp/nxp	10YR 6/2 ≥ 44" > 48"	—	—	PS. 4	
	2-56	8-16	LS Gr	Vfr/ns/wp/nxp				Group III	
		16-48	sci SBk	Fr/ss/sp/sxp					
2,3,4	L	0-8	LS(A) Gr		need pits				
	2-56	8-18	LS Gr		TO much rock				
		18-20	sci SBk		cant bore past 20"				
5,6 7,8	L	0-6	LS(A) Gr	Vfr/ns/wp/nxp	> 48"	> 48"	—	≤ 10% Rock	S .6
	5-76	6-48	SL Gr	Fr/ns/wp/nxp				Group I	

Description	Initial System	Repair System	Other Factors (.1946):
Available Space (.1945)	✓	✓	Site Classification (.1948):
System Type(s)	252 ind	252 ind	Evaluated By: <u>SMH REHS</u>
Site LTAR	.6	.6	Others Present:

COMMENTS: _____

LANDSCAPE POSITIONS

- R-RIDGE
- S-SHOULDER SLOPE
- L-LINEAR SLOPE
- FS-FOOT SLOPE
- N-NOSE SLOPE
- H-HEAD SLOPE
- CC-CONCLAVE SLOPE
- CV-CONVEX SLOPE
- T-TERRACE
- FP-FLOOD PLAN

STRUCTURE

- SG-SINGLE GRAIN
- M-MASSIVE
- CR-CRUMB
- GR-GRANULAR
- SBK-SUBANGULAR BLOCKY
- ABK-ANGULAR BLOCKY
- PL-PLATY
- PR-PRISMATIC

GROUP

- I
- II
- III
- IV

TEXTURES

- S-SAND
- LS-LOAMY SAND
- SL-SANDY LOAM
- L-LOAM
- SI-SILT
- SIL-SILT LOAM
- CL-CLAY LOAM
- SCL-SANDY CLAY LOAM
- SIC-SILTY CLAY
- C-CLAY
- SC-SANDY CLAY

MINERALOGY

- SLIGHTLY EXPANSIVE
- EXPANSIVE

.1955 LTAR

- 1.2 - 0.8
- 0.8 - 0.6
- 0.6 - 0.3
- 0.4 - 0.1

CONSISTENCE MOIST

- VFR-VERY FRIABLE
- FR-FRIABLE
- FI-FIRM
- VFI-VERY FIRM
- EFI-EXTREMELY FIRM

WET

- NS-NON-STICKY
- SS-SLIGHTLY STICKY
- S-STICKY
- VS-VERY STICKY
- NP-NON-PLASTIC
- SP-SLIGHTLY STICKY
- P-PLASTIC
- VP-VERY PLASTIC

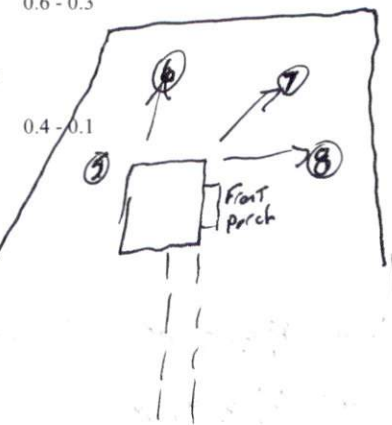

Show profile locations and other site features (dimensions, references or benchmark, and North)

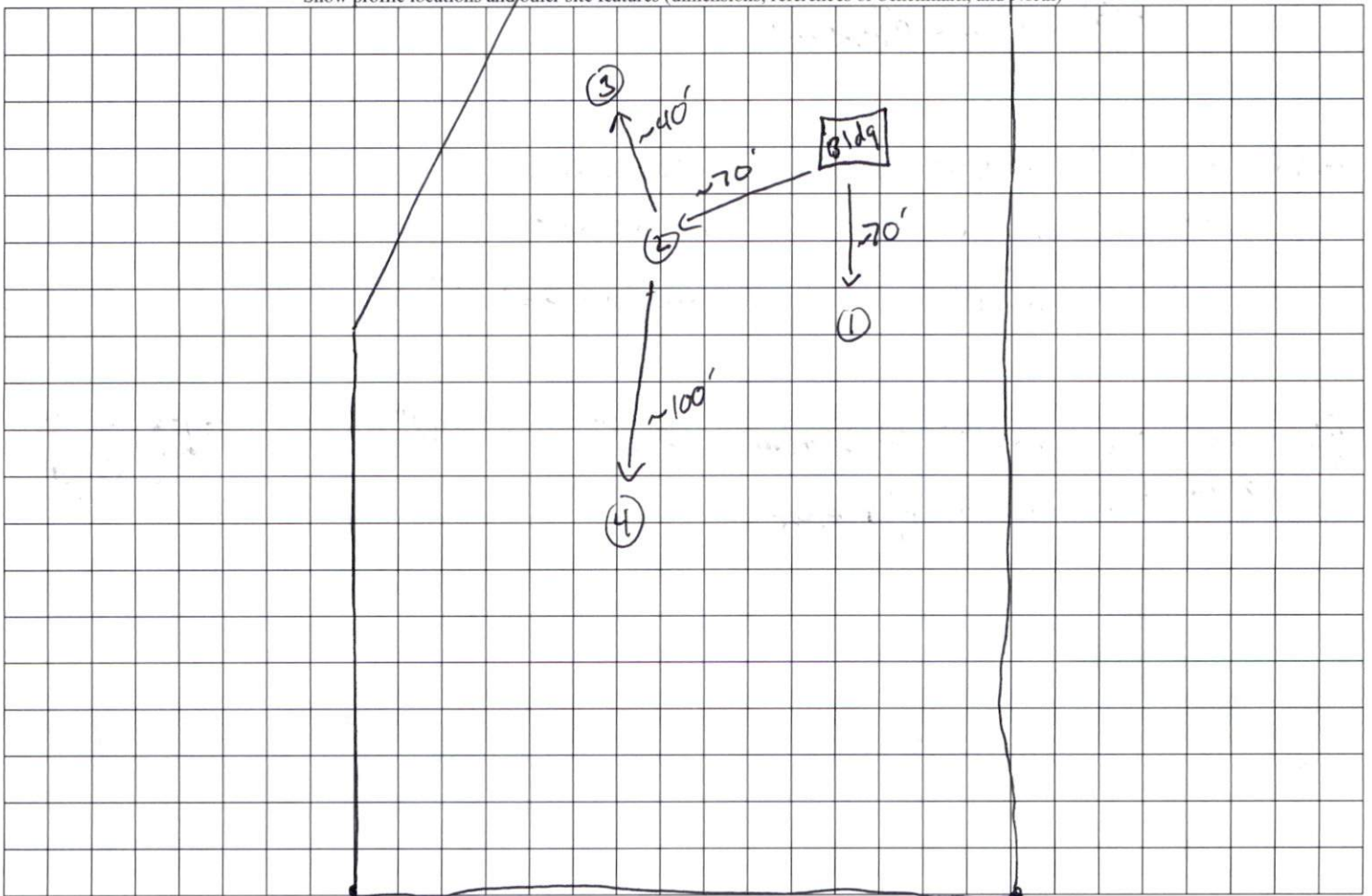

Bojia landing Dr