

**GDH Kerto-S LVL 1.750" X 14.000" 2-Ply - PASSED**

Level: Level

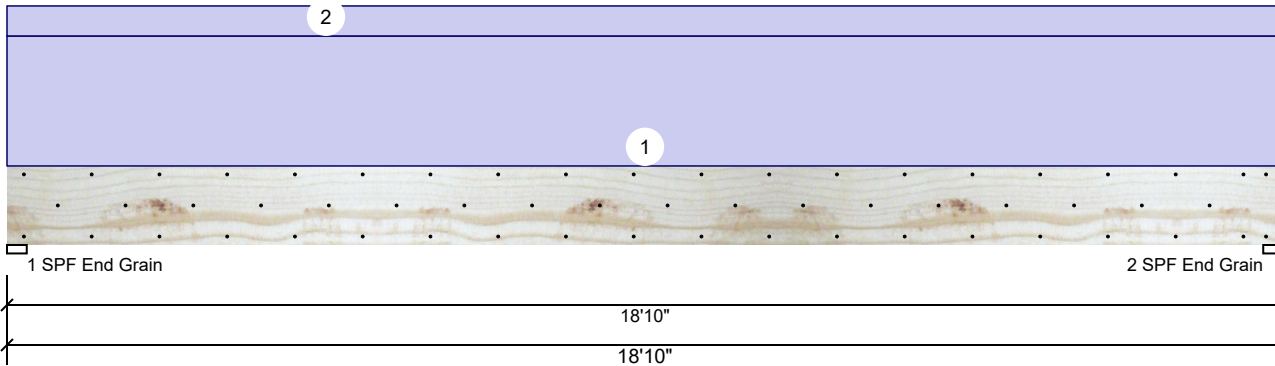

**Member Information**

|                     |               |                |              |
|---------------------|---------------|----------------|--------------|
| Type:               | Girder        | Application:   | Floor        |
| Plies:              | 2             | Design Method: | ASD          |
| Moisture Condition: | Dry           | Building Code: | IBC/IRC 2015 |
| Deflection LL:      | 480           | Load Sharing:  | No           |
| Deflection TL:      | 360           | Deck:          | Not Checked  |
| Importance:         | Normal        |                |              |
| Temperature:        | Temp <= 100°F |                |              |

**Reactions UNPATTERNED lb (Uplift)**

| Brg | Live | Dead | Snow | Wind | Const |
|-----|------|------|------|------|-------|
| 1   | 0    | 2363 | 0    | 0    | 0     |
| 2   | 0    | 2363 | 0    | 0    | 0     |

**Bearings**

| Bearing           | Length | Cap. React | D/L lb   | Total | Ld. Case | Ld. Comb. |
|-------------------|--------|------------|----------|-------|----------|-----------|
| 1 - SPF End Grain | 3.500" | 22%        | 2363 / 0 | 2363  | Uniform  | D         |
| 2 - SPF End Grain | 3.500" | 22%        | 2363 / 0 | 2363  | Uniform  | D         |

**Analysis Results**

| Analysis     | Actual        | Location  | Allowed       | Capacity     | Comb. | Case    |
|--------------|---------------|-----------|---------------|--------------|-------|---------|
| Moment       | 10589 ft-lb   | 9'5"      | 24299 ft-lb   | 0.436 (44%)  | D     | Uniform |
| Unbraced     | 10589 ft-lb   | 9'5"      | 10593 ft-lb   | 1.000 (100%) | D     | Uniform |
| Shear        | 2012 lb       | 1'4 3/4"  | 9408 lb       | 0.214 (21%)  | D     | Uniform |
| LL Defl inch | 0.000 (L/999) | 0         | 999.000 (L/0) | 0.000 (0%)   |       |         |
| TL Defl inch | 0.427 (L/516) | 9'5 1/16" | 0.612 (L/360) | 0.700 (70%)  | D     | Uniform |

**Design Notes**

- 1 Fasten all plies using 3 rows of 10d Box nails (.128x3") at 12" o.c. Maximum end distance not to exceed 6".
- 2 Refer to last page of calculations for fasteners required for specified loads.
- 3 Girders are designed to be supported on the bottom edge only.
- 4 Top loads must be supported equally by all plies.
- 5 Top must be laterally braced at a maximum of 10'1 1/2" o.c.
- 6 Bottom braced at bearings.
- 7 Lateral slenderness ratio based on single ply width.

| ID | Load Type   | Location | Trib Width | Side | Dead 0.9 | Live 1 | Snow 1.15 | Wind 1.6 | Const. 1.25 | Comments   |
|----|-------------|----------|------------|------|----------|--------|-----------|----------|-------------|------------|
| 1  | Uniform     |          |            | Top  | 195 PLF  | 0 PLF  | 0 PLF     | 0 PLF    | 0 PLF       | B1GE       |
| 2  | Uniform     |          |            | Top  | 45 PLF   | 0 PLF  | 0 PLF     | 0 PLF    | 0 PLF       | Wall Above |
|    | Self Weight |          |            |      | 11 PLF   |        |           |          |             |            |

**Notes**

Calculated Structured Designs is responsible only of the structural adequacy of this component based on the design criteria and loadings shown. It is the responsibility of the customer and/or the contractor to ensure the component suitability of the intended application, and to verify the dimensions and loads.

**Lumber**

1. Dry service conditions, unless noted otherwise
2. LVL not to be treated with fire retardant or corrosive chemicals

**Handling & Installation**

1. LVL beams must not be cut or drilled
2. Refer to manufacturer's product information regarding installation requirements, multi-ply fastening details, beam strength values, and code approvals
3. Damaged Beams must not be used
4. Design assumes top edge is laterally restrained
5. Provide lateral support at bearing points to avoid lateral displacement and rotation

6. For flat roofs provide proper drainage to prevent ponding

This design is valid until 2/26/2023

**Manufacturer Info**

Metsä Wood  
 301 Merritt 7 Building, 2nd Floor  
 Norwalk, CT 06851  
 (800) 622-5850  
 www.metsawood.com/us  
 ICC-ES: ESR-3633

Comtech, Inc.  
 1001 S. Reilly Road, Suite #639  
 Fayetteville, NC  
 USA  
 28314  
 910-864-TRUS



**GDH Kerto-S LVL 1.750" X 14.000" 2-Ply - PASSED**

Level: Level

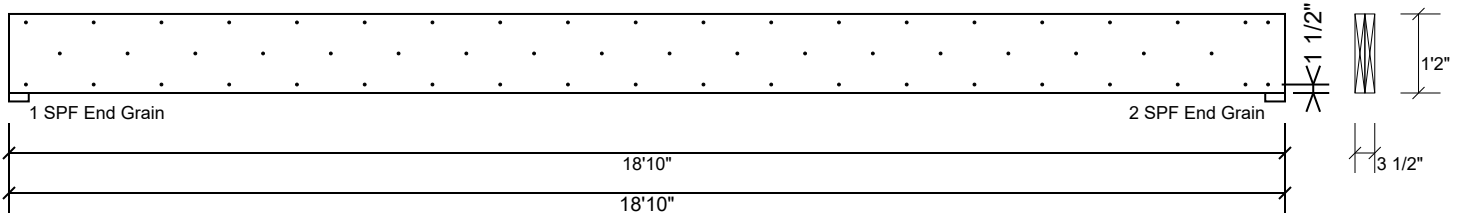

**Multi-Ply Analysis**

Fasten all plies using 3 rows of 10d Box nails (.128x3") at 12" o.c.. Maximum end distance not to exceed 6"

|                          |           |
|--------------------------|-----------|
| Capacity                 | 0.0 %     |
| Load                     | 0.0 PLF   |
| Yield Limit per Foot     | 245.6 PLF |
| Yield Limit per Fastener | 81.9 lb.  |
| Yield Mode               | IV        |
| Edge Distance            | 1 1/2"    |
| Min. End Distance        | 3"        |
| Load Combination         |           |
| Duration Factor          | 1.00      |

**Notes**

Calculated Structured Designs is responsible only of the structural adequacy of this component based on the design criteria and loadings shown. It is the responsibility of the customer and/or the contractor to ensure the component suitability of the intended application, and to verify the dimensions and loads.

**Lumber**

1. Dry service conditions, unless noted otherwise
2. LVL not to be treated with fire retardant or corrosive

chemicals

**Handling & Installation**

1. LVL beams must not be cut or drilled
2. Refer to manufacturer's product information regarding installation requirements, multi-ply fastening details, beam strength values, and code approvals
3. Damaged Beams must not be used
4. Design assumes top edge is laterally restrained
5. Provide lateral support at bearing points to avoid lateral displacement and rotation

6. For flat roofs provide proper drainage to prevent ponding

This design is valid until 2/26/2023

**Manufacturer Info**

Metsä Wood  
 301 Merritt 7 Building, 2nd Floor  
 Norwalk, CT 06851  
 (800) 622-5850  
 www.metsawood.com/us  
 ICC-ES: ESR-3633

Comtech, Inc.  
 1001 S. Reilly Road, Suite #639  
 Fayetteville, NC  
 USA  
 28314  
 910-864-TRUS

