



COMMENTS: \_\_\_\_\_

| LANDSCAPE POSITIONS | GROUP | TEXTURES                | .1955 LTAR | CONSISTENCE MOIST                              | WET  |
|---------------------|-------|-------------------------|------------|--|--|
| R-RIDGE             | I     | S-SAND                  | 1.2 - 0.8  | VFR-VERY FRIABLE<br>FR-FRIABLE                 | NS-NON-STICKY<br>SS-SLIGHTLY STICKY                                  |
| S-SHOULDER SLOPE    |       | LS-LOAMY SAND           |            |  |  |
| L-LINEAR SLOPE      | II    | SL-SANDY LOAM           | 0.8 - 0.6  | FI-FIRM<br>VFI-VERY FIRM<br>EFI-EXTREMELY FIRM | S-STICKY<br>VS-VERY STICKY   |
| FS-FOOT SLOPE       |       | L-LOAM                  |            |  |  |
| N-NOSE SLOPE        | III   | SI-SILT                 | 0.6 - 0.3  |  | NP-NON-PLASTIC<br>SP-SLIGHTLY STICKY<br>P-PLASTIC<br>VP-VERY PLASTIC |
| H-HEAD SLOPE        |       | SIL-SILT LOAM           |            |  |  |
| CC-CONCLAVE SLOPE   |       | CL-CLAY LOAM            |            |  |  |
| CV-CONVEX SLOPE     |       | SCL-SANDY CLAY LOAM     |            |  |  |
| T-TERRACE           | IV    | SIC-SILTY CLAY          | 0.4 - 0.1  |  |  |
| FP-FLOOD PLAN       |       | C-CLAY<br>SC-SANDY CLAY |            |  |  |

STRUCTURE  
 SG-SINGLE GRAIN  
 M- MASSIVE  
 CR-CRUMB  
 GR-GRANULAR  
 SBK-SUBANGULAR BLOCKY  
 ABK-ANGULAR BLOCKY  
 PL-PLATY  
 PR-PRISMATIC

MINERALOGY  
 SLIGHTLY EXPANSIVE  
 EXPANSIVE

Show profile locations and other site features (dimensions, references or benchmark, and North)

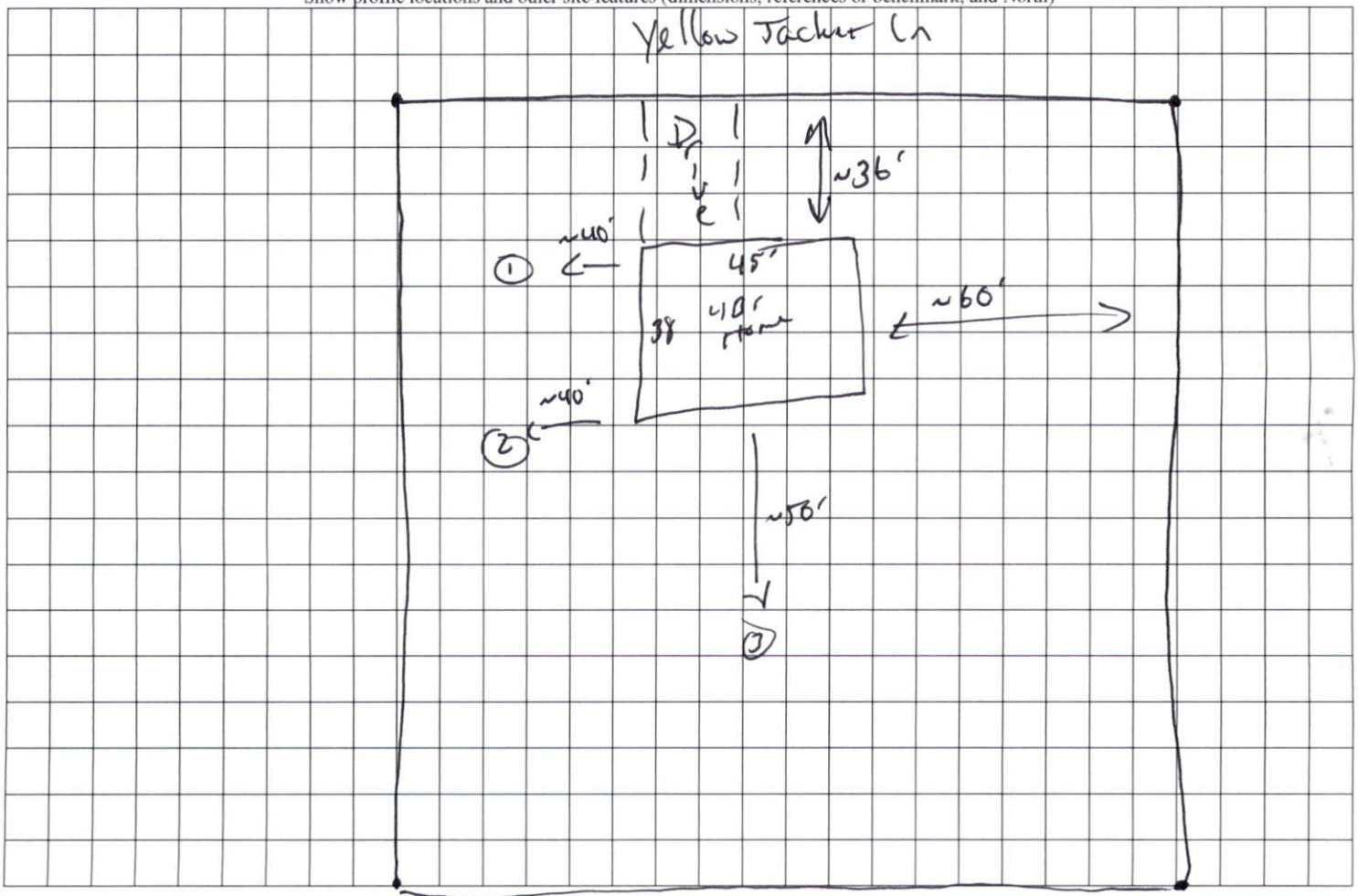

← Dirt rd →