

SFD 2104-0094

SOIL/SITE EVALUATION
for ON-SITE WASTEWATER SYSTEM

Owner: *Wicker* Applicant:

Address: *CONSTRUCTION 3637 Badgerose rd*

Date Evaluated: *4-8-21 + 6-1-21*

Proposed Facility: *SFD*

Design Flow (.1949): *600 GPD*

Property Size:

Location of Site:

Property Recorded:

Water Supply: Public Individual Well Spring Other

Evaluation Method: Auger Boring Pit Cut

Type of Wastewater: Sewage Industrial Process Mixed

P R O F I L E #	.1940 Landscape Position/ Slope %	Horizon Depth (In.)	SOIL MORPHOLOGY		OTHER PROFILE FACTORS				Profile Class & LTAR	
			.1941		.1942 Soil Wetness/ Color	.1943 Soil Depth (IN.)	.1956 Sapro Class	.1944 Restr Horiz		
			.1941 Structure/ Texture	.1941 Consistence Mineralogy						
1,2 4,6	L	0-10	LS	Gr	Fr/ns/wp/np	10YR 7/2 ≤ 12"	>48"	—	—	PS .4 Group <u>III</u>
		2-5%	10-48	sc1	SBk	Fi/s1/sp/sxp	10YR 6/2 ≤ 24"			
3,5	L	0-6	LS	Gr	Fr/ns/wp/np	10YR 7/2 ≤ 12"	>48"	—	—	U.
		2-5%	6-48	sc1	SBk	Fi/s1/sp/sxp	10YR 6/2 ≤ 12"			
7,8 9,10	L	0-16	LS	Gr	Fr/ns/wp/np	10YR 7/2 ≥ 36"	>48"	—	—	PS .4 Group <u>III</u>
		5-7%	16-48	sc1	SBk	Fi/s1/sp/sxp				

Description	Initial System	Repair System	Other Factors (.1946): Site Classification (.1948): <i>PS</i> Evaluated By: <i>M. Osborn R.E.H.S.</i> Others Present:
Available Space (.1945)	<input checked="" type="checkbox"/>	<input checked="" type="checkbox"/>	
System Type(s)	<i>252 rad</i>	<i>252 rad</i>	
Site LTAR	<i>.4</i>	<i>.4</i>	

(4) 94' x 3' or (5) 75' x 3'

COMMENTS: _____

LANDSCAPE POSITIONS	GROUP	TEXTURES	.1955 LTAR	CONSISTENCE MOIST	WET
R-RIDGE	I	S-SAND	1.2 - 0.8	VFR-VERY FRIABLE	NS-NON-STICKY
S-SHOULDER SLOPE		LS-LOAMY SAND			
L-LINEAR SLOPE	II	SL-SANDY LOAM	0.8 - 0.6	FI-FIRM	SS-SLIGHTLY STICKY
FS-FOOT SLOPE		L-LOAM			
N-NOSE SLOPE					
H-HEAD SLOPE	III	SI-SILT	0.6 - 0.3	VFI-VERY FIRM	VS-VERY STICKY
CC-CONCLAVE SLOPE		SIL-SILT LOAM			
CV-CONVEX SLOPE		CL-CLAY LOAM			
T-TERRACE		CCL-SANDY CLAY LOAM			
FP-FLOOD PLAN	IV	SIC-SILTY CLAY	0.4 - 0.1	EFI-EXTREMELY FIRM	NP-NON-PLASTIC
		C-CLAY			
		SC-SANDY CLAY			

STRUCTURE

- SG-SINGLE GRAIN
- M-MASSIVE
- CR-CRUMB
- GR-GRANULAR
- SBK-SUBANGULAR BLOCKY
- ABK-ANGULAR BLOCKY
- PL-PLATY
- PR-PRISMATIC

MINERALOGY

- SLIGHTLY EXPANSIVE
- EXPANSIVE

Show profile locations and other site features (dimensions, references or benchmark, and North)

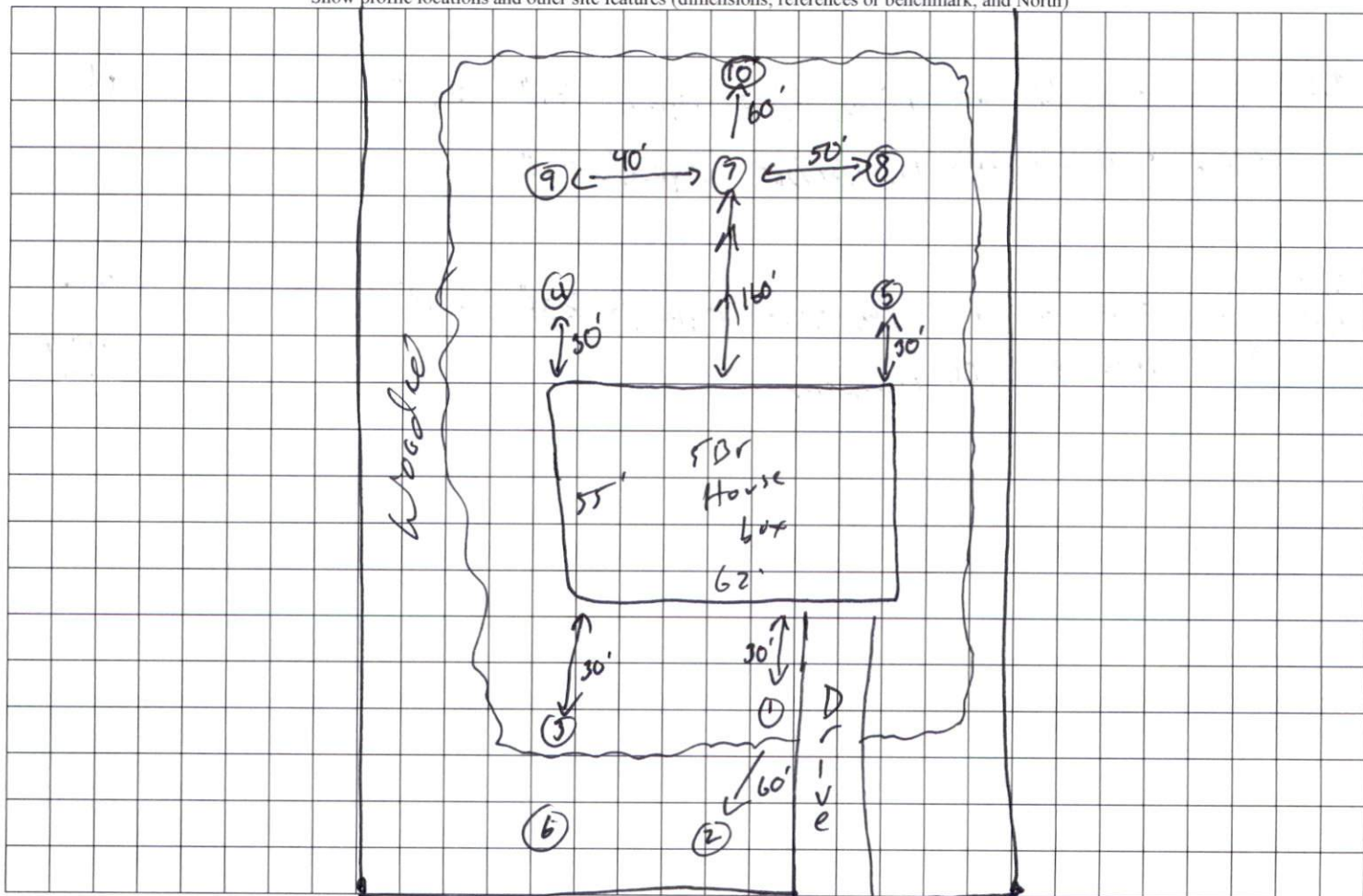

Ponderosa Rd