

**SOIL/SITE EVALUATION**  
**for ON-SITE WASTEWATER SYSTEM**

SFD 2103-0090

Owner: *Keene*  
 Applicant: *Cummins*

Address: *1374 Cameron Rd*

Date Evaluated: *4-19-21*  
 Design Flow (.1949): *360 GPD*

Property Size:

Location of Site:

Property Recorded:

Water Supply:  Public  Individual  Well  Spring  Other  
 Evaluation Method:  Auger Boring  Pit  Cut  
 Type of Wastewater:  Sewage  Industrial Process  Mixed

P R O F I L E #	.1940 Landscape Position/ Slope %	Horizon Depth (In.)	SOIL MORPHOLOGY .1941		OTHER PROFILE FACTORS				Profile Class & LTAR
			.1941 Structure/ Texture	.1941 Consistence Mineralogy	.1942 Soil Wetness/ Color	.1943 Soil Depth (IN.)	.1956 Sapro Class	.1944 Restr Horiz	
Pit 1	L 2-56	0-3	LS(A)Gr	Fi/ni/np/nxp	7.5YR 6/1	—	—	STONE ≥ 10%	PS. 4 Group III
		3-14	LS Gr	Fi/ni/np/nxp	≥ 32"				
		14-49	SCI SBk	Fi/ss/sp/sxp					
Pit 2	L 258	0-10	LS(A)Gr	Fi/ni/np/nxp	7.5YR 8/1 ≥ 44"	—	—	STONE ≥ 10%	PS. 4 Group III
		10-24	LS Gr	Fi/ni/np/nxp					
		24-56	SCI SBk	Fi/ss/sp/sxp					
Pit 3		0-11	LS(A)Gr	Fi/ni/np/nxp	7.5YR 8/1 ≥ 37"	—	—	STONE ≥ 10%	PS. 4 Group III
		11-24	LS Gr	Fi/ni/np/nxp					
		24-49	SCI SBk	Fi/ss/sp/sxp					
Pit 4		0-11	LS(A)Gr	Fi/ni/np/nxp	7.5YR 8/1 ≥ 34"	—	—	STONE ≥ 10%	PS. 4 Group III
		11-23	LS Gr	Fi/ni/np/nxp					
		23-54	SCI SBk	Fi/ss/sp/sxp					

Description	Initial System	Repair System	Other Factors (.1946): Site Classification (.1948): Evaluated By: <i>M. O'Brien R.E.H.</i> Others Present:
Available Space (.1945)	✓	✓	
System Type(s)	<i>258 rad</i>	<i>258 rad</i>	
Site LTAR	<i>.4</i>	<i>.4</i>	

COMMENTS: \_\_\_\_\_

LANDSCAPE POSITIONS	GROUP	TEXTURES	.1955 LTAR	CONSISTENCE MOIST	WET
R-RIDGE	I	S-SAND	1.2 - 0.8	VFR-VERY FRIABLE	NS-NON-STICKY
S-SHOULDER SLOPE		LS-LOAMY SAND			
L-LINEAR SLOPE	II	SL-SANDY LOAM	0.8 - 0.6	FI-FIRM	S-STICKY
FS-FOOT SLOPE		L-LOAM			
N-NOSE SLOPE	III	SI-SILT	0.6 - 0.3	VFI-VERY FIRM	VS-VERY STICKY
H-HEAD SLOPE		SIL-SILT LOAM			
CC-CONCLAVE SLOPE		CL-CLAY LOAM			
CV-CONVEX SLOPE		SCL-SANDY CLAY LOAM			
T-TERRACE	IV	SIC-SILTY CLAY	0.4 - 0.1	EFI-EXTREMELY FIRM	NP-NON-PLASTIC
FP-FLOOD PLAN		C-CLAY			
		SC-SANDY CLAY			

STRUCTURE  
 SG-SINGLE GRAIN  
 M-MASSIVE  
 CR-CRUMB  
 GR-GRANULAR  
 SBK-SUBANGULAR BLOCKY  
 ABK-ANGULAR BLOCKY  
 PL-PLATY  
 PR-PRISMATIC

MINERALOGY  
 SLIGHTLY EXPANSIVE  
 EXPANSIVE

Show profile locations and other site features (dimensions, references or benchmark, and North)

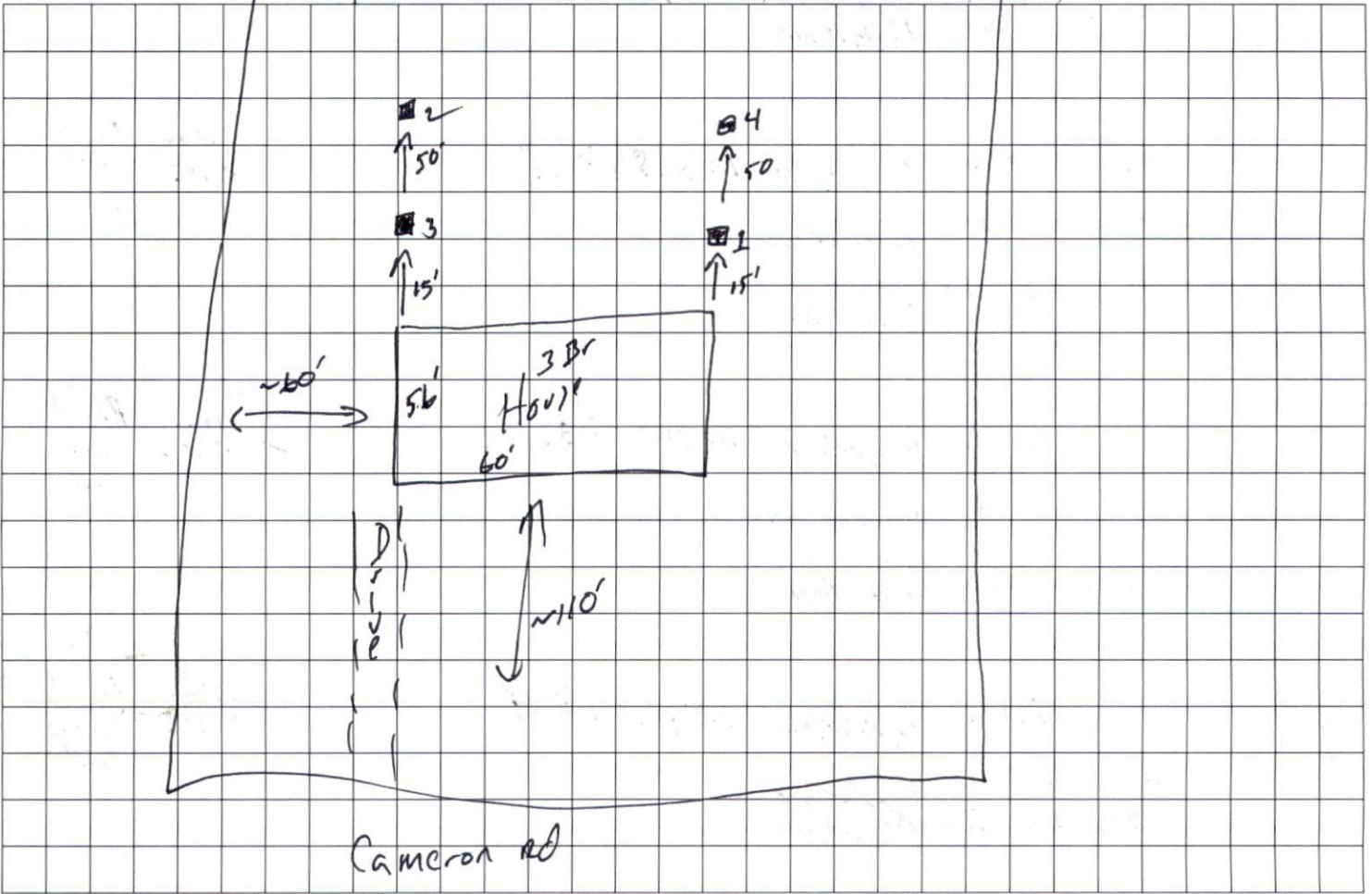





COMMENTS: \_\_\_\_\_

LANDSCAPE POSITIONS	GROUP	TEXTURES	.1955 LTAR	CONSISTENCE MOIST	WET
R-RIDGE	I	S-SAND	1.2 - 0.8	VFR-VERY FRIABLE FR-FRIABLE	NS-NON-STICKY SS-SLIGHTLY STICKY
S-SHOULDER SLOPE		LS-LOAMY SAND			
L-LINEAR SLOPE	II	SL-SANDY LOAM	0.8 - 0.6	FI-FIRM VFI-VERY FIRM EFI-EXTREMELY FIRM	S-STICKY VS-VERY STICKY NP-NON-PLASTIC
FS-FOOT SLOPE		L-LOAM			
N-NOSE SLOPE					
H-HEAD SLOPE	III	SI-SILT	0.6 - 0.3		SP-SLIGHTLY STICKY P-PLASTIC VP-VERY PLASTIC
CC-CONCLAVE SLOPE		SIL-SILT LOAM			
CV-CONVEX SLOPE		CL-CLAY LOAM			
T-TERRACE		SCL-SANDY CLAY LOAM			
FP-FLOOD PLAN	IV	SIC-SILTY CLAY	0.4 - 0.1		
		C-CLAY			
		SC-SANDY CLAY			

STRUCTURE  
 SG-SINGLE GRAIN  
 M- MASSIVE  
 CR-CRUMB  
 GR-GRANULAR  
 SBK-SUBANGULAR BLOCKY  
 ABK-ANGULAR BLOCKY  
 PL-PLATY  
 PR-PRISMATIC

MINERALOGY  
 SLIGHTLY EXPANSIVE  
 EXPANSIVE

Show profile locations and other site features (dimensions, references or benchmark, and North)

