

- LEGEND
- CL - CENTERLINE
 - ECM - EXISTING CONCRETE MONUMENT
 - EIP - EXISTING IRON PIPE
 - ERRS - EXISTING RAILROAD SPIKE
 - ESI - EXISTING SOLID IRON
 - SIS - SOLID IRON SET
 - SRRS - SET RAILROAD SPIKE
 - T.D. - TOTAL DISTANCE
 - PB - POWER BOX
 - - EXISTING SOLID IRON

BLACKBERRY MANOR, LLC
 DB 2300, P. 233
 MAP# 2000-390

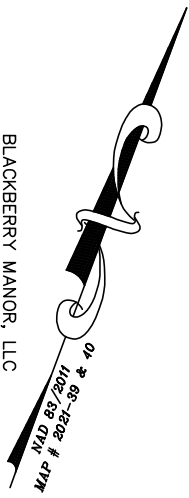

NOTE:
 AC. CAL. BY COMPUTER
 WATER.....PUBLIC
 SEWER.....PUBLIC
 ZONING.....R-20
 MIN. BUILDING SETBACK
 35' FRONT
 10' SIDE
 20' CORNER LOT
 25' REAR

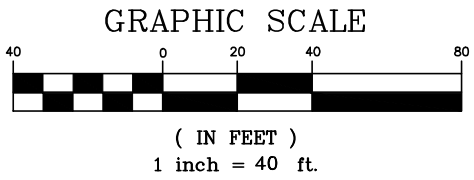

NOTE:
 THIS IS A PHYSICAL SURVEY ONLY:
 DOES NOT MEET GS47-30, NOT FOR RECORDATION.

NOTE:
 THIS SURVEY IS OF AN EXISTING PARCEL OR PARCELS.

NOTE:
 THIS PROPERTY IS SUBJECT TO ANY AND ALL EASEMENTS,
 RIGHT OF WAYS, AND AGREEMENTS OF RECORD PRIOR TO THIS PLAT.

OWNER:
 LAMCO CUSTOM BUILDERS, LLC
 7424 CHAPEL HILL ROAD
 SUITE 203
 RALEIGH, NC 27607

REFERENCE:
 LAMCO CUSTOM BUILDERS, LLC
 DB 3937, P. 4
 BLACKBERRY MANOR SUBDIVISION PHASE II-A
 MAP# 2021-39 & 40
 LOT 34

I, Thomas J. Matthews, certify that this map was drawn from an actual survey made under my supervision. Plat prepared in accordance with standards of "Professional Land Surveying in North Carolina".

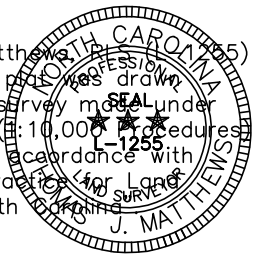

Thomas J. Matthews
 Thomas J. Matthews Date 04-15-2021

FOUNDATION SURVEY FOR: LAMCO CUSTOM BUILDERS, LLC. 355 KOTATA AVENUE		TOWNSHIP: STEWARTS CREEK	COUNTY: HARNETT
THOMAS J. MATTHEWS PROFESSIONAL LAND SURVEYOR 226 E. TRADE STREET SUITE 2 SANFORD, N.C. 27332 (919) 776-3400 matthewssurveying@yahoo.com		STATE: NORTH CAROLINA	DATE COMPLETED: 04-15-2021
SCALE: 1" = 40'	PARCEL: PID 120576 0006 05 PIN 0576-49-9556.000	REVISIONS:	JOB # 3928AFS LOT 34
ZONE: R-30	TAX MAP: 0576		