

Highland Grove 4-Bedroom Septic Proposal Lot #19

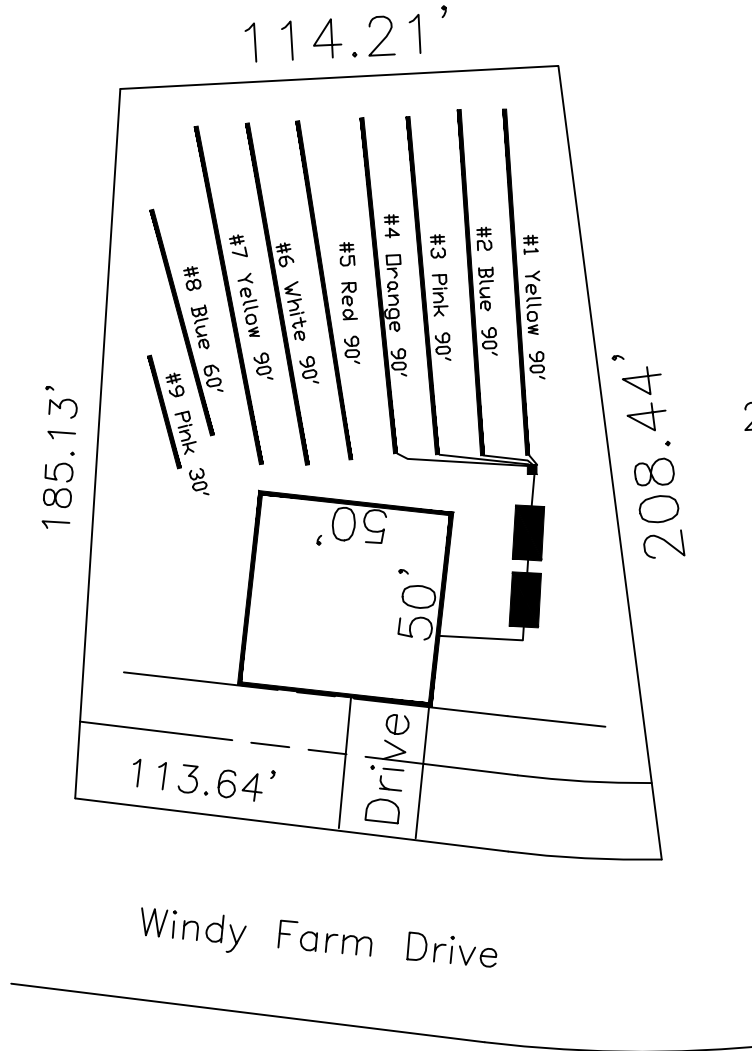

19

26,249 SQ.FT.

System: Gravity to D-Box
Lines: 1-4 (360')
0.35 LTAR
24" Trench Bottom
Accepted Status System
Repair: Pressure Manifold
Lines: 5-8 (360')
0.35 LTAR
24 Trench Bottom
Accepted Status System

This drawing represents a preliminary septic plan made prior to final construction activities. A revised plan may need to be reworked at time of permitting.

Adams
Soil Consulting
919-414-6761
Job #561