



**ECS Southeast, LLP**

6151 Raeford Road, Suite A  
Fayetteville, NC 28304  
9104013288  
9103230539

**LETTER OF TRANSMITTAL**

July 29, 2021  
Ben Stout Construction  
PO Box 53798  
Fayetteville, NC 28305  
ATTN: Zinford Hardin

RE: **Lot 13-1 Forest Ridge**  
ECS Job # **33:5664**  
  
Permits:  
Location: **436 Melody Ln**  
**Cameron, NC 28326**

Field Reports       For your use       As requested

CC:

ENCL: Field Report # 1      7/27/2021

Jack Edgar Cowsert, P.E.  
Senior Project Engineer

Donny Johnson  
Field Services Manager

*Disclaimer*

1. This report (and any attachments) shall not be reproduced except in full without prior written approval of ECS.
2. The information in this report relates only to the activities performed on the report date.
3. Where appropriate, this report includes statements as to compliance with applicable project drawings, and specifications for the activities, performed on this report date.
4. Incomplete or non-conforming work will be reported for future resolution.
5. The results of samples and/or specimens obtained or prepared for subsequent laboratory testing will be presented in separate reports/documents.



ECS Southeast, LLP  
 6151 Raeford Road, Suite A  
 Fayetteville, NC 28304  
 (910) 401-3288 [Phone]  
 (910) 323-0539 [Fax]

## FIELD REPORT

Project **Lot 13-1 Forest Ridge**  
 Location **Cameron, NC**  
 Client **Ben Stout Construction**  
 Contractor **Ben Stout Construction**

Project No. **33:5664**  
 Report No. **1**  
 Day & Date **Tuesday 7/27/2021**  
 Weather **88 °/ Sunny**  
 On-Site Time **1.00**  
 Lab Time **0.00**  
 Travel Time\* **0.00**  
 Total **1.00**  
 Re Obs Time **0.00**

Remarks

Trip Charges*	Tolls/Parking*	Mileage*	Time of Arrival	Departure
Chargeable Items			<b>2:30P</b>	<b>3:30P</b>

\* Travel time and mileage will be billed in accordance with the contract.

**Summary of Services Performed (field test data, locations, elevations & depths are estimates) & Individuals Contacted.**

An ECS representative arrived on site, as requested, to check the bearing capacity of soils via hand auger/DCP method for a footing that contractors previously cut 12 inches and replaced with 57 stone.

Please see the attached sketch for location details. NOTE: actual foundation is mirrored in reference to plans provided in the site box. Testing was conducted on the strip foundation opposite of the garage.

A hand auger was used to advance the boreholes to different depths noted on the boring logs. Dynamic Cone Penetrometer (DCP) test were performed in the hand auger boreholes by a 1.5 inch diameter cone driven into the soil by a 15 pound ring weight with a free fall of 20 inches. The number of blows required to drive the cone into the soil a distance of 1.75 inches is termed the DCP Value and is indicated for each test on the hand auger.

A total of 2 hand auger/DCP evaluations were performed to a depth of approximately 3 feet below the current sub grade elevation. Tests indicated that the materials in place (at the locations and elevations tested) did appear to be suitable to support a design bearing capacity 2000 psf.

The Contractor was notified of results at the time of testing, prior to departure from site.

ECS will return, as requested, to perform additional services.

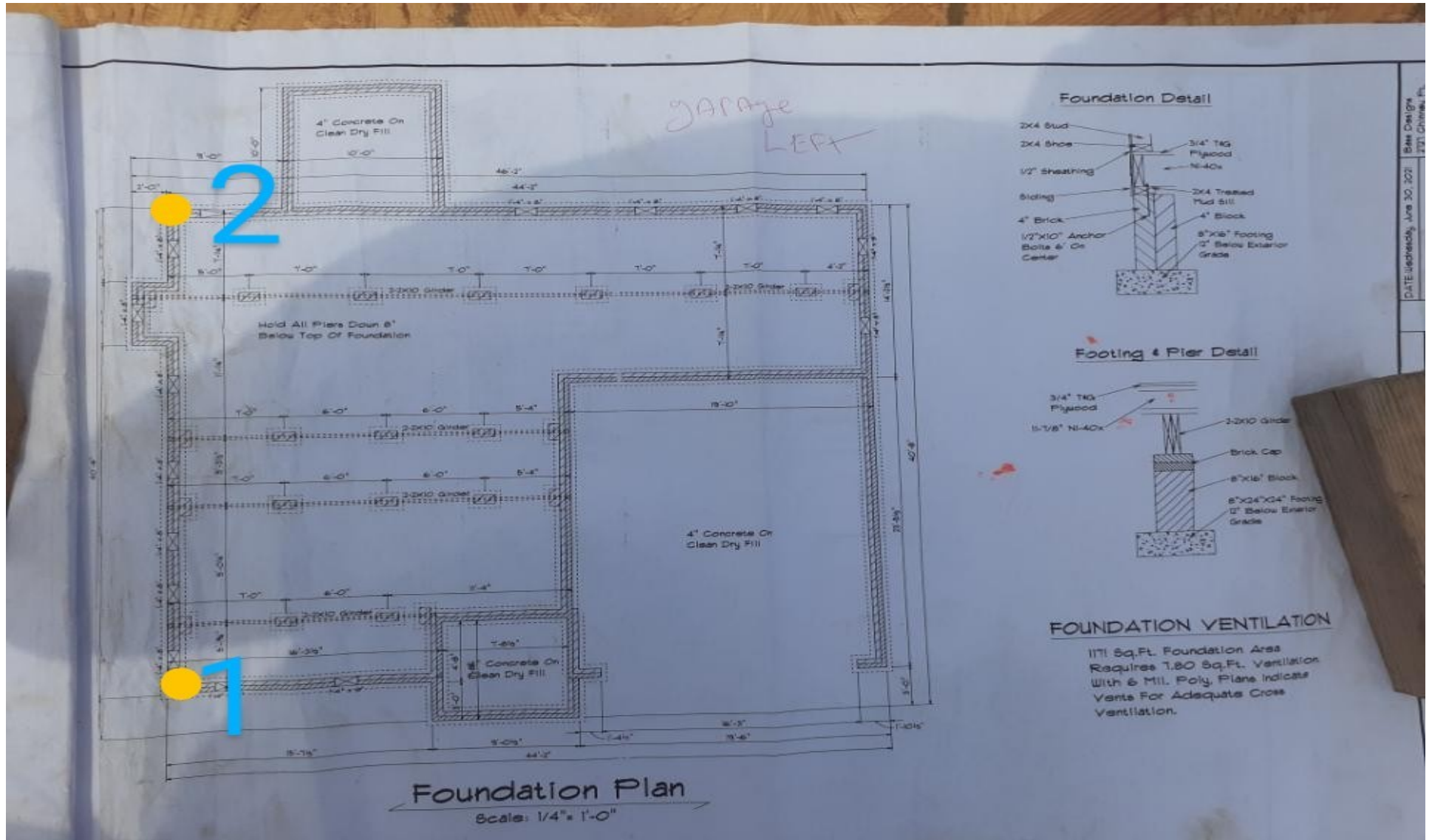

Kyra Mueller  
 7/27/2021  
 436 Melody Lane  
 Proj # 5664  
 W/O # 62379

KEY

DCP Test- YELLOW circle



NORTH





## Report of Spread Footing - Foundation Observations

Project: Lot 13-1 Forest Ridge  
 Location: 436 Melody Ln  
Cameron - Moore - NC - 28326  
 Contractor: Ben Stout Construction

Project No.: 33:5664  
 Day/Date: 7/27/2021

Footing Number	Location	Size (W x H x L)		Footing Bottom Elevation		Description of Steel Placed	Description of Subgrade Material	Required Blow Counts	Design Bearing Pressure
		Design	Actual	Design **	Depth of Undercut (in)			# of Blows / Increment	
1	1	x x	x x	N/A	-1'		tan clay sand	6 5-7-7	2000
1	1	x x	x x	N/A	-2'		tan clay sand	6 6-7-7	2000
1	1	x x	x x	N/A	-3'		tan clay sand	6 10-7-8	2000
2	2	x x	x x	N/A	-1'		tan clay sand	6 5-6-6	2000
2	2	x x	x x	N/A	-2'		tan clay sand	6 6-7-6	2000
2	2	x x	x x	N/A	-3'		tan clay sand	6 8-9-10	2000

\*\* SGE: Subgrade Elevation to be determined by surveyor.

By: Kyra Lee Mueller



## Report of Spread Footing - Foundation Observations

Project: Lot 13-1 Forest Ridge  
Location: 436 Melody Ln  
Cameron - Moore - NC - 28326  
Contractor: Ben Stout Construction

Project No.: 33:5664  
Day/Date: 7/27/2021

\_\_\_\_\_  
ECS Southeast, LLP

WO: 62379