



**ECS Southeast, LLP**

6151 Raeford Road, Suite A  
Fayetteville, NC 28304  
9104013288  
9103230539

**LETTER OF TRANSMITTAL**

October 8, 2021  
Ben Stout Construction  
PO Box 53798  
Fayetteville, NC 28305  
ATTN: Zinford Hardin

RE: **Forest Ridge Lot 13**  
ECS Job # **33:5565-D**  
Permits:  
Location: **121 Tanna PI**  
**Spout Springs, NC 28326**

Field Reports       For your use       As requested

CC:

ENCL: Field Report # 1      10/8/2021

Jack Edgar Cowsert, P.E.  
Senior Project Engineer

Donny Johnson  
Field Services Manager

*Disclaimer*

1. This report (and any attachments) shall not be reproduced except in full without prior written approval of ECS.
2. The information in this report relates only to the activities performed on the report date.
3. Where appropriate, this report includes statements as to compliance with applicable project drawings, and specifications for the activities, performed on this report date.
4. Incomplete or non-conforming work will be reported for future resolution.
5. The results of samples and/or specimens obtained or prepared for subsequent laboratory testing will be presented in separate reports/documents.



ECS Southeast, LLP  
 6151 Raeford Road, Suite A  
 Fayetteville, NC 28304  
 (910) 401-3288 [Phone]  
 (910) 323-0539 [Fax]

## FIELD REPORT

Project **Forest Ridge Lot 13**  
 Location **Spout Springs, NC**  
 Client **Ben Stout Construction**  
 Contractor **Ben Stout Construction**

Project No. **33:5565-D**  
 Report No. **1**  
 Day & Date **Friday 10/8/2021**  
 Weather **72 °/ Cloudy**  
 On-Site Time **2.50**  
 Lab Time **0.00**  
 Travel Time\* **0.00**  
 Total **2.50**  
 Re Obs Time **0.00**

Remarks

Trip Charges*	Tolls/Parking*	Mileage*	Time of Arrival	Departure
Chargeable Items			<b>8:45A</b>	<b>11:15A</b>

\* Travel time and mileage will be billed in accordance with the contract.

**Summary of Services Performed (field test data, locations, elevations & depths are estimates) & Individuals Contacted.**

The ECS Representative arrived on site, as requested, to check the bearing capacity of soils via hand auger/DCP method for foundation footings. Please see the attached sketch and data sheet for details.

A hand auger was used to advance the boreholes to different depths noted on the boring logs. Dynamic Cone Penetrometer (DCP) test were performed in the hand auger boreholes by a 1.5 inch diameter cone driven into the soil by a 15 pound ring weight with a free fall of 20 inches. The number of blows required to drive the cone into the soil a distance of 1.75 inches is termed the DCP Value and is indicated for each test on the hand auger.

A total of 3 hand auger/DCP evaluations were performed to a depth of approximately 3 feet below the current footing sub grade elevation. Test results indicated that the materials in place (at the locations and elevations tested) did appear to be suitable to support a design bearing capacity of 2000 psf. Soils did appear to be sufficiently placed and compacted.

ECS will return, as requested, for additional services.

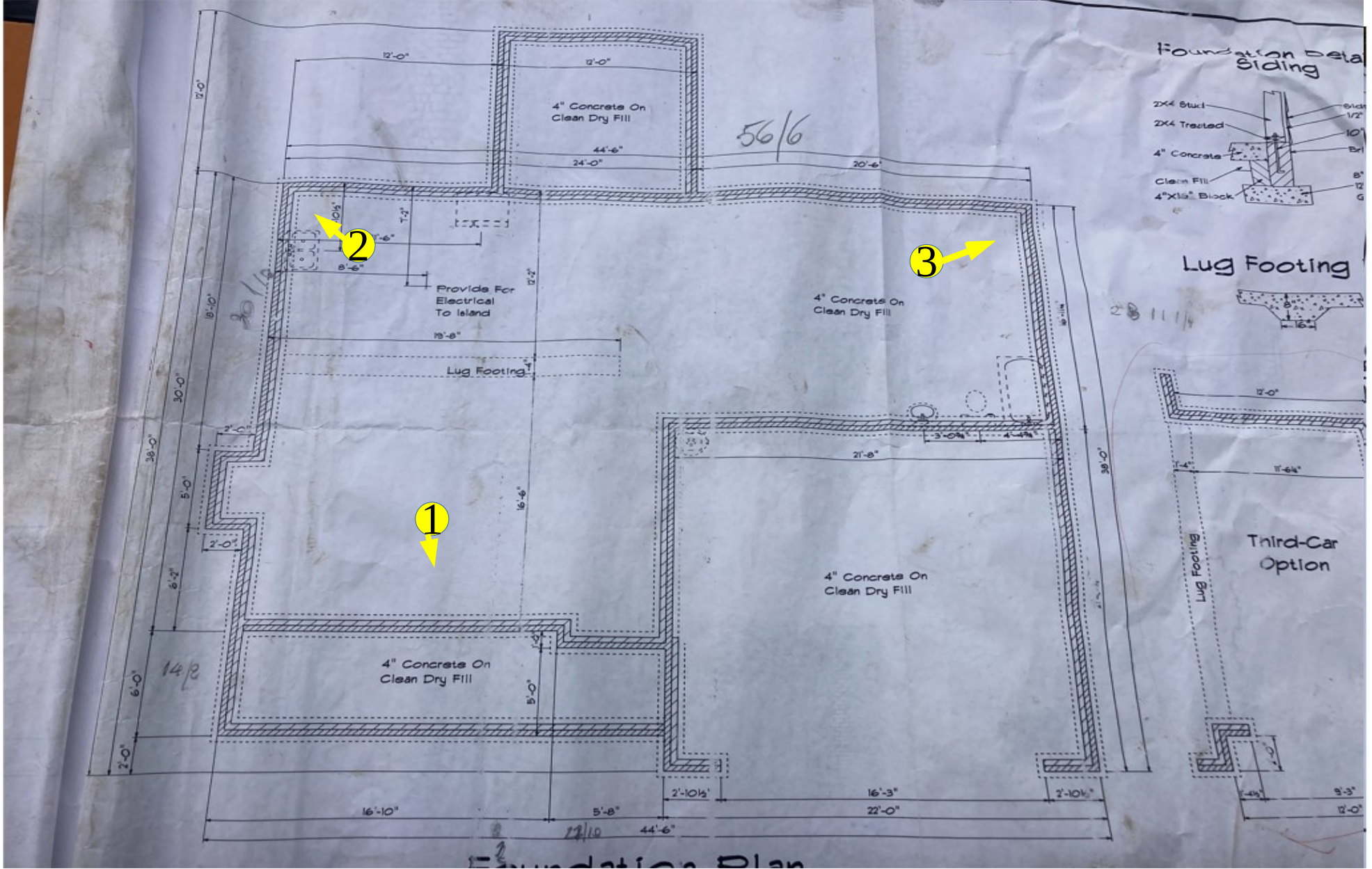

Tyson Boler  
 10/8/2021  
 Forest Ridge Lot 13  
 Proj # 5565-D  
 W/O # 63578

**Key NTS)**  
 DCP Sample Locations #



NORTH  
 ↑



## Report of Spread Footing - Foundation Observations

Project: Forest Ridge Lot 13  
 Location: 121 Tanna Pl  
 Spout Springs - Harnett - NC - 28326  
 Contractor: Ben Stout Construction

Project No.: 33:5565-D  
 Day/Date: 10/8/2021

Footing Number	Location	Size (W x H x L)		Footing Bottom Elevation		Description of Steel Placed	Description of Subgrade Material	Required Blow Counts # of Blows / Increment	Design Bearing Pressure
		Design	Actual	Design **	Depth of Undercut (in)				
1	Middle Of Front Stem Wall	x x	x x	N/A	0		Orange Clay Sand	6 4,5,6	2000
1	Middle Of Front Stem Wall	x x	x x	N/A	-1		Orange Clay Sand	6 8,9,10	2000
1	Middle Of Front Stem Wall	x x	x x	N/A	-2		Brown Clay Sand	6 9,9,23	2000
1	Middle Of Front Stem Wall	x x	x x	N/A	-3		Brown Clay Sand	6 19,25+	2000
2	Rear Right Corner (NorthEast)	x x	x x	N/A	0		Orange Clay Sand	6 4,5,5	2000
2	Rear Right Corner (NorthEast)	x x	x x	N/A	-1		Orange Clay Sand	6 11,8,10	2000
2	Rear Right Corner (NorthEast)	x x	x x	N/A	-2		Orange Clay Sand	6 10,10,8	2000
2	Rear Right Corner (NorthEast)	x x	x x	N/A	-2		Brown Clay Sand	6 5,6,6	2000
3	Left Rear Corner (NorthWest)	x x	x x	N/A	0		Orange Clay Sand	6 5,5,6	2000
3	Left Rear Corner (NorthWest)	x x	x x	N/A	-1		Orange Clay Sand	6 8,9,9	2000
3	Left Rear Corner (NorthWest)	x x	x x	N/A	-2		Tan Clay Sand	6 8,17,16	2000



## Report of Spread Footing - Foundation Observations

Project: Forest Ridge Lot 13  
 Location: 121 Tanna Pl  
Spout Springs - Harnett - NC - 28326  
 Contractor: Ben Stout Construction

Project No.: 33:5565-D  
 Day/Date: 10/8/2021

3	Left Rear Corner (NorthWest)	x x	x x	N/A	-3		Tan Clay Sand	6 10,12,12	2000
---	------------------------------------	-----	-----	-----	----	--	---------------	---------------	------

\*\* SGE: Subgrade Elevation to be determined by surveyor.

By: Ty Boler

ECS Southeast, LLP

WO: 63578