

## Harnett County Department of Public Health Improvement Permit

A building permit cannot be issued with only an Improvement Permit

PROPERTY LOCATION: 302 Planters Ln. (Red Hill Ch. Rd. - SR 17)  
SUBDIVISION Cane Mill Estates LOT # 14

ISSUED TO: Victoria Wicker/Smith Douglas Home

NEW  REPAIR  EXPANSION  Site Improvements required prior to Construction Authorization Issuance:

Type of Structure: 60x48 4bed/3.5ba w/deck

Proposed Wastewater System Type: 25% Reduction Sys.

Projected Daily Flow: 480 GPD

Number of bedrooms: 4 Number of Occupants: 8 max

Basement  Yes  No

Pump Required:  Yes  No  May be required based on final location and elevations of facilities

Type of Water Supply:  Community  Public  Well Distance from well NA feet

Permit conditions: \_\_\_\_\_ Permit valid for:  Five years  No expiration

Authorized State Agent:  Date: 03/24/2021 SEE ATTACHED SITE SKETCH

The issuance of this permit by the Health Department in no way guarantees the issuance of other permits. The permit holder is responsible for checking with appropriate governing bodies in meeting their requirements. This site is subject to revocation if the site plan, plat, or the intended use changes. The Improvement Permit shall not be affected by a change in ownership of the site. This permit is subject to compliance with the provisions of the Laws and Rules for Sewage Treatment and Disposal and to conditions of this permit.

### Construction Authorization (Required for Building Permit)

The construction and installation requirements of Rules .1950, .1952, .1954, .1955, .1956, .1957, 1958, and .1959 are incorporated by references into this permit and shall be met. Systems shall be installed in accordance with the attached system layout.

ISSUED TO: Victoria Wicker/Smit PROPERTY LOCATION: 302 Planters Ln. (Red Hill Ch. Rd. - SR  
SUBDIVISION Cane Mill Estates LOT # 14

Facility Type: 60x48 4bed/3.5ba w/deck  New  Expansion  Repair

Basement?  Yes  No Basement Fixtures?  Yes  No

Type of Wastewater System\*\* 25% Reduction System (Initial) Wastewater Flow: 480 GPD

(See note below, if applicable ) 25% / 50% Reduction System (Repair)

**Installation Requirements/Conditions**

Septic Tank Size <u>1000</u> gallons	Number of trenches <u>3</u>	Trench Spacing: <u>9</u> Feet on Center
Pump Tank Size _____ gallons	Exact length of each trench <u>100</u> feet	Soil Cover: <u>12-6</u> inches
	Trenches shall be installed on contour at a	(Maximum soil cover shall not exceed
	Maximum Trench Depth of: <u>24-18</u> inches	36" above the trench bottom)
	(Trench bottoms shall be level to +/- 1/4" in all directions)	

Pump Requirements: \_\_\_\_\_ ft. TDH vs. \_\_\_\_\_ GPM

Aggregate Depth: NA inches below pipe  
NA inches above pipe  
NA inches total

Conditions: Gravity to D-Box Equal Distribution

**WATER LINES (INCLUDING IRRIGATION) MUST BE 10FT. FROM ANY PART OF SEPTIC SYSTEM OR REPAIR AREA.  
NO UTILITIES ALLOWED IN INITIAL OR REPAIR DRAIN FIELD AREA.**

\*\*If applicable: I understand the system type specified is different from the type specified on the application. I accept the specifications of this permit.

Owner/Legal Representative Signature: \_\_\_\_\_ Date: \_\_\_\_\_

This Construction Authorization is subject to revocation if the site plan, plat, or the intended use changes. The Construction Authorization shall not be transferred when there is a change in ownership of the site. This Construction Authorization is subject to compliance with the provisions of the Laws and Rules for Sewage Treatment and Disposal and to the conditions of this permit. SEE ATTACHED SITE SKETCH

Authorized State Agent:  Date: 03/24/2021  
ANDREW LARKIN Construction Authorization Expiration Date: 03/24/2026

# Harnett County Department of Public Health Site Sketch

Property Location: 302 Planters Ln. (Red Hill Ch. Rd. - SR 1703)

Issued To: Victoria Wicker/Smith Douglas Homes Subdivision Cane Mill Estates Lot # 14

Authorized State Agent: *Andrew Corbin* Date: 03/24/2021  
ANDREW CORBIN

- \* GRAVITY TO D-BOX EQUAL DISTRIBUTION
- \* DEEP (24 IN) TO SHALLOW (18 IN) REQUIRED
- \* INSTALL AS HIGH UPHILL AS CONTOUR ALLOWS TO MAXIMIZE REPAIR AREA
- \* UTILITIES [WATER/POWER] SHALL BE ROUTED OUT OF SEPTIC AREAS + REPAIR AREAS

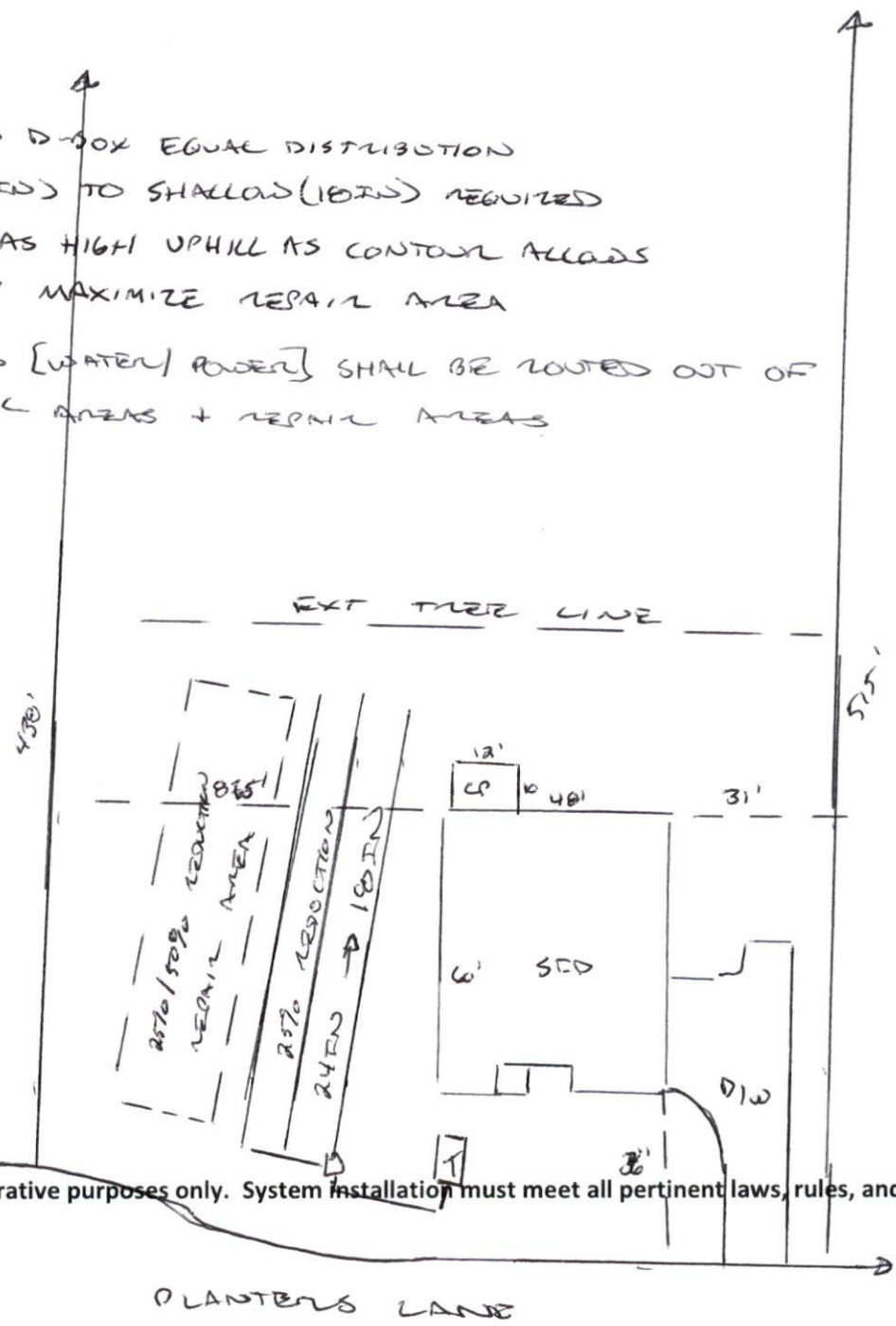

This drawing is for illustrative purposes only. System installation must meet all pertinent laws, rules, and regulations.