

Application # SFD 2102-0125

Harnett County Department of Public Health Site Sketch

Property Location: 561703 RED HILL CHURCH RD

Issued To: VICTORIA WICKER Subdivision CANE MILL ESTATES Lot # 12

Authorized State Agent: James E. Mendenhall JR Date: 3-25-21

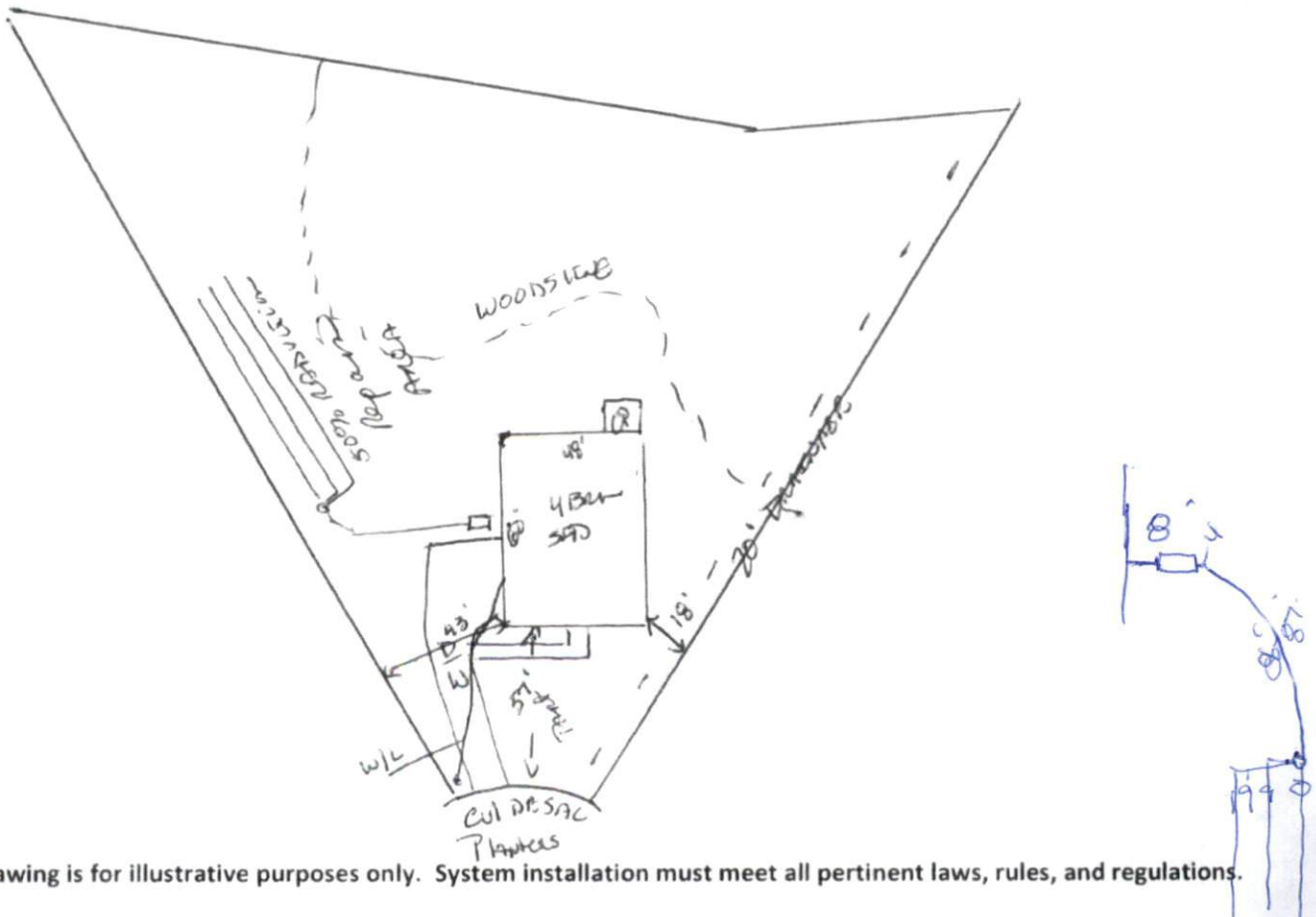

This drawing is for illustrative purposes only. System installation must meet all pertinent laws, rules, and regulations.