

SFD 2102-0111

**SOIL/SITE EVALUATION  
 for ON-SITE WASTEWATER SYSTEM**

Owner: Paul Lyons Applicant:

Address: 4731 NC 27W

Date Evaluated: 4-20-21

Proposed Facility: SFD

Design Flow (.1949): 600 GPD

Property Size:

Location of Site:

Property Recorded:

Water Supply:

- Public  Individual  Well  Spring  Other

Evaluation Method:  Auger Boring

- Pit  Cut

Type of Wastewater:

- Sewage  Industrial Process  Mixed

P R O F I L E #	.1940 Landscape Position/ Slope %	Horizon Depth (In.)	SOIL MORPHOLOGY .1941		OTHER PROFILE FACTORS				Profile Class & LTAR
			.1941 Structure/ Texture	.1941 Consistence Mineralogy	.1942 Soil Wetness/ Color	.1943 Soil Depth (IN.)	.1956 Sapro Class	.1944 Restr Horiz	
1, 2 3, 4	L	0-10	LS(A) Gr	Fr/us/wp/mep	10YR 6/2 Z	>48"	—	—	PS-3
	2-5%	10-48	SCI Silt	Fr/SS/SP/XP	4.6"				GROUP III

Description	Initial System	Repair System	Other Factors (.1946): Site Classification (.1948):
Available Space (.1945)	✓	✓	PS
System Type(s)	258 rad	258 rad	Evaluated By: M Osborne R.E.H.
Site LTAR	3	3	Others Present:

(4) 125' x 3' Lines

COMMENTS: \_\_\_\_\_

LANDSCAPE POSITIONS	GROUP	TEXTURES	.1955 LTAR	CONSISTENCE MOIST	WET
R-RIDGE	I	S-SAND	1.2 - 0.8	VFR-VERY FRIABLE FR-FRIABLE	NS-NON-STICKY SS-SLIGHTLY STICKY
S-SHOULDER SLOPE		LS-LOAMY SAND			
L-LINEAR SLOPE	II	SL-SANDY LOAM	0.8 - 0.6	FI-FIRM VFI-VERY FIRM EFI-EXTREMELY FIRM	S-STICKY VS-VERY STICKY NP-NON-PLASTIC SP-SLIGHTLY STICKY
FS-FOOT SLOPE		L-LOAM			
N-NOSE SLOPE	III	SI-SILT	0.6 - 0.3		P-PLASTIC VP-VERY PLASTIC
H-HEAD SLOPE		SIL-SILT LOAM			
CC-CONCLAVE SLOPE		CL-CLAY LOAM			
CV-CONVEX SLOPE		SCL-SANDY CLAY LOAM			
T-TERRACE	IV	SIC-SILTY CLAY	0.4 - 0.1		
FP-FLOOD PLAN		C-CLAY SC-SANDY CLAY			

**STRUCTURE**  
 SG-SINGLE GRAIN  
 M-MASSIVE  
 CR-CRUMB  
 GR-GRANULAR  
 SBK-SUBANGULAR BLOCKY  
 ABK-ANGULAR BLOCKY  
 PL-PLATY  
 PR-PRISMATIC

**MINERALOGY**  
 SLIGHTLY EXPANSIVE  
 EXPANSIVE

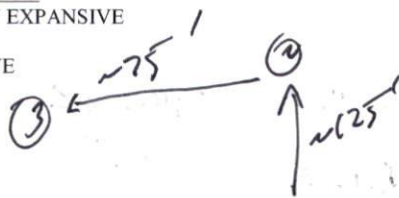

Show profile locations and other site features (dimensions, references or benchmark, and North)

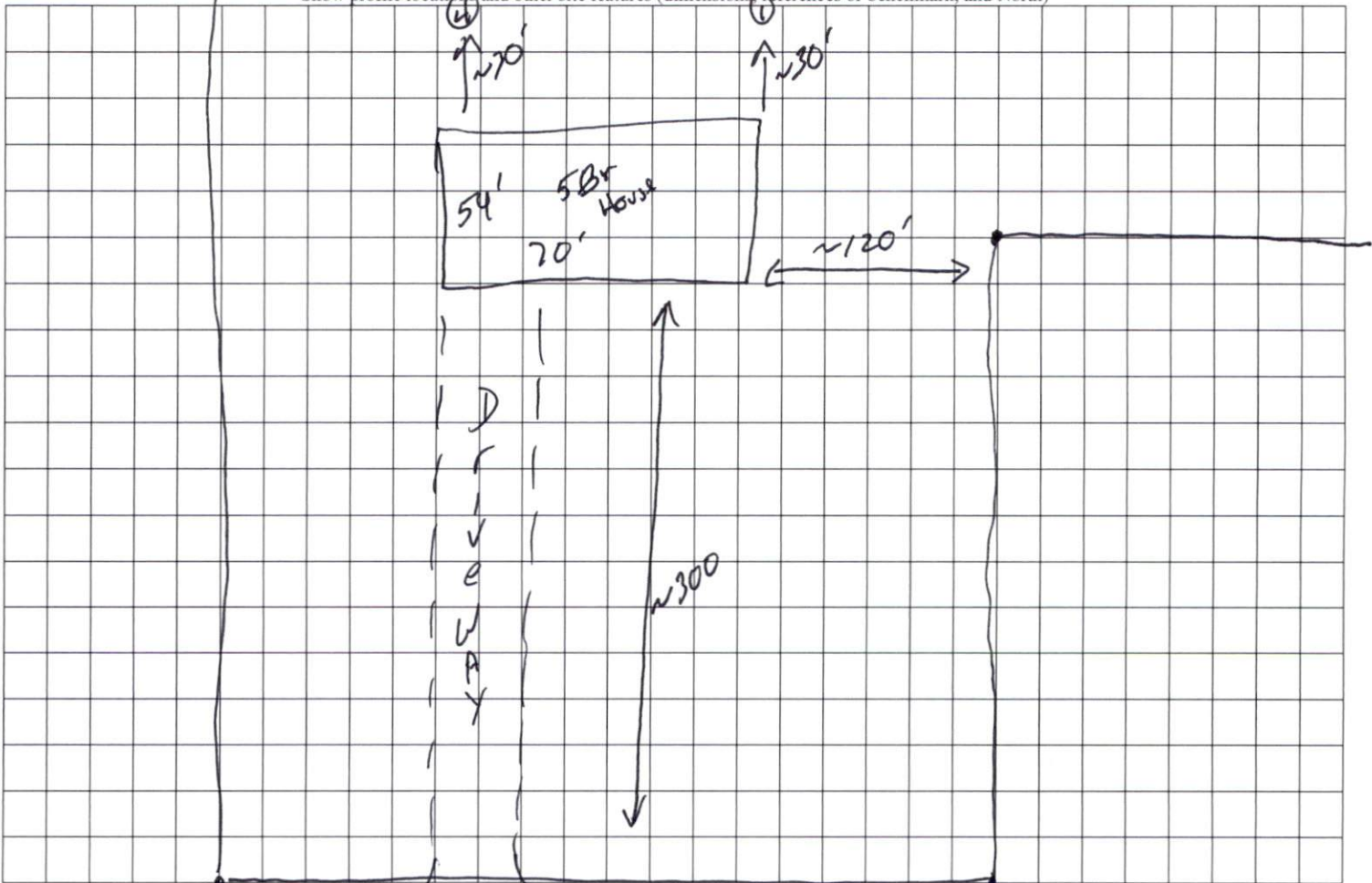

NC-27 W