

Harnett County Department of Public Health

Improvement Permit

A building permit cannot be issued with only an Improvement Permit

ISSUED TO: GREENWOOD BLDG LLL PROPERTY LOCATION: 45 WADE STEPHENSON RD. (S11467)
 SUBDIVISION _____ LOT # 3
 NEW REPAIR EXPANSION Site Improvements required prior to Construction Authorization Issuance: _____
 Type of Structure: 4-BEDROOM 68'x54' S.D.
 Proposed Wastewater System Type: 25% REDUCTION SIS
 Projected Daily Flow: 480 GPD
 Number of bedrooms: 4 Number of Occupants: 8 max
 Basement Yes No
 Pump Required: Yes No May be required based on final location and elevations of facilities
 Type of Water Supply: Community Public Well Distance from well NA feet Permit valid for: Five years
 No expiration
 Permit conditions: _____

Authorized State Agent: [Signature] Date: 03/12/2021 SEE ATTACHED SITE SKETCH
 The issuance of this permit by the Health Department in no way guarantees the issuance of other permits. The permit holder is responsible for checking with appropriate governing bodies in meeting their requirements. This site is subject to revocation if the site plan, plat, or the intended use changes. The Improvement Permit shall not be affected by a change in ownership of the site. This permit is subject to compliance with the provisions of the Laws and Rules for Sewage Treatment and Disposal and to conditions of this permit.

Construction Authorization

(Required for Building Permit)

The construction and installation requirements of Rules .1950, .1952, .1954, .1955, .1956, .1957, .1958, and .1959 are incorporated by references into this permit and shall be met. Systems shall be installed in accordance with the attached system layout.

ISSUED TO: GREENWOOD BLDG LLL PROPERTY LOCATION: 45 WADE STEPHENSON RD (S11467)
 SUBDIVISION _____ LOT # 3
 Facility Type: 4-02 68'x54' S.D. New Expansion Repair
 Basement? Yes No Basement Fixtures? Yes No
 Type of Wastewater System** PUMP TO 25% REDUCTION SYSTEM (Initial) Wastewater Flow: 480 GPD
 (See note below, if applicable PUMP TO 25% REDUCTION (Repair))

Installation Requirements/Conditions

Septic Tank Size <u>1250</u> gallons	Number of trenches <u>3</u>	Trench Spacing: <u>9</u> Feet on Center
Pump Tank Size <u>1250</u> gallons	Exact length of each trench <u>115</u> feet	Soil Cover: <u>8</u> inches
	Trenches shall be installed on contour at a	(Maximum soil cover shall not exceed
	Maximum Trench Depth of: <u>20</u> inches	36" above the trench bottom)
	(Trench bottoms shall be level to +/-1/4"	
	in all directions)	
Pump Requirements: _____ ft. TDH vs. _____ GPM		Aggregate Depth: <u>NA</u> inches below pipe
		<u>NA</u> inches above pipe
Conditions: <u>PUMP TO MEDIAN DRINK EQUAL DISTRIBUTION</u>		<u>NA</u> inches total

**WATER LINES (INCLUDING IRRIGATION) MUST BE 10FT. FROM ANY PART OF SEPTIC SYSTEM OR REPAIR AREA.
 NO UTILITIES ALLOWED IN INITIAL OR REPAIR DRAIN FIELD AREA.**

**If applicable: I understand the system type specified is different from the type specified on the application. I accept the specifications of this permit.
 Owner/Legal Representative Signature: _____ Date: _____

This Construction Authorization is subject to revocation if the site plan, plat, or the intended use changes. The Construction Authorization shall not be transferred when there is a change in ownership of the site. This Construction Authorization is subject to compliance with the provisions of the Laws and Rules for Sewage Treatment and Disposal and to the conditions of this permit. SEE ATTACHED SITE SKETCH

Authorized State Agent: [Signature] Date: 03/12/2021
ANDREW COLLINS Construction Authorization Expiration Date: 03/12/2026

Application # SFD2102-007C

Harnett County Department of Public Health Site Sketch

Property Location: 45 WADE STEPHENSON RD (571467)

Issued To: CLEWOOD GLDS LLC Subdivision _____ Lot # 3

Authorized State Agent: [Signature] Date: 03/12/2021

ANDREW CURRIN

- * PUMP TO MEDIUM D-DUX EQUAL DISTRIBUTION
- * REVIEW PLUMBING PRE-INSTALL PUMP MAY NOT BE REQUIRED BUT MORE THAN LIKELY REQUIRED

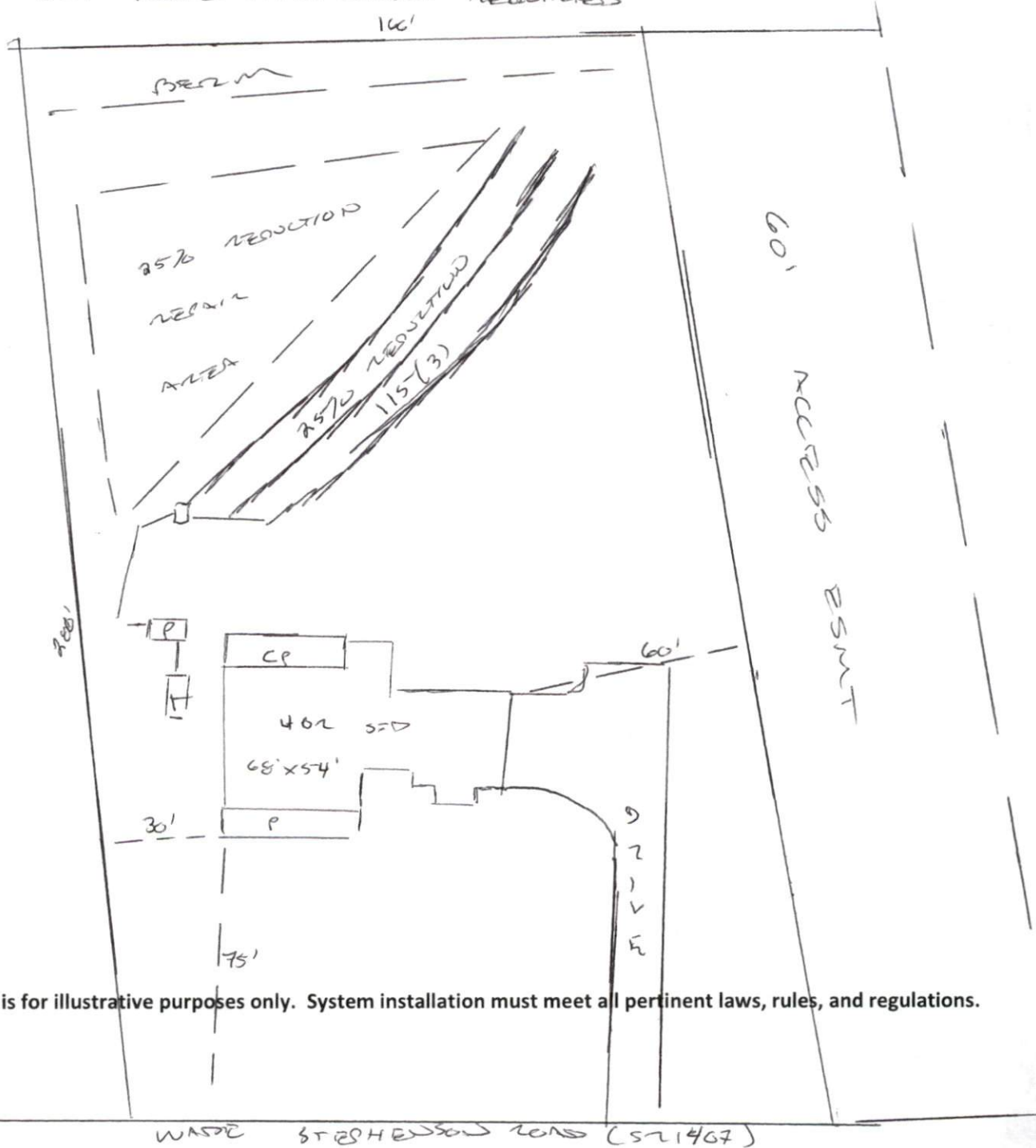

This drawing is for illustrative purposes only. System installation must meet all pertinent laws, rules, and regulations.

7