

Highland Grove 3-Bedroom Septic Proposal Lot #20

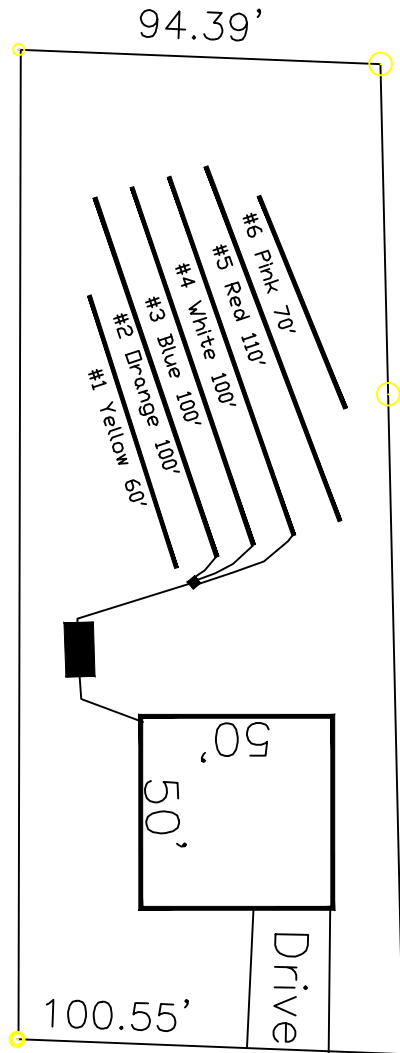

20
25,091 SQ.FT.

This drawing represents a preliminary septic plan made prior to final construction activities. A revised plan may need to be reworked at time of permitting.

*If plumbing is not sufficient a separate pump and tank may be required.

System: Gravity to D-Box
 Lines: 2-4 (300')
 0.3 LTAR
 24" Trench Bottom
 Accepted Status System
 Repair: Serial Dist.
 Lines: 1, 5-6 (240')
 0.3 LTAR
 24 Trench Bottom
 T&J Panel - 50% Reduction

GRAPHIC SCALE
1" = 50'



Adams
Soil Consulting
919-414-6761
Job #561