

HENRY F. BARNES, JR.
 PEGGY BARNES
 D.B.1121, PG.276
 PC# F, SLIDE 480B

- LEGEND**
- NTS NOT TO SCALE
 - EIP EXISTING IRON PIPE
 - PP POWER POLE
 - W/M WATER METER
 - TB TELEPHONE BOX
 - IPS IRON PIPE SET
 - CP&L TRANSFORMER
 - CATV CABLE TV BOX
 - L. POLE LIGHT POLE
 - P OVERHEAD UTILITY LINE
 - F.E.S. FLARED END SECTION (PIPE)
 - RCP REINFORCED CONC. PIPE
 - B.O.C. BACK OF CURB
 - F.H. FIRE HYDRANT
 - C/O SEWER CLEAN OUT
 - EIS EXISTING IRON STAKE
 - M.H. MANHOLE
 - ECM EXISTING CONCRETE MONUMENT
 - GW GUY WIRE

EXISTING 30' PERMANENT
 ACCESS EASEMENT
 REF: M.B.2020, PG.148

GARY HAYNES
 CYNTHIA HAYNES
 D.B.1333, PG.442
 M.B.99, PG.99

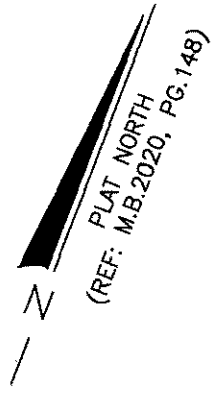

JESSIE L. JONES
 DEBRA A. JONES
 D.B.3564, PG.384
 M.B.99, PG.99

NOTES:
 (A.) THE PROPERTY SHOWN HEREON IS SUBJECT TO ALL EASEMENTS OF RECORD AFFECTING SAME.
 (B.) NO TITLE SEARCH HAS BEEN PERFORMED BY THIS FIRM DURING THE COURSE OF THIS SURVEY.
 (C.) THIS SURVEYOR DOES NOT CERTIFY TO THE EXISTENCE OR NON-EXISTENCE OF ANY UNDERGROUND UTILITIES THAT MAY OR MAY NOT BE PRESENT ON THIS SITE.

EXISTING 30' INGRESS
 & EGRESS EASEMENT
 REF: D.B.1225, PG.638

**NOTE: SHOWN IS LOT 1A OF
 BURKS AND TRUELOVE S/D
 REF: M.B.2020, PG.148**

LOIS J. DAUGHERTY
 D.B.1476, PG.109
 M.B.2000, PG.188

RICHARD RUSSELL
 BETTY RUSSELL
 D.B.88E, PG.218
 M.B.2000, PG.188

AREA = 1.597 ACRES
 2218 CHRISTIAN LIGHT ROAD

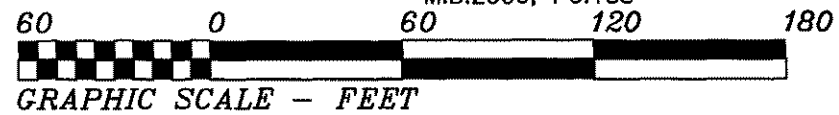

THIS IS TO CERTIFY THAT THIS MAP WAS PREPARED FROM AN ACTUAL SURVEY OF THE PREMISES, MADE UNDER MY SUPERVISION, AND THAT THERE ARE NOT ANY ENCROACHMENTS, EXCEPT AS NOTED TO THE BEST OF MY KNOWLEDGE. THAT THE RATIO OF PRECISION AS CALCULATED BY LATITUDES AND DEPARTURES IS 1:10,000. THIS MAP WAS PREPARED FOR TITLE COMPANY USE AND IS NOT INTENDED FOR RECORDATION OR CONVEYANCES WITHOUT WRITTEN AUTHORIZATION OF THE SURVEYOR AND OTHER APPROPRIATE OFFICIALS.

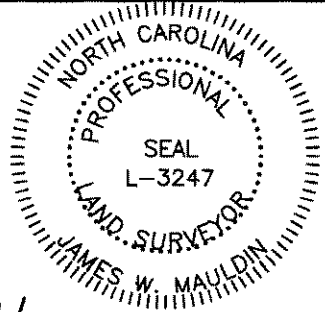

FOUNDATION SURVEY FOR:
TRIANGLE HOME PROS, LLC

HECTOR'S CREEK TWSP., HARNETT CO., N.C.
 SCALE 1" = 60' JUNE 17, 2021

MAULDIN - WATKINS SURVEYING, P.A.
 P.O. BOX 444 / 139 N. MAIN ST.
 FUQUAY VARINA, NORTH CAROLINA 27526
 (919) 552-9326 C-929

PROFESSIONAL LAND SURVEYOR
 L-3247
James W. Mauldin 06/17/21