

SFD 202-0024

**SOIL/SITE EVALUATION
 for ON-SITE WASTEWATER SYSTEM**

Owner: *Willco* Applicant:

Address: *Docs Rd*

Date Evaluated: *2-24-21*

Proposed Facility: *SFD*

Design Flow (.1949): *480 GPD*

Property Size:

Location of Site:

Property Recorded:

Water Supply:

Public Individual Well Spring Other

Evaluation Method: Auger Boring Pit Cut

Type of Wastewater:

Sewage Industrial Process Mixed

P R O F I L E #	.1940 Landscape Position/ Slope %	Horizon Depth (In.)	SOIL MORPHOLOGY .1941		OTHER PROFILE FACTORS				Profile Class & LTAR
			.1941 Structure/ Texture	.1941 Consistence Mineralogy	.1942 Soil Wetness/ Color	.1943 Soil Depth (IN.)	.1956 Sapro Class	.1944 Restr Horiz	
1,2	L	0-2	LS(A) Gr		>48"	>48"	—	—	PS.4
	2-5%	2-14	SL Gr						Group III
		14-48	SL SBlk						
3,4,5	L	0-2	LS(A) Gr		>48"	>48"	—	—	PS.4
	2-5%	2-26	SL Gr						Group III
		26-48	SL SBlk						

Description	Initial System	Repair System	Other Factors (.1946): Site Classification (.1948): <i>PS</i> Evaluated By: <i>W. D. Bohannon R.E.H.</i> Others Present:
Available Space (.1945)	✓	✓	
System Type(s)	<i>258 road</i>	<i>258 road</i>	
Site LTAR	<i>.4</i>	<i>.4</i>	

COMMENTS: _____

LANDSCAPE POSITIONS	GROUP	TEXTURES	.1955 LTAR	CONSISTENCE MOIST	WET
R-RIDGE	I	S-SAND	1.2 - 0.8	VFR-VERY FRIABLE	NS-NON-STICKY
S-SHOULDER SLOPE		LS-LOAMY SAND		FR-FRIABLE	SS-SLIGHTLY STICKY
L-LINEAR SLOPE	II	SL-SANDY LOAM	0.8 - 0.6	FI-FIRM	S-STICKY
FS-FOOT SLOPE		L-LOAM		VFI-VERY FIRM	VS-VERY STICKY
N-NOSE SLOPE	III	SI-SILT	0.6 - 0.3	EFI-EXTREMELY FIRM	NP-NON-PLASTIC
H-HEAD SLOPE		SIL-SILT LOAM			SP-SLIGHTLY STICKY
CC-CONCLAVE SLOPE		CL-CLAY LOAM			P-PLASTIC
CV-CONVEX SLOPE	IV	SIC-SILTY CLAY	0.4 - 0.1		VP-VERY PLASTIC
T-TERRACE		C-CLAY			
FP-FLOOD PLAN		SC-SANDY CLAY			

STRUCTURE
 SG-SINGLE GRAIN
 M-MASSIVE
 CR-CRUMB
 GR-GRANULAR
 SBK-SUBANGULAR BLOCKY
 ABK-ANGULAR BLOCKY
 PL-PLATY
 PR-PRISMATIC

MINERALOGY
 SLIGHTLY EXPANSIVE
 EXPANSIVE

2-24-21
 Clear lot
 locate Trns
 Stake House
 call back

Show profile locations and other site features (dimensions, references or benchmark, and North)

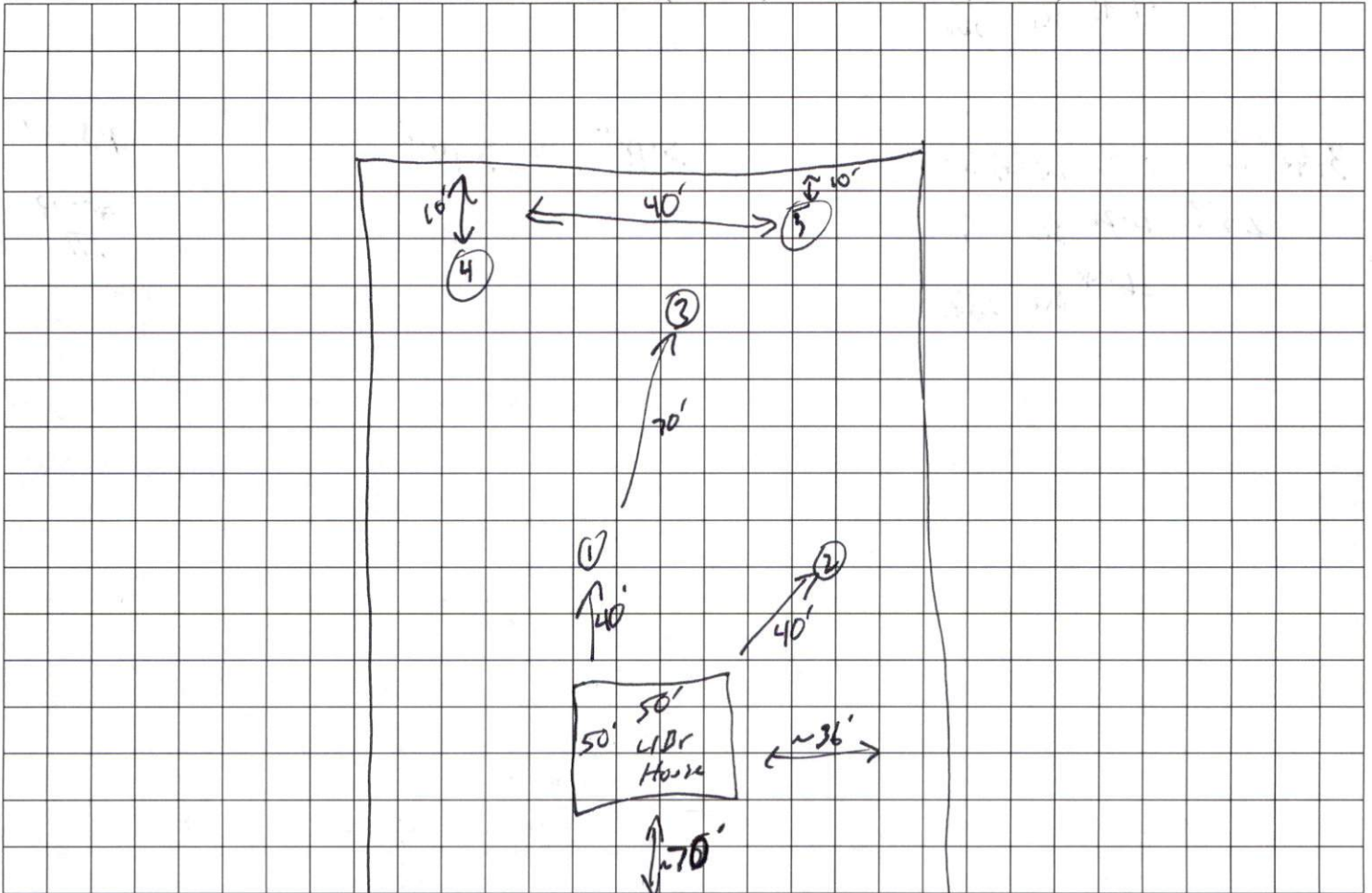

Docs Rd