

Highland Grove 3-Bedroom Septic Proposal Lot #15

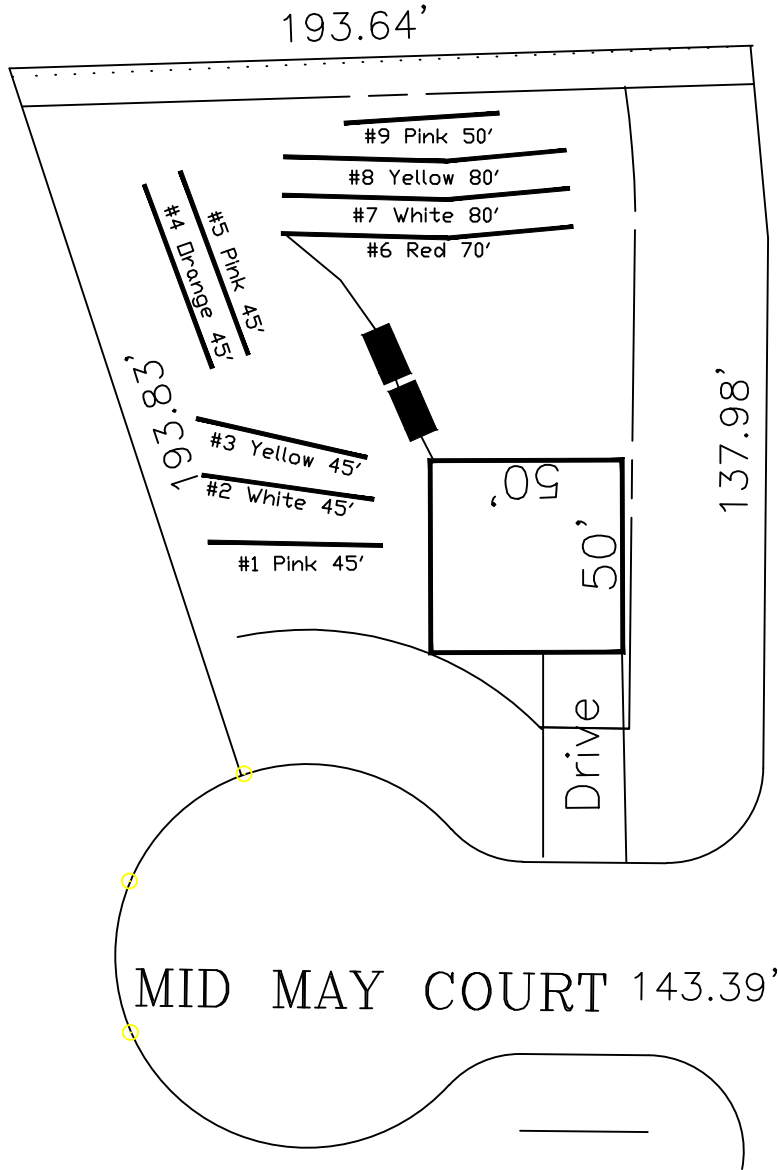

15

34,473 SQ.FT.

Windy Farm Drive

MID MAY COURT 143.39'

System: Pump to Serial Dist
 Lines: 6-9 (280')
 0.35 LTAR
 24" Trench Bottom
 Accepted Status System
 Repair: Serial Dist.
 Lines: 1-5 (225')
 0.4 LTAR
 24" Trench Bottom
 Accepted Status System

This drawing represents a preliminary septic plan made prior to final construction activities. A revised plan may need to be reworked at time of permitting.

GRAPHIC SCALE
1" = 50'



Adams
Soil Consulting
919-414-6761
Job #561