

# Harnett County Department of Public Health

## Improvement Permit

A building permit cannot be issued with only an Improvement Permit

ISSUED TO: CUMBERLAND HOMES PROPERTY LOCATION: 499 JOSEPH ALEXANDER DR. (BALLARD RD.) <sup>521437</sup>  
 SUBDIVISION: BALLARD WOODS LOT # 159  
 NEW  REPAIR  EXPANSION   
 Site Improvements required prior to Construction Authorization Issuance: \_\_\_\_\_  
 Type of Structure: 3-GR 41'x49' STD  
 Proposed Wastewater System Type: 25% REDUCTION  
 Projected Daily Flow: 366 GPD  
 Number of bedrooms: 3 Number of Occupants: 6 max  
 Basement  Yes  No  
 Pump Required  Yes  No  May be required based on final location and elevations of facilities  
 Type of Water Supply:  Community  Public  Well Distance from well NA feet  
 Permit conditions: \_\_\_\_\_ Permit valid for:  Five years  No expiration

Authorized State Agent: [Signature] Date: 04/12/2021 SEE ATTACHED SITE SKETCH  
 The issuance of this permit by the Health Department in no way guarantees the issuance of other permits. The permit holder is responsible for checking with appropriate governing bodies in meeting their requirements. This site is subject to revocation if the site plan, plat, or the intended use changes. The Improvement Permit shall not be affected by a change in ownership of the site. This permit is subject to compliance with the provisions of the Laws and Rules for Sewage Treatment and Disposal and to conditions of this permit.

## Construction Authorization

(Required for Building Permit)

The construction and installation requirements of Rules .1950, .1952, .1954, .1955, .1956, .1957, .1958, and .1959 are incorporated by references into this permit and shall be met. Systems shall be installed in accordance with the attached system layout.

ISSUED TO: CUMBERLAND HOMES PROPERTY LOCATION: 499 JOSEPH ALEXANDER DR. (BALLARD RD.) <sup>521437</sup>  
 SUBDIVISION: BALLARD WOODS LOT # 159  
 Facility Type: 3-GR 41'x49' STD  New  Expansion  Repair  
 Basement?  Yes  No Basement Fixtures?  Yes  No  
 Type of Wastewater System\*\* 25% REDUCTION SYSTEM (Initial) Wastewater Flow: 360 GPD  
 (See note below, if applicable   
50% REDUCTION PROPS (Repair)  
 Installation Requirements/Conditions  
 Septic Tank Size 1000 gallons Number of trenches 3  
 Pump Tank Size 1000 gallons Exact length of each trench 90 feet Trench Spacing: 9 Feet on Center  
 Trenches shall be installed on contour at a Soil Cover: 6 inches [IMPACT]  
 Maximum Trench Depth of: 12 inches (Maximum soil cover shall not exceed 36" above the trench bottom)  
 (Trench bottoms shall be level to +/-1/4" in all directions)  
 Pump Requirements: \_\_\_\_\_ ft. TDH vs. \_\_\_\_\_ GPM Aggregate Depth: NA inches below pipe  
NA inches above pipe  
 Conditions: PUMP TO MEDIUM D-BOX EQUAL DISTRIBUTION NA inches total

**WATER LINES (INCLUDING IRRIGATION) MUST BE 10FT. FROM ANY PART OF SEPTIC SYSTEM OR REPAIR AREA.**  
**NO UTILITIES ALLOWED IN INITIAL OR REPAIR DRAIN FIELD AREA.**

*\*\*If applicable: I understand the system type specified is different from the type specified on the application. I accept the specifications of this permit.*

Owner/Legal Representative Signature: \_\_\_\_\_ Date: \_\_\_\_\_

This Construction Authorization is subject to revocation if the site plan, plat, or the intended use changes. The Construction Authorization shall not be transferred when there is a change in ownership of the site. This Construction Authorization is subject to compliance with the provisions of the Laws and Rules for Sewage Treatment and Disposal and to the conditions of this permit. SEE ATTACHED SITE SKETCH

Authorized State Agent: [Signature] Date: 04/12/2021  
ANDREW CURRAN Construction Authorization Expiration Date: 04/12/2026

Application # SFD2101-0051

## Harnett County Department of Public Health Site Sketch

Property Location: 499 JOSEPH ALEXANDER DR. (BALLARD ROAD - 511437)

Issued To: CUMBERLAND HOMES Subdivision BALLARD WOODS Lot # 159

Authorized State Agent: *Andrew Curran* Date: 04/12/2021  
ANDREW CURRAN

- \* PUMP TO MEDIUM D-BOX EQUAL DISTRIBUTION
- \* 50% REDUCTION PPMPS REPAIR AREA
- \* INSTALL AS HIGH UPHILL AS CONTROL ALLOW [STEPDOWN IN 1ST LINE]
- \* AT-GRADE [12IN] INSTALL  
↳ 6IN IMPACT COVER REQUIRED

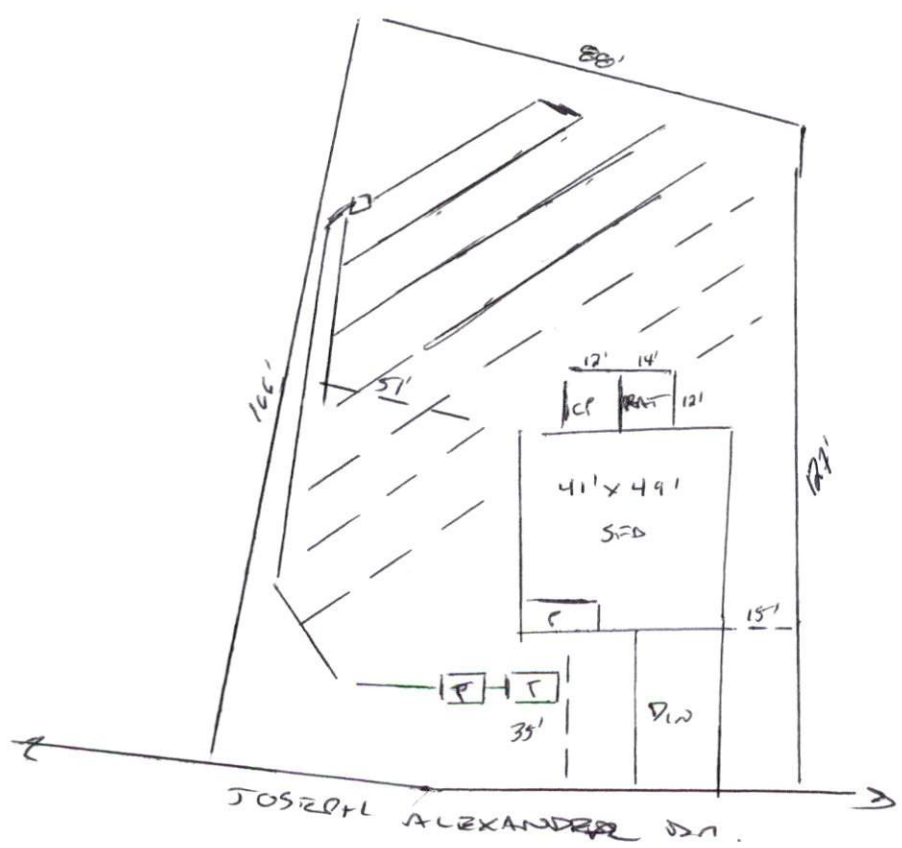

This drawing is for illustrative purposes only. System installation must meet all pertinent laws, rules, and regulations.