

SFD 201-0047

**SOIL/SITE EVALUATION
 for ON-SITE WASTEWATER SYSTEM**

Owner: A. Barrett Applicant: Major Hills Rd (W421)
 Address: 38r SFD Date Evaluated: 2-22-21
 Proposed Facility: 38r SFD Design Flow (.1949): 360 GPD
 Location of Site: Property Recorded:
 Water Supply: Public Individual Well Spring Other
 Evaluation Method: Auger Boring Pit Cut
 Type of Wastewater: Sewage Industrial Process Mixed

Property Size:

P R O F I L E #	.1940 Landscape Position/ Slope %	Horizon Depth (In.)	SOIL MORPHOLOGY .1941		OTHER PROFILE FACTORS				Profile Class & LTAR
			.1941 Structure/ Texture	.1941 Consistence Mineralogy	.1942 Soil Wetness/ Color	.1943 Soil Depth (IN.)	.1956 Sapro Class	.1944 Restr Horiz	
1	L	0-6	LS(A) Gr	Fr/nd/np/nxp	10YR 7/2	>48"	-	-	PS.4
	2-5%	6-22	SL Gr	Fr/nd/np/nxp	⊙ 38"				Group III
		22-48	SCI SDk	Fi/ss/sp/sxp	H ₂ O in hole @ 22" (lateral Groundwater)				
2	L	0-4	LS(A) Gr	Fr/nd/np/nxp	>48"	>48"	-	-	PS.4
	2-5%	4-26	SL Gr	Fr/nd/np/nxp					Group III
		26-48	SCI SDk	Fi/ss/sp/sxp	H ₂ O in hole @ 26" (lateral Groundwater)				
3,4	L	0-6	LS(A) Gr	Fr/nd/np/nxp	>48"	>48"	-	-	PS.5
	2-5%	6-20	SL Gr	Fr/nd/np/nxp					Group III
		20-48	SCI SDk	Fi/ss/sp/sxp					

Description	Initial System	Repair System	Other Factors (.1946): Site Classification (.1948):
Available Space (.1945)	✓	✓	PS
System Type(s)	252 rad	252 rad	Evaluated By: <u>M Osborn REGHS</u>
Site LTAR	.4	.4	Others Present:

COMMENTS: _____

LANDSCAPE POSITIONS	GROUP	TEXTURES	.1955 LTAR	CONSISTENCE MOIST	WET
R-RIDGE	I	S-SAND	1.2 - 0.8	VFR-VERY FRIABLE FR-FRIABLE	NS-NON-STICKY SS-SLIGHTLY STICKY
S-SHOULDER SLOPE		LS-LOAMY SAND			
L-LINEAR SLOPE	II	SL-SANDY LOAM	0.8 - 0.6	FI-FIRM VFI-VERY FIRM EFI-EXTREMELY FIRM	S-STICKY VS-VERY STICKY NP-NON-PLASTIC SP-SLIGHTLY STICKY
FS-FOOT SLOPE		L-LOAM			
N-NOSE SLOPE	III	SI-SILT	0.6 - 0.3		P-PLASTIC VP-VERY PLASTIC
H-HEAD SLOPE		SIL-SILT LOAM			
CC-CONCLAVE SLOPE		CL-CLAY LOAM			
CV-CONVEX SLOPE		SCL-SANDY CLAY LOAM			
T-TERRACE	IV	SIC-SILTY CLAY	0.4 - 0.1		
FP-FLOOD PLAN		C-CLAY SC-SANDY CLAY			

- | | |
|-----------------------|--------------------|
| <u>STRUCTURE</u> | <u>MINERALOGY</u> |
| SG-SINGLE GRAIN | SLIGHTLY EXPANSIVE |
| M-MASSIVE | |
| CR-CRUMB | EXPANSIVE |
| GR-GRANULAR | |
| SBK-SUBANGULAR BLOCKY | |
| ABK-ANGULAR BLOCKY | |
| PL-PLATY | |
| PR-PRISMATIC | |

Show profile locations and other site features (dimensions, references or benchmark, and North)

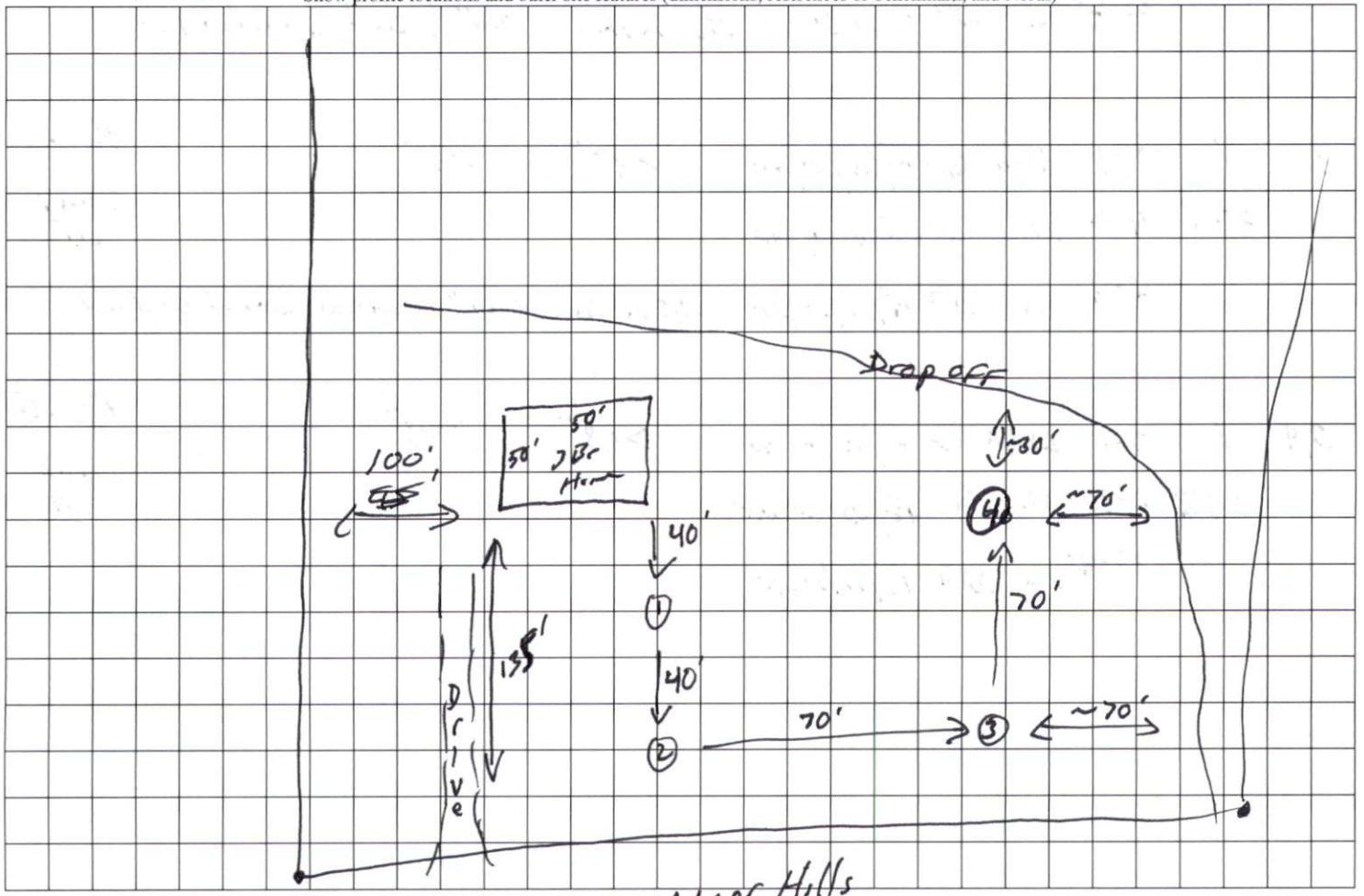

Minor Hills

(3) 75' x 3' Trenches
max Depth 24"