

**GDH Kerto-S LVL 1.750" X 18.000" 2-Ply - PASSED**

Level: Level

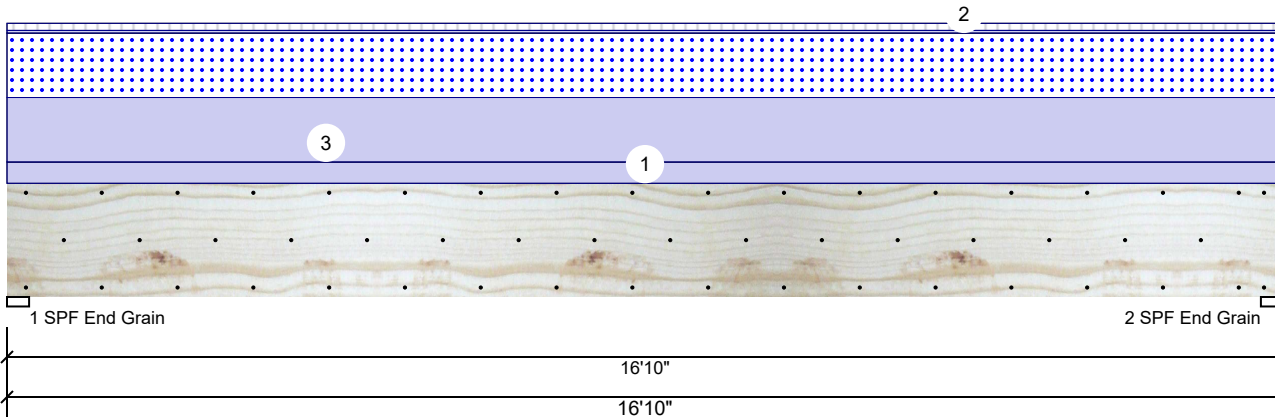

**Member Information**

Type:	Girder	Application:	Floor
Plies:	2	Design Method:	ASD
Moisture Condition:	Dry	Building Code:	IBC/IRC 2015
Deflection LL:	480	Load Sharing:	No
Deflection TL:	360	Deck:	Not Checked
Importance:	Normal	Ceiling:	Gypsum 1/2"
Temperature:	Temp <= 100°F		

**Reactions UNPATTERNED lb (Uplift)**

Brg	Live	Dead	Snow	Wind	Const
1	337	4309	3055	0	0
2	337	4309	3055	0	0

**Bearings**

Bearing	Length	Cap. React	D/L lb	Total	Ld. Case	Ld. Comb.
1 - SPF End Grain	3.500"	69%	4309 / 3055	7365	L	D+S
2 - SPF End Grain	3.500"	69%	4309 / 3055	7365	L	D+S

**Analysis Results**

Analysis	Actual	Location	Allowed	Capacity	Comb.	Case
Moment	29403 ft-lb	8'5"	49428 ft-lb	0.595 (59%)	D+S	L
Unbraced	29403 ft-lb	8'5"	29453 ft-lb	0.998 (100%)	D+S	L
Shear	5861 lb	1'8 5/8"	15456 lb	0.379 (38%)	D+S	L
LL Defl inch	0.196 (L/1005)	8'5 1/16"	0.410 (L/480)	0.480 (48%)	S	L
TL Defl inch	0.472 (L/417)	8'5 1/16"	0.547 (L/360)	0.860 (86%)	D+S	L

**Design Notes**

- 1 Fasten all plies using 3 rows of 10d Box nails (.128x3") at 12" o.c. Maximum end distance not to exceed 6".
- 2 Refer to last page of calculations for fasteners required for specified loads.
- 3 Girders are designed to be supported on the bottom edge only.
- 4 Top loads must be supported equally by all plies.
- 5 Top must be laterally braced at a maximum of 4'4 1/8" o.c.
- 6 Lateral slenderness ratio based on single ply width.

ID	Load Type	Location	Trib Width	Side	Dead 0.9	Live 1	Snow 1.15	Wind 1.6	Const. 1.25	Comments
1	Uniform			Top	120 PLF	0 PLF	0 PLF	0 PLF	0 PLF	Wall
2	Tie-In	0-0-0 to 16-10-0	1-0-0	Top	15 PSF	40 PSF	0 PSF	0 PSF	0 PSF	Floor
3	Uniform			Top	363 PLF	0 PLF	363 PLF	0 PLF	0 PLF	A1
	Self Weight				14 PLF					

**Notes**

Calculated Structured Designs is responsible only of the structural adequacy of this component based on the design criteria and loadings shown. It is the responsibility of the customer and/or the contractor to ensure the component suitability of the intended application, and to verify the dimensions and loads.

**Lumber**

1. Dry service conditions, unless noted otherwise
2. LVL not to be treated with fire retardant or corrosive chemicals

chemicals

**Handling & Installation**

1. LVL beams must not be cut or drilled
2. Refer to manufacturer's product information regarding installation requirements, multi-ply fastening details, beam strength values, and code approvals
3. Damaged Beams must not be used
4. Design assumes top edge is laterally restrained
5. Provide lateral support at bearing points to avoid lateral displacement and rotation

6. For flat roofs provide proper drainage to prevent ponding

This design is valid until 2/26/2023

**Manufacturer Info**

Metsä Wood  
 301 Merritt 7 Building, 2nd Floor  
 Norwalk, CT 06851  
 (800) 622-5850  
 www.metsawood.com/us  
 ICC-ES: ESR-3633

Comtech, Inc.  
 1001 S. Reilly Road, Suite #639  
 Fayetteville, NC  
 USA  
 28314  
 910-864-TRUS



**GDH Kerto-S LVL 1.750" X 18.000" 2-Ply - PASSED**

Level: Level

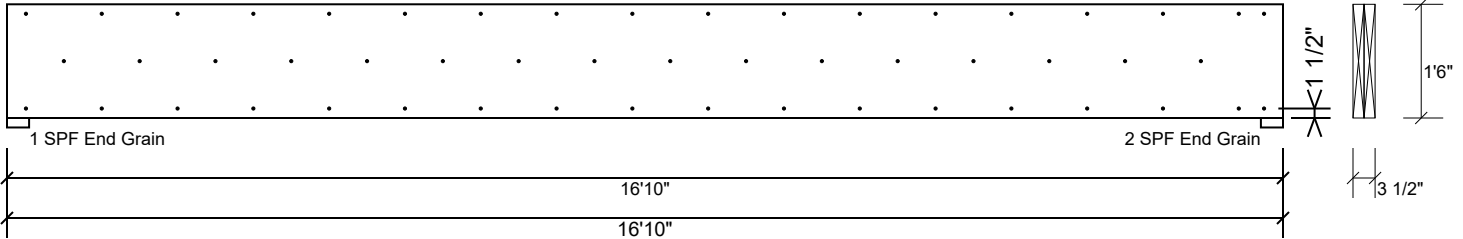

**Multi-Ply Analysis**

Fasten all plies using 3 rows of 10d Box nails (.128x3") at 12" o.c.. Maximum end distance not to exceed 6"

Capacity	0.0 %
Load	0.0 PLF
Yield Limit per Foot	245.6 PLF
Yield Limit per Fastener	81.9 lb.
Yield Mode	IV
Edge Distance	1 1/2"
Min. End Distance	3"
Load Combination	
Duration Factor	1.00

**Notes**

Calculated Structured Designs is responsible only of the structural adequacy of this component based on the design criteria and loadings shown. It is the responsibility of the customer and/or the contractor to ensure the component suitability of the intended application, and to verify the dimensions and loads.

**Lumber**

1. Dry service conditions, unless noted otherwise
2. LVL not to be treated with fire retardant or corrosive

chemicals

**Handling & Installation**

1. LVL beams must not be cut or drilled
2. Refer to manufacturer's product information regarding installation requirements, multi-ply fastening details, beam strength values, and code approvals
3. Damaged Beams must not be used
4. Design assumes top edge is laterally restrained
5. Provide lateral support at bearing points to avoid lateral displacement and rotation

6. For flat roofs provide proper drainage to prevent ponding

This design is valid until 2/26/2023

**Manufacturer Info**

Metsä Wood  
 301 Merritt 7 Building, 2nd Floor  
 Norwalk, CT 06851  
 (800) 622-5850  
 www.metsawood.com/us  
 ICC-ES: ESR-3633

Comtech, Inc.  
 1001 S. Reilly Road, Suite #639  
 Fayetteville, NC  
 USA  
 28314  
 910-864-TRUS



**BM2 Kerto-S LVL 1.750" X 9.250" 2-Ply - PASSED**

Level: Level

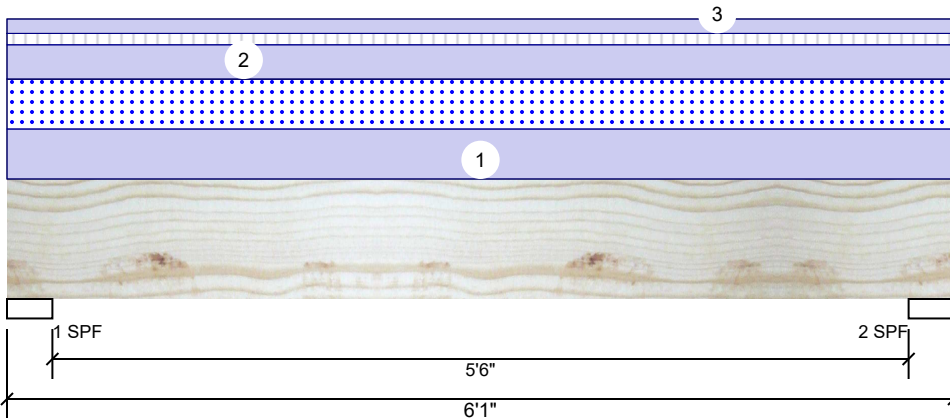

**Member Information**

Type:	Girder	Application:	Floor
Plies:	2	Design Method:	ASD
Moisture Condition:	Dry	Building Code:	IBC/IRC 2015
Deflection LL:	480	Load Sharing:	No
Deflection TL:	240	Deck:	Not Checked
Importance:	Normal		
Temperature:	Temp <= 100°F		

**Reactions UNPATTERNED lb (Uplift)**

Brg	Live	Dead	Snow	Wind	Const
1	289	2519	1265	0	0
2	289	2519	1265	0	0

**Bearings**

Bearing	Length	Cap.	React D/L	Ib	Total	Ld. Case	Ld. Comb.
1 - SPF	3.500"	73%	2519 / 1265	3784	L	D+S	
2 - SPF	3.500"	73%	2519 / 1265	3784	L	D+S	

**Analysis Results**

Analysis	Actual	Location	Allowed	Capacity	Comb.	Case
Moment	4921 ft-lb	3' 1/2"	14423 ft-lb	0.341 (34%)	D+S	L
Unbraced	4921 ft-lb	3' 1/2"	10944 ft-lb	0.450 (45%)	D+S	L
Shear	2540 lb	1'	7943 lb	0.320 (32%)	D+S	L
LL Defl inch	0.026 (L/2581)	3' 1/2"	0.141 (L/480)	0.190 (19%)	S	L
TL Defl inch	0.078 (L/863)	3' 1/2"	0.281 (L/240)	0.280 (28%)	D+S	L

**Design Notes**

- Girders are designed to be supported on the bottom edge only.
- Multiple plies must be fastened together as per manufacturer's details.
- Top loads must be supported equally by all plies.
- Top braced at bearings.
- Bottom braced at bearings.
- Lateral slenderness ratio based on single ply width.

ID	Load Type	Location	Trib Width	Side	Dead 0.9	Live 1	Snow 1.15	Wind 1.6	Const. 1.25	Comments
1	Uniform			Top	416 PLF	0 PLF	416 PLF	0 PLF	0 PLF	A2/A1
2	Uniform			Top	285 PLF	95 PLF	0 PLF	0 PLF	0 PLF	F6
3	Uniform			Top	120 PLF	0 PLF	0 PLF	0 PLF	0 PLF	Wall
	Self Weight				7 PLF					

**Notes**

Calculated Structured Designs is responsible only of the structural adequacy of this component based on the design criteria and loadings shown. It is the responsibility of the customer and/or the contractor to ensure the component suitability of the intended application, and to verify the dimensions and loads.

**Lumber**

- Dry service conditions, unless noted otherwise
- LVL not to be treated with fire retardant or corrosive chemicals

**Handling & Installation**

- LVL beams must not be cut or drilled
- Refer to manufacturer's product information regarding installation requirements, multi-ply fastening details, beam strength values, and code approvals
- Damaged Beams must not be used
- Design assumes top edge is laterally restrained
- Provide lateral support at bearing points to avoid lateral displacement and rotation

6. For flat roofs provide proper drainage to prevent ponding

This design is valid until 2/26/2023

**Manufacturer Info**

Metsä Wood  
 301 Merritt 7 Building, 2nd Floor  
 Norwalk, CT 06851  
 (800) 622-5850  
[www.metsawood.com/us](http://www.metsawood.com/us)  
 ICC-ES: ESR-3633

Comtech, Inc.  
 1001 S. Reilly Road, Suite #639  
 Fayetteville, NC  
 USA  
 28314  
 910-864-TRUS



**BM2x Kerto-S LVL 1.750" X 9.250" 2-Ply - PASSED**

Level: Level

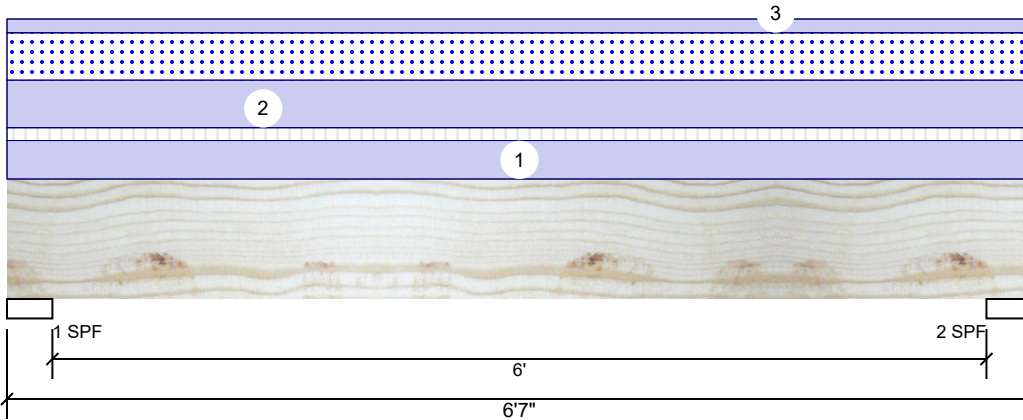

**Member Information**

Type:	Girder
Plies:	2
Moisture Condition:	Dry
Deflection LL:	480
Deflection TL:	240
Importance:	Normal
Temperature:	Temp <= 100°F

Application:	Floor
Design Method:	ASD
Building Code:	IBC/IRC 2015
Load Sharing:	No
Deck:	Not Checked

**Reactions UNPATTERNED Ib (Uplift)**

Brg	Live	Dead	Snow	Wind	Const
1	372	2897	1369	0	0
2	372	2897	1369	0	0

**Bearings**

Bearing	Length	Cap. React	D/L Ib	Total	Ld. Case	Ld. Comb.
1 - SPF	3.500"	82%	2897 / 1369	4267	L	D+S
2 - SPF	3.500"	82%	2897 / 1369	4267	L	D+S

**Analysis Results**

Analysis	Actual	Location	Allowed	Capacity	Comb.	Case
Moment	6078 ft-lb	3' 3/2"	14423 ft-lb	0.421 (42%)	D+S	L
Unbraced	6078 ft-lb	3' 3/2"	10451 ft-lb	0.582 (58%)	D+S	L
Shear	2970 lb	1'	7943 lb	0.374 (37%)	D+S	L
LL Defl inch	0.035 (L/2072)	3' 3/2"	0.153 (L/480)	0.230 (23%)	S	L
TL Defl inch	0.111 (L/665)	3' 3/2"	0.306 (L/240)	0.360 (36%)	D+S	L

**Design Notes**

- Girders are designed to be supported on the bottom edge only.
- Multiple plies must be fastened together as per manufacturer's details.
- Top loads must be supported equally by all plies.
- Top braced at bearings.
- Bottom braced at bearings.
- Lateral slenderness ratio based on single ply width.

ID	Load Type	Location	Trib Width	Side	Dead 0.9	Live 1	Snow 1.15	Wind 1.6	Const. 1.25	Comments
1	Uniform			Top	337 PLF	113 PLF	0 PLF	0 PLF	0 PLF	F5
2	Uniform			Top	416 PLF	0 PLF	416 PLF	0 PLF	0 PLF	A2
3	Uniform			Top	120 PLF	0 PLF	0 PLF	0 PLF	0 PLF	Wall
	Self Weight				7 PLF					

**Notes**  
 Calculated Structured Designs is responsible only of the structural adequacy of this component based on the design criteria and loadings shown. It is the responsibility of the customer and/or the contractor to ensure the component suitability of the intended application, and to verify the dimensions and loads.

**Lumber**  
 1. Dry service conditions, unless noted otherwise  
 2. LVL not to be treated with fire retardant or corrosive chemicals

**Handling & Installation**  
 1. LVL beams must not be cut or drilled  
 2. Refer to manufacturer's product information regarding installation requirements, multi-ply fastening details, beam strength values, and code approvals  
 3. Damaged Beams must not be used  
 4. Design assumes top edge is laterally restrained  
 5. Provide lateral support at bearing points to avoid lateral displacement and rotation

6. For flat roofs provide proper drainage to prevent ponding

This design is valid until 2/26/2023

**Manufacturer Info**  
 Metsä Wood  
 301 Merritt 7 Building, 2nd Floor  
 Norwalk, CT 06851  
 (800) 622-5850  
 www.metsawood.com/us  
 ICC-ES: ESR-3633

Comtech, Inc.  
 1001 S. Reilly Road, Suite #639  
 Fayetteville, NC  
 USA  
 28314  
 910-864-TRUS

**BM3 SP #2 2.000" X 12.000" 2-Ply - PASSED**

Level: Level

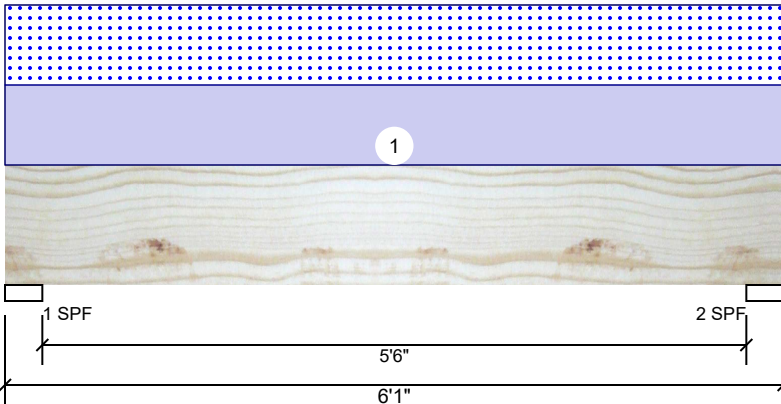

**Member Information**

Type:	Girder
Plies:	2
Moisture Condition:	Dry
Deflection LL:	480
Deflection TL:	240
Importance:	Normal
Temperature:	Temp <= 100°F

Application:	Floor
Design Method:	ASD
Building Code:	IBC/IRC 2015
Load Sharing:	No
Deck:	Not Checked

**Reactions UNPATTERNED lb (Uplift)**

Brg	Live	Dead	Snow	Wind	Const
1	0	1265	1265	0	0
2	0	1265	1265	0	0

**Bearings**

Bearing	Length	Cap. React	D/L lb	Total	Ld. Case	Ld. Comb.
1 - SPF	3.500"	57%	1265 / 1265	2531	L	D+S
2 - SPF	3.500"	57%	1265 / 1265	2531	L	D+S

**Analysis Results**

Analysis	Actual	Location	Allowed	Capacity	Comb.	Case
Moment	3291 ft-lb	3' 1/2"	4548 ft-lb	0.723 (72%)	D+S	L
Unbraced	3291 ft-lb	3' 1/2"	4171 ft-lb	0.789 (79%)	D+S	L
Shear	1560 lb	1'2"	4528 lb	0.345 (34%)	D+S	L
LL Defl inch	0.019 (L/3590)	3' 1/2"	0.141 (L/480)	0.130 (13%)	S	L
TL Defl inch	0.038 (L/1795)	3' 1/2"	0.281 (L/240)	0.130 (13%)	D+S	L

**Design Notes**

- Girders are designed to be supported on the bottom edge only.
- Multiple plies must be fastened together as per manufacturer's details.
- Top loads must be supported equally by all plies.
- Top braced at bearings.
- Bottom braced at bearings.
- Lateral slenderness ratio based on single ply width.

ID	Load Type	Location	Trib Width	Side	Dead 0.9	Live 1	Snow 1.15	Wind 1.6	Const. 1.25	Comments
1	Uniform			Top	416 PLF	0 PLF	416 PLF	0 PLF	0 PLF	

**Manufacturer Info**

Comtech, Inc.  
 1001 S. Reilly Road, Suite #639  
 Fayetteville, NC  
 USA  
 28314  
 910-864-TRUS



This design is valid until 2/26/2023