



ROOF & FLOOR TRUSSES & BEAMS

Reilly Road Industrial Park
Fayetteville, N.C. 28309
Phone: (910) 864-8787
Fax: (910) 864-4444

Bearing reactions less than or equal to 3000# are deemed to comply with the prescriptive Code requirements. The contractor shall refer to the attached Tables (derived from the prescriptive Code requirements) to determine the minimum foundation size and number of wood studs required to support reactions greater than 3000# but not greater than 15000#. A registered design professional shall be retained to design the support system for any reaction that exceeds those specified in the attached Tables. A registered design professional shall be retained to design the support system for all reactions that exceed 15000#.

Signature David Landry
David Landry

LOAD CHART FOR JACK STUDS
(BASED ON TABLES ROEHLIC 6/13)

NUMBER OF JACK STUDS REQUIRED @ EA END OF HEADERS/GIRDERS		
END REACTION (IP-TON)	REQ'D STUDS FOR 10' HEADERS	REQ'D STUDS FOR 12' HEADERS
1700	1	2550
3400	2	5100
5100	3	7650
6800	4	10200
8500	5	12750
10200	6	15300
11900	7	
13600	8	
15300	9	

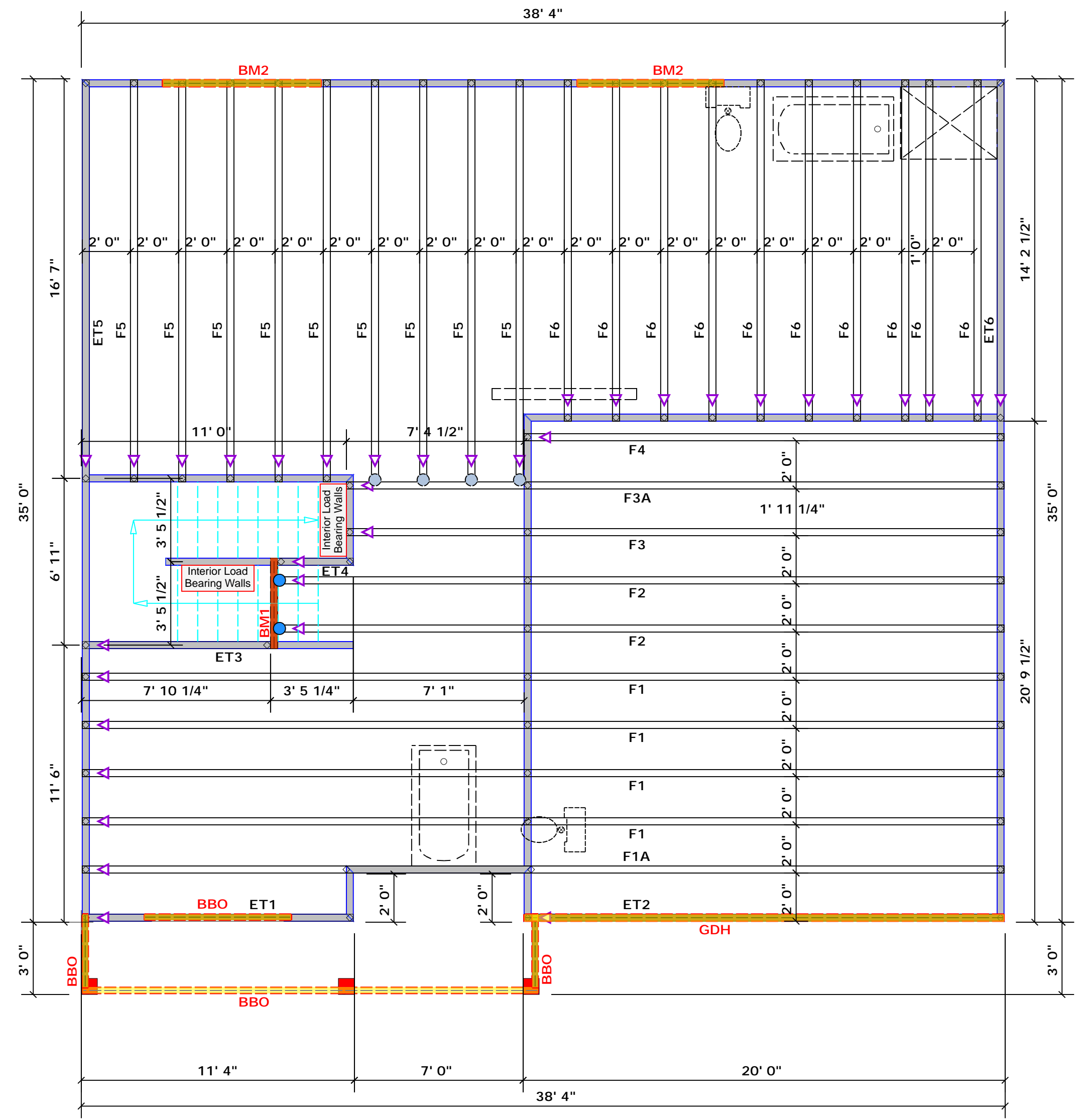

Products				
PlotID	Length	Product	Plies	Net Qty
BM1	4' 0"	1-3/4"x 16" LVL Kerto-S	2	2
BM2	7' 0"	1-3/4"x 9-1/4" LVL Kerto-S	2	4
GDH	20' 0"	1-3/4"x 18" LVL Kerto-S	2	2

1 Truss Placement Plan
Scale: 1/4"=1'
All Walls Shown Are Considered Load Bearing

Dimension Notes
1. All exterior wall to wall dimensions are to face of sheathing unless noted otherwise
2. All interior wall dimensions are to face of frame wall unless noted otherwise
3. All exterior wall to truss dimensions are to face of frame wall unless noted otherwise

Connector Information					Nail Information	
Sym	Product	Manuf	Qty	Supported Member	Header	Truss
●	MSH422	USP	4	Varies	10d/3"	10d/3"
●	HUS410	USP	2	NA	16d/3-1/2"	16d/3-1/2"

Plumbing Drop Notes
1. Plumbing drop locations shown are NOT exact.
2. Contractor to verify ALL plumbing drop locations prior to setting Floor Trusses.
3. Adjust spacing as needed not to exceed 24"oc.

BUILDER	Benjamin Stout	CITY / CO.	Spring Lake / Cumberland
JOB NAME	Lot 6 Sierra Villas	ADDRESS	113 North Dakota Ct.
PLAN	Cypress	MODEL	Roof
SEAL DATE	N/A	DATE REV.	01/07/21
QUOTE #	Quote #	DRAWN BY	David Landry
JOB #	J0121-0107	SALES REP.	Marshall Naylor

▲ = Indicates Left End of Truss
(Reference Engineered Truss Drawing)
Do NOT Erect Truss Backwards

THIS IS A TRUSS PLACEMENT DIAGRAM ONLY. These trusses are designed as individual building components to be incorporated into the building design at the specification of the building designer. See individual design sheets for each truss design identified on the placement drawing. The building designer is responsible for temporary and permanent bracing of the roof and floor system and for the overall structure. The design of the truss support structure including headers, beams, walls, and columns is the responsibility of the building designer. For general guidance regarding bracing, consult BCSI-B1 and BCSI-B3 provided with the truss delivery package or online @ sbcindustry.com.