



ECS Southeast, LLP

6151 Raeford Road, Suite A
Fayetteville, NC 28304
9104013288
9103230539

LETTER OF TRANSMITTAL

May 26, 2021
Ben Stout Construction
PO Box 53798
Fayetteville, NC 28305
ATTN: Robert Ivey

RE: **Lot 6 Sierra Village**
ECS Job # **33:5532-D**

Permits:
Location: **113 N Dakota Ct**
Spring Lake, NC 28390

Field Reports For your use As requested

CC: Ben Stout Construction - Ben Stout

ENCL: Field Report # 1 5/26/2021

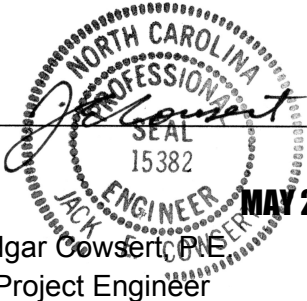

Jack Edgar Cowser, P.E.
Senior Project Engineer

Ryan H. Parrish
Construction Materials Project Manager

Disclaimer

1. This report (and any attachments) shall not be reproduced except in full without prior written approval of ECS.
2. The information in this report relates only to the activities performed on the report date.
3. Where appropriate, this report includes statements as to compliance with applicable project drawings, and specifications for the activities, performed on this report date.
4. Incomplete or non-conforming work will be reported for future resolution.
5. The results of samples and/or specimens obtained or prepared for subsequent laboratory testing will be presented in separate reports/documents.



ECS Southeast, LLP
 6151 Raeford Road, Suite A
 Fayetteville, NC 28304
 (910) 401-3288 [Phone]
 (910) 323-0539 [Fax]

FIELD REPORT

Project **Lot 6 Sierra Village**
 Location **Spring Lake, NC**
 Client **Ben Stout Construction**
 Contractor **Ben Stout Construction**

Project No. **33:5532-D**
 Report No. **1**
 Day & Date **Wednesday 5/26/2021**
 Weather **88 °/ Sunny**
 On-Site Time **1.50**
 Lab Time **0.00**
 Travel Time* **0.00**
 Total **1.50**
 Re Obs Time **0.00**

Remarks

Trip Charges*	Tolls/Parking*	Mileage*	Time of Arrival	Departure
Chargeable Items			10:30A	12:00P

* Travel time and mileage will be billed in accordance with the contract.

Summary of Services Performed (field test data, locations, elevations & depths are estimates) & Individuals Contacted.

An ECS representative arrived on site, as requested, to check the stability of soils via hand auger/DCP method for stem wall backfill.

Please see the attached sketch for location details.

A hand auger was used to advance the boreholes to different depths noted on the boring logs. Dynamic Cone Penetrometer (DCP) test were performed in the hand auger boreholes by a 1.5 inch diameter cone driven into the soil by a 15 pound ring weight with a free fall of 20 inches. The number of blows required to drive the cone into the soil a distance of 1.75 inches is termed the DCP Value and is indicated for each test on the hand auger.

A total of 3 hand auger/DCP evaluations were performed to a depth of approximately 3 feet below the current sub grade elevation. Test results indicated that soils, at the areas and elevations tested, should be capable of supporting a foundation designed for a slab on grade foundation.

Contractor was notified of results at the time of testing, prior to departure from site.

ECS will return, as requested, to perform additional services.

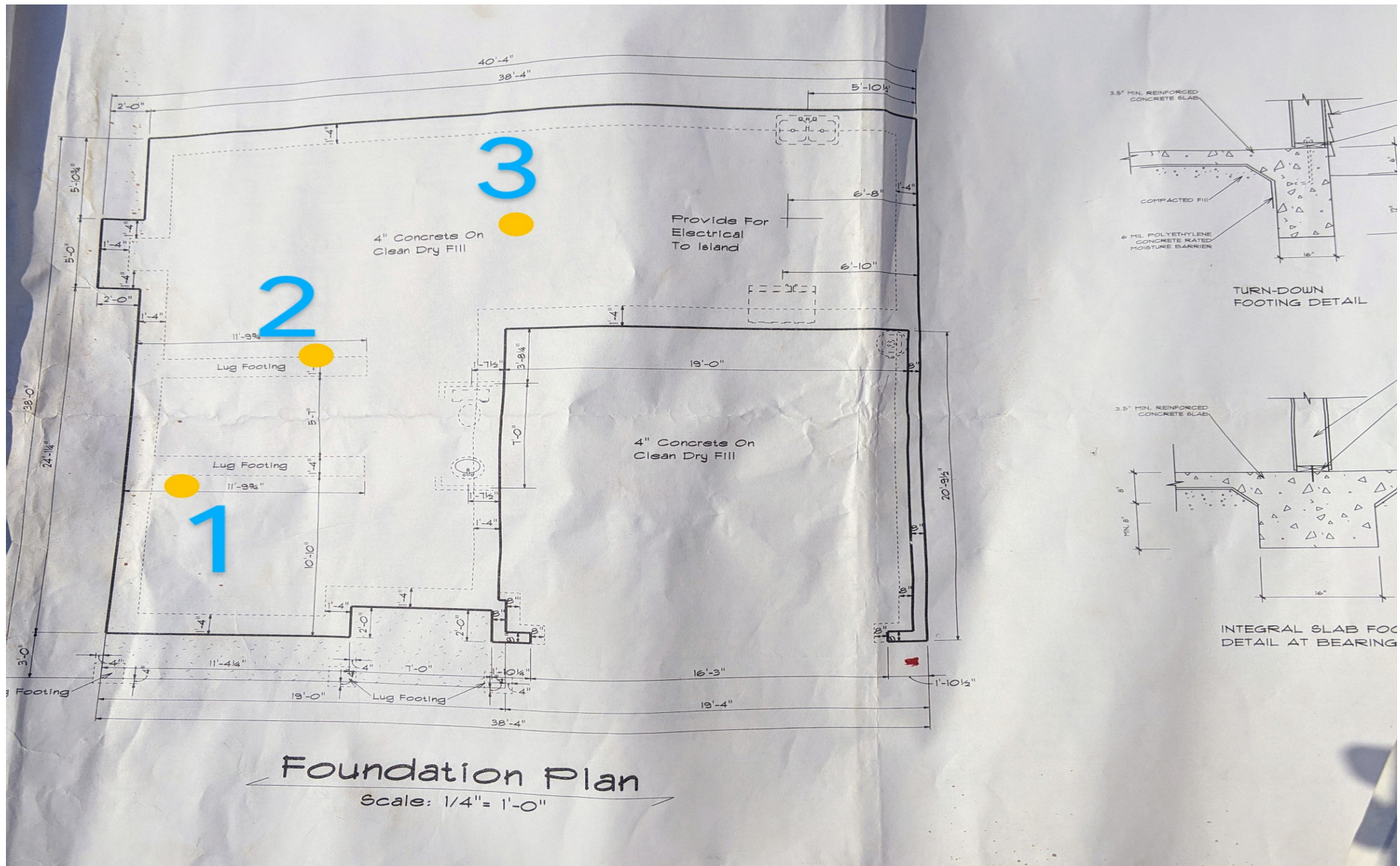

Kyra Mueller
 5/26/2021
 113 N. Dakota Ct
 Proj # 5532-B
 W/O # 61305

Key (NTS)
 DCP TEST-Yellow Dot

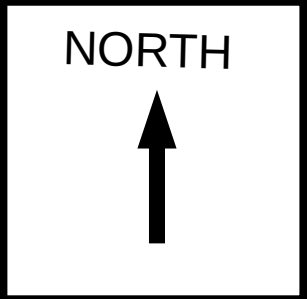



Report of Spread Footing - Foundation Observations

Project: Lot 6 Sierra Village
 Location: 113 N Dakota Ct
Spring Lake - Cumberland - NC - 28390
 Contractor: Ben Stout Construction

Project No.: 33:5532-D
 Day/Date: 5/26/2021

Footing Number	Location	Size (W x H x L)		Footing Bottom Elevation		Description of Steel Placed	Description of Subgrade Material	Required Blow Counts	Design Bearing Pressure
		Design	Actual	Design **	Depth of Undercut (in)			# of Blows / Increment	
1	1	x x	x x	N/A	0		tan sand	6 8,7,8	2000
1	1	x x	x x	N/A	-1		orange clay sand	6 8,7,8	2000
1	1	x x	x x	N/A	-2		orange clay sand	6 9,9,10	2000
1	1	x x	x x	N/A	-3		brown clay sand	6 12,9,10	2000
2	2	x x	x x	N/A	0		tan sand	6 12,14,13	2000
2	2	x x	x x	N/A	-1		orange clay sand	6 12,14,13	2000
2	2	x x	x x	N/A	-2		orange clay sand	6 14,15,14	2000
2	2	x x	x x	N/A	-3		brown clay sand	6 16,18,19	2000
3	3	x x	x x	N/A	0		tan sand	6 8,9,8	2000
3	3	x x	x x	N/A	-1		orange clay sand	6 13,12,13	2000
3	3	x x	x x	N/A	-2		orange clay sand	6 11,11,10	2000



Report of Spread Footing - Foundation Observations

Project: Lot 6 Sierra Village
 Location: 113 N Dakota Ct
Spring Lake - Cumberland - NC - 28390
 Contractor: Ben Stout Construction

Project No.: 33:5532-D
 Day/Date: 5/26/2021

3	3	x x	x x	N/A	-3		orange clay sand	6	2000
								13,14,15	

** SGE: Subgrade Elevation to be determined by surveyor.

By: Kyra Lee Mueller

 ECS Southeast, LLP

WO: 61305