



**ECS Southeast, LLP**

6151 Raeford Road, Suite A  
Fayetteville, NC 28304  
9104013288  
9103230539

**LETTER OF TRANSMITTAL**

April 1, 2021  
Ben Stout Construction  
409 Chicago Dr. Unit 103  
Fayetteville, NC 28306  
ATTN: Ben Stout

RE: **29 N Dakota Ct**  
ECS Job # **33:5532-A**  
  
Permits:  
Location: **29 N Dakota Ct**  
**Spring Lake, NC 28390**

Field Reports       For your use       As requested

CC:

ENCL:    Field Report # 1                    3/31/2021

Jack Edgar Cowsert, P.E.  
Senior Project Engineer

Ryan H. Parrish  
Construction Materials Project Manager

*Disclaimer*

1. This report (and any attachments) shall not be reproduced except in full without prior written approval of ECS.
2. The information in this report relates only to the activities performed on the report date.
3. Where appropriate, this report includes statements as to compliance with applicable project drawings, and specifications for the activities, performed on this report date.
4. Incomplete or non-conforming work will be reported for future resolution.
5. The results of samples and/or specimens obtained or prepared for subsequent laboratory testing will be presented in separate reports/documents.



ECS Southeast, LLP  
6151 Raeford Road, Suite A  
Fayetteville, NC 28304  
(910) 401-3288 [Phone]  
(910) 323-0539 [Fax]

## FIELD REPORT

Project **29 N Dakota Ct**  
Location **Spring Lake, NC**  
Client **Ben Stout Construction**  
Contractor **Ben Stout Construction**

Project No. **33:5532-A**  
Report No. **1**  
Day & Date **Wednesday 3/31/2021**  
Weather **74 °/ Cloudy**  
On-Site Time **1.00**  
Lab Time **0.00**  
Travel Time\* **0.00**  
Total **1.00**  
Re Obs Time **0.00**

### Remarks

Trip Charges*	Tolls/Parking*	Mileage*	Time of Arrival	Departure
Chargeable Items			<b>12:00P</b>	<b>1:00P</b>

\* Travel time and mileage will be billed in accordance with the contract.

**Summary of Services Performed (field test data, locations, elevations & depths are estimates) & Individuals Contacted.**

The undersigned arrived on site, as requested, to observe the stability of soils placed within the foundation stem walls. Please see the attached sketch for details.

Utilizing a Dynamic Cone Penetrometer to check the stability of soil at the aforementioned location. Test results indicated that materials at these locations appeared to be suitable for the support of the design slab on grade.

ECS will return upon request.

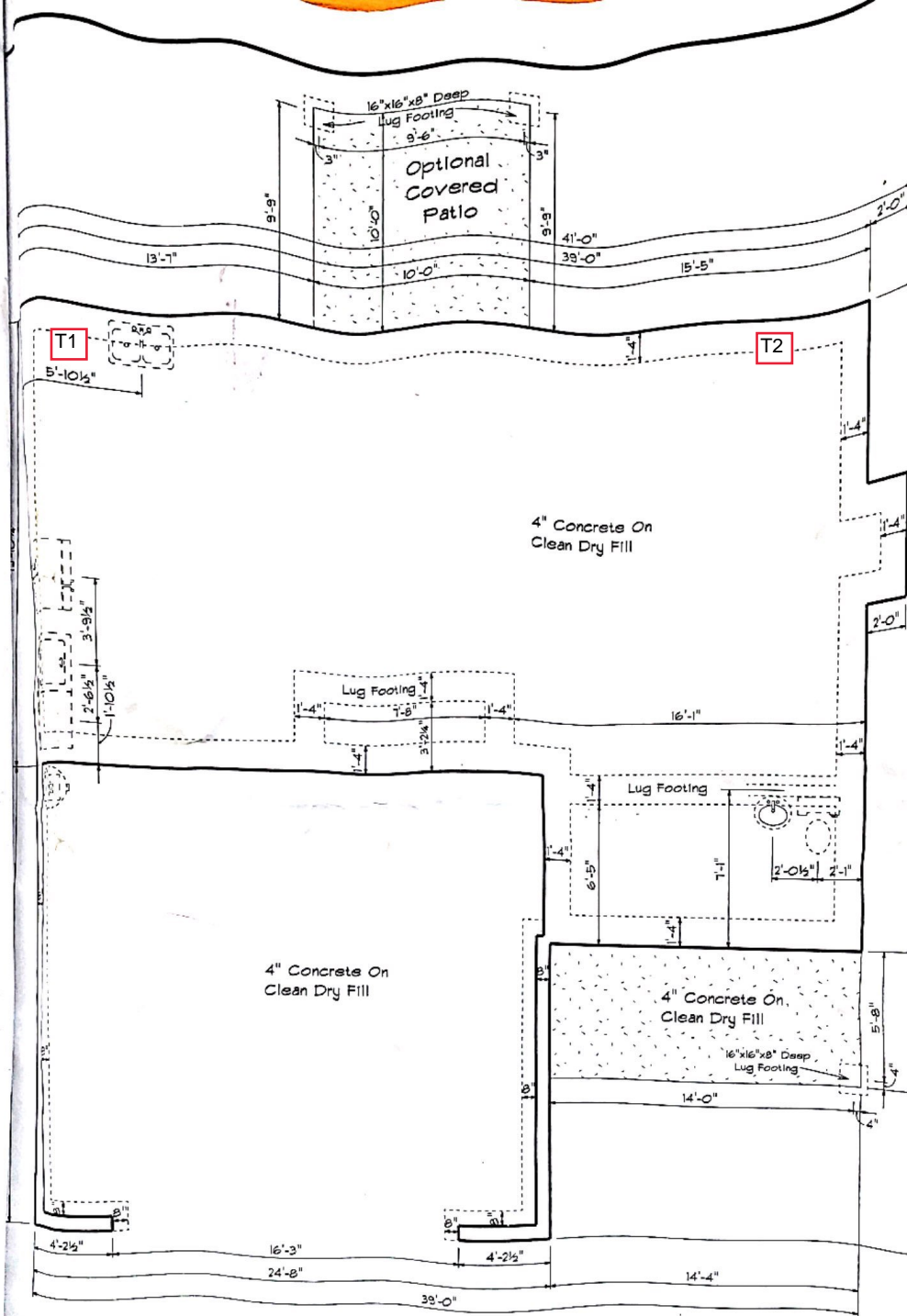

# Foundation Plan



## Report of Spread Footing - Foundation Observations

Project: 29 N Dakota Ct  
 Location: 29 N Dakota Ct  
 Spring Lake - Cumberland - NC - 28390  
 Contractor: Ben Stout Construction

Project No.: 33:5532-A  
 Day/Date: 3/31/2021

Footing Number	Location	Size (W x H x L)		Footing Bottom Elevation		Description of Steel Placed	Description of Subgrade Material	Required Blow Counts	Design Bearing Pressure
		Design	Actual	Design **	Depth of Undercut (in)			# of Blows / Increment	
1	Leftside corner	x x	x x	N/A				6	
								(0:4,5,6)(-1:4,6,6)(-2:3,5,6)(-2.5:HAR)	
1	Rightside corner	x x	x x	N/A				6	
								(0:3,8,6)(-1:5,5,9)(-2:5,5,6)(-3:4,6,5)	

\*\* SGE: Subgrade Elevation to be determined by surveyor.

By: Keton Alexander York

ECS Southeast, LLP

WO: 168967