

Harnett County Department of Public Health Improvement Permit

A building permit cannot be issued with only an Improvement Permit

ISSUED TO: Juan Carlos Morales PROPERTY LOCATION: Carson Gregory Rd. (SR 1547)
 SUBDIVISION Brothers Steel Erectors and Welding LOT # 1
 NEW REPAIR EXPANSION
 Type of Structure: 4-Bedroom 95'x66' SFD Site Improvements required prior to Construction Authorization Issuance:
 Proposed Wastewater System Type: 25% Reduction Sys.
 Projected Daily Flow: 480 GPD
 Number of bedrooms: 4 Number of Occupants: 8 max
 Basement Yes No
 Pump Required: Yes No May be required based on final location and elevations of facilities
 Type of Water Supply: Community Public Well Distance from well NA feet Permit valid for: Five years
 Permit conditions: No expiration

Authorized State Agent:  Date: 01/28/2021 SEE ATTACHED SITE SKETCH
 The issuance of this permit by the Health Department in no way guarantees the issuance of other permits. The permit holder is responsible for checking with appropriate governing bodies in meeting their requirements. This site is subject to revocation if the site plan, plat, or the intended use changes. The Improvement Permit shall not be affected by a change in ownership of the site. This permit is subject to compliance with the provisions of the Laws and Rules for Sewage Treatment and Disposal and to conditions of this permit.

Construction Authorization (Required for Building Permit)

The construction and installation requirements of Rules .1950, .1952, .1954, .1955, .1956, .1957, .1958, and .1959 are incorporated by references into this permit and shall be met. Systems shall be installed in accordance with the attached system layout.

ISSUED TO: Juan Carlos Morales PROPERTY LOCATION: Carson Gregory Rd. (SR 1547)
 SUBDIVISION Brothers Steel Erectors and Welding LOT # 1
 Facility Type: 4-Bedroom 95'x66' SFD New Expansion Repair
 Basement? Yes No Basement Fixtures? Yes No
 Type of Wastewater System** 25% Reduction System (Initial) Wastewater Flow: 480 GPD
 (See note below, if applicable) Pump to 25% Reduction Sys. (Repair)
 Installation Requirements/Conditions
 Septic Tank Size 1250 gallons Number of trenches 3
 Pump Tank Size _____ gallons Exact length of each trench 120 feet Trench Spacing: 9 Feet on Center
 Trenches shall be installed on contour at a Soil Cover: 12 inches
 Maximum Trench Depth of: 24 inches (Maximum soil cover shall not exceed
 (Trench bottoms shall be level to +/-1/4" 36" above the trench bottom)
 in all directions)
 Pump Requirements: _____ ft. TDH vs. _____ GPM Aggregate Depth: NA inches below pipe
 _____ inches above pipe
 Conditions: Gravity to D-Box; Install Deep (24in) to shallow (18in) NA inches total

**WATER LINES (INCLUDING IRRIGATION) MUST BE 10FT. FROM ANY PART OF SEPTIC SYSTEM OR REPAIR AREA.
 NO UTILITIES ALLOWED IN INITIAL OR REPAIR DRAIN FIELD AREA.**

***If applicable: I understand the system type specified is different from the type specified on the application. I accept the specifications of this permit.*

Owner/Legal Representative Signature: _____ Date: _____

This Construction Authorization is subject to revocation if the site plan, plat, or the intended use changes. The Construction Authorization shall not be transferred when there is a change in ownership of the site. This Construction Authorization is subject to compliance with the provisions of the Laws and Rules for Sewage Treatment and Disposal and to the conditions of this permit. SEE ATTACHED SITE SKETCH

Authorized State Agent:  Date: 01/28/2021
 Andrew Wain Construction Authorization Expiration Date: 01/28/2026

Harnett County Department of Public Health Site Sketch

Property Location: Carson Gregory Rd. (SR 1547)

Issued To: Juan Carlos Morales Subdivision Brothers Steel Erectors and Welding Lot # 1

Authorized State Agent: *[Signature]* Date: 01/28/2021

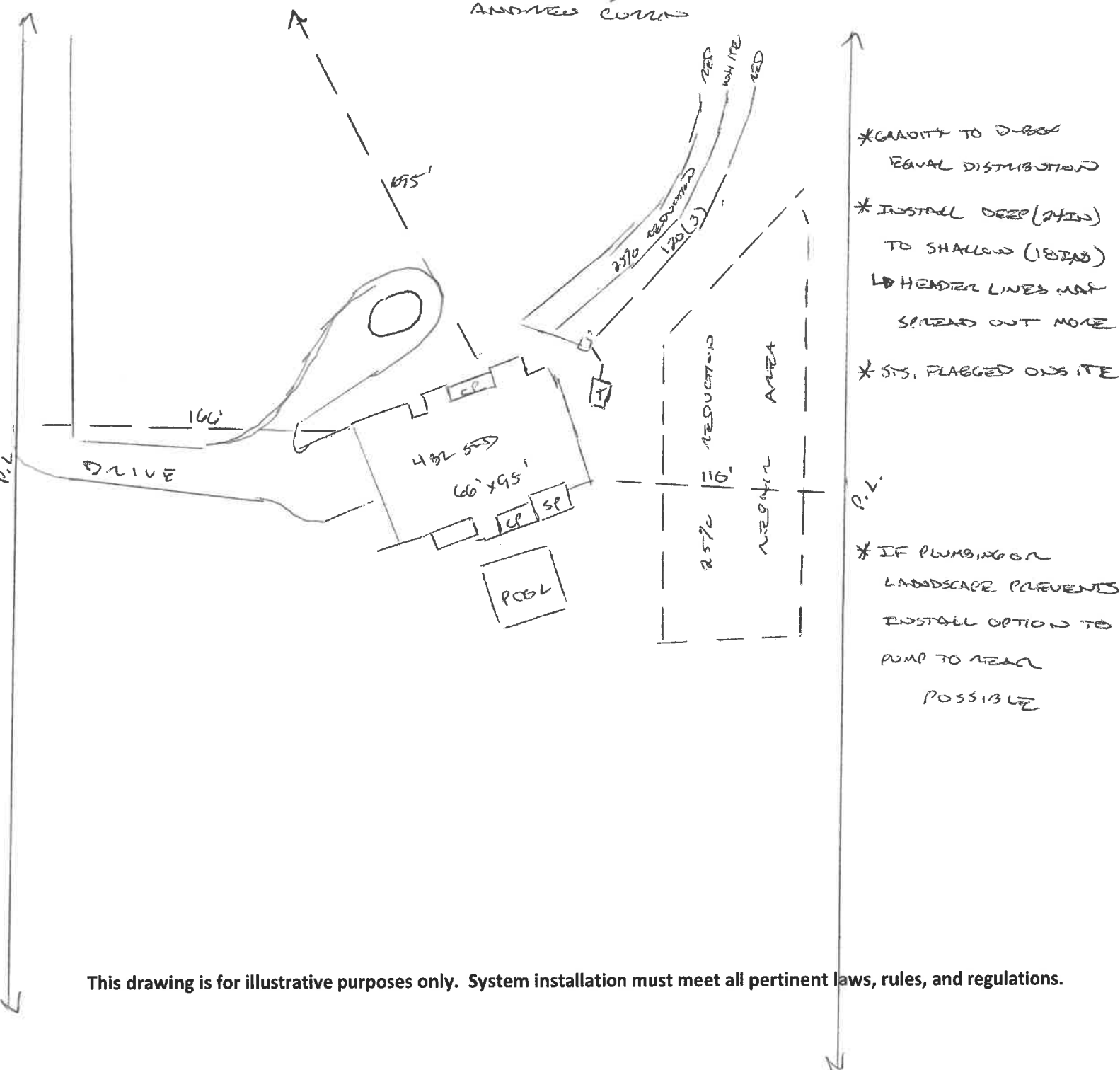

This drawing is for illustrative purposes only. System installation must meet all pertinent laws, rules, and regulations.

Course	Bearing	Distance
L-1	S 29°50'40" E	55.07'
L-2	S 29°41'45" E	54.31'
L-3	S 31°03'23" E	53.82'
L-4	S 31°05'03" E	53.76'
L-5	S 29°01'31" E	63.92'
L-6	S 29°45'30" E	67.75'
L-7	S 30°52'39" E	10.91'
L-8	S 29°50'00" E	45.63'
L-9	S 30°13'45" E	57.71'
L-10	S 30°13'40" E	43.01'

Hernett County
Minimum Building
Setback Requirements
RA-20R, RA-20M, RA-30, RA-40

FRONT: 36' from R/W
SIDE: 10'
CORNER LOT SIDE: 20'

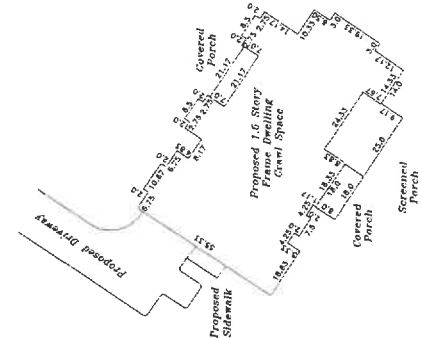

FEMA FLOOD HAZARD STATEMENT
Lots shown on this plat are not
located within the FEMA Flood
Insurance Study Zone shown on
FEMA map No. 3728004000
Effective Date: 10/03/06

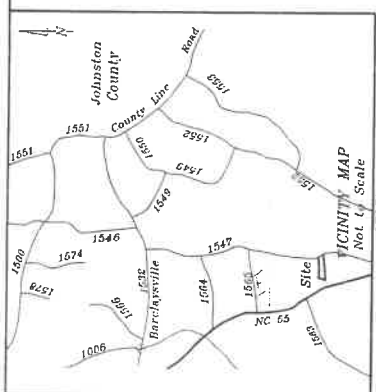

- LEGEND:**
- Lines Surveyed
 - Monuments
 - Water Meter
 - Right-of-Way
 - Centerline
 - Dead End
 - Plat Book
 - Parcel Identifier
 - Number
 - Sq. Ft. square feet
 - Point
 - Light Pole
 - Shed
 - Well
 - Light Pole
 - Shed
- NOTES:**
- Iron stakes set at all property corners unless noted otherwise.
 - All distances/dimensions are horizontal ground distances unless otherwise indicated.

Brothers Steel Erectors and Welding, LLC
Deed Book 3763, Page 651
Map Number 2020-427

Sydney A. Renne
Deed Book 3688, Page 656
Plat Cabinet "F", Slide 3880

Proposed Site Plan
981 Carson Gregory Road

Owned by, Surveyed and Mapped for:

Brothers Steel Erectors and Welding, LLC
5812 Cardinal Lending Drive
Raleigh, NC 27603 919-525-4163

TOWNSHIP: GROVE
COUNTY: HARNETT
STATE: NORTH CAROLINA
ZONE: RA-30
PIN: 0691-64-1365.000

Revisions:
House Location, Shown and location and add post 12-21-20
Address 1-12-2021



References
Deed Book 3763, Page 651 (Brothers)
Plat Cabinet "F", Slide 3880
Map Number 2020-427
All others as shown and/or noted hereon

STANCIL & ASSOCIATES,
Professional Land Surveyor, P.A. C-0831
98 East Depot Street, F. O. Box 730, Angier, N.C. 27501
Phone: 919-639-2133 Fax: 919-639-2022

DATE: 12-12-2020 SURVEYED BY: SDB
FIELD BOOK
LEG1215-CRF
DRAWING FILE NO.
CHECKED & CLOSURE BY: JAY
LIIG-1215.B



Philip F. Falzarano &
Jeanne M. Falzarano
Deed Book 3580, Page 628
Plat Book 2007, Page 451