

# Harnett County Department of Public Health

PERMIT # SFO2101-0014

## Operation Permit

New Installation  Septic Tank  Nitrification Line  Repair  Expansion

PROPERTY LOCATION: 3 CHAMA CT. (CHRISTIAN CT. @ S1412)

Name: (owner) KB HOMES CAROLINAS SUBDIVISION HIGHLANDS CROWE LOT # 35

System Installer: THORNTONS PLUMBING

Basement with plumbing:  Garage  Number of Bedrooms 3

Type of Water Supply:  Community  Public  Well Distance from well NA feet

System Type: 25% REDUCTION S3. III B Types V and VI Systems expire in 5 years.

(In accordance with Table V a) Owner must contact Health Department 6 months prior to expiration for permit renewal.

This system has been installed in compliance with applicable North Carolina General Statutes, Rules for Sewage Treatment and Disposal, and all conditions of the Improvement Permit and Construction Authorization.

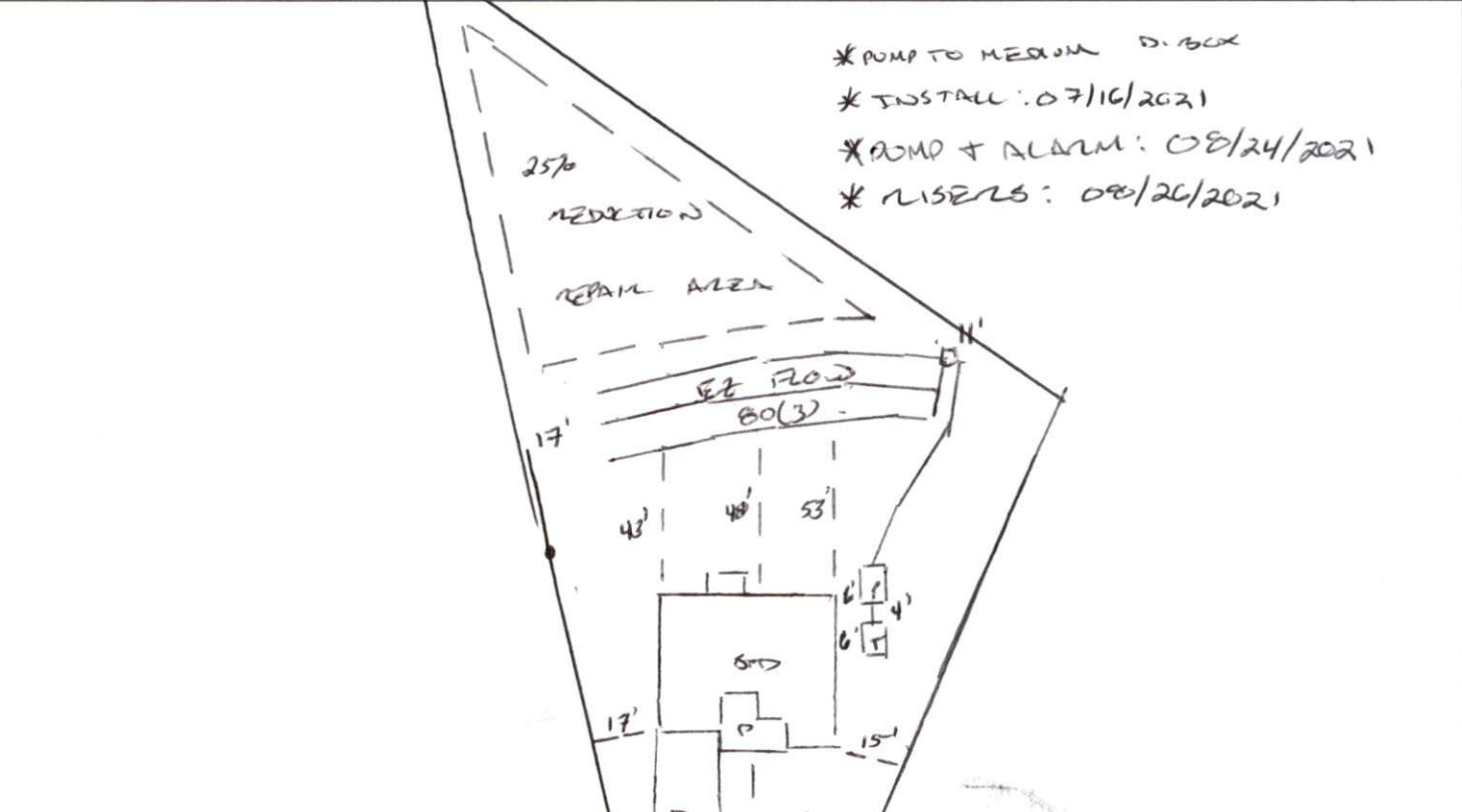

**PERMIT CONDITIONS:**

- I. Performance: System shall perform in accordance with Rule .1961.
- II. Monitoring: As required by Rule .1961.
- III. Maintenance: As required by Rule .1961. Other: \_\_\_\_\_  
Subsurface system operator required? Yes  No  CHAMA CT.  
If yes, see attached sheet for additional operation conditions, maintenance and reporting.
- IV. Operation: \_\_\_\_\_
- V. Other: \_\_\_\_\_

\_\_\_\_\_ D-Box  \_\_\_\_\_ Pump  \_\_\_\_\_ Alarm  \_\_\_\_\_ H2O Line  \_\_\_\_\_ PWR Line

Following are the specifications for the sewage disposal system on the above captioned property.

Type of system:  Conventional  Other SEW FLOW III B Septic Tank: 1000 gallons Pump Tank: 1000 gallons  
Subsurface No. of exact length width of depth of  
Drainage Field ditches 3 of each ditch 80 feet ditches 3 feet ditches 24 inches  
French Drain Required: \_\_\_\_\_ Linear feet

Authorized State Agent [Signature] Date 08/26/2021