

SFD 2101-0012
 HIGHLAND GROVE
 LOT 30

SOIL/SITE EVALUATION
for ON-SITE WASTEWATER SYSTEM

Owner: - Applicant: KB HOMES CONSTRUCTION
 Address: 427 WOODLAND AVE Date Evaluated: 01/29/2021
 Proposed Facility: Design Flow (.1949): 480 GPD Property Size:
 Location of Site: 9825 S Property Recorded:
 Water Supply: Public Individual Well Spring Other
 Evaluation Method: Auger Boring Pit Cut
 Type of Wastewater: Sewage Industrial Process Mixed

P R O F I L E #	.1940 Landscape Position/ Slope %	Horizon Depth (In.)	SOIL MORPHOLOGY .1941		OTHER PROFILE FACTORS				Profile Class & LTAR
			.1941 Structure/ Texture	.1941 Consistence Mineralogy	.1942 Soil Wetness/ Color	.1943 Soil Depth (IN.)	.1956 Sapro Class	.1944 Restr Horiz	
1	L 3-4%	0-24	CL LS	VM NSNP					PS
		24-48	M SLL	FA SSSP	7.5-17.1 @ 44"	48			G.4
2	L 3-4%	0-18	CL LS	VM NSNP					PS
		18-48	CL SLL	FL SSSP	7.5-17.1 @ 44"	48			G.4
3	L 3-4%	0-24	CL LS	VM NSNP					PS
		24-48	M SLL	FA SSSP		48			G.4

Description	Initial System	Repair System	Other Factors (.1946): Site Classification (.1948): PROVISIONAL SOFTWALE Evaluated By: ANDREW CONNOR, RCHS Others Present:
Available Space (.1945)	<input checked="" type="checkbox"/>	<input checked="" type="checkbox"/>	
System Type(s)	2570 MBD	2570 MBD	
Site LTAR	0.4	0.4	

COMMENTS: _____

LANDSCAPE POSITIONS	GROUP	TEXTURES	.1955 LTAR	CONSISTENCE MOIST	WET
R-RIDGE	I	S-SAND	1.2 - 0.8	VFR-VERY FRIABLE	NS-NON-STICKY
S-SHOULDER SLOPE		LS-LOAMY SAND		FR-FRIABLE	SS-SLIGHTLY STICKY
L-LINEAR SLOPE				FI-FIRM	S-STICKY
FS-FOOT SLOPE	II	SL-SANDY LOAM	0.8 - 0.6	VFI-VERY FIRM	VS-VERY STICKY
N-NOSE SLOPE		L-LOAM		EFI-EXTREMELY FIRM	NP-NON-PLASTIC
H-HEAD SLOPE					SP-SLIGHTLY STICKY
CC-CONCLAVE SLOPE	III	SI-SILT	0.6 - 0.3		P-PLASTIC
CV-CONVEX SLOPE		SIL-SILT LOAM			VP-VERY PLASTIC
T-TERRACE		CL-CLAY LOAM			
FP-FLOOD PLAN		SCL-SANDY CLAY LOAM			

STRUCTURE
 SG-SINGLE GRAIN
 M- MASSIVE
 CR-CRUMB
 GR-GRANULAR
 SBK-SUBANGULAR BLOCKY
 ABK-ANGULAR BLOCKY
 PL-PLATY
 PR-PRISMATIC

MINERALOGY
 SLIGHTLY EXPANSIVE
 EXPANSIVE

Show profile locations and other site features (dimensions, references or benchmark, and North)

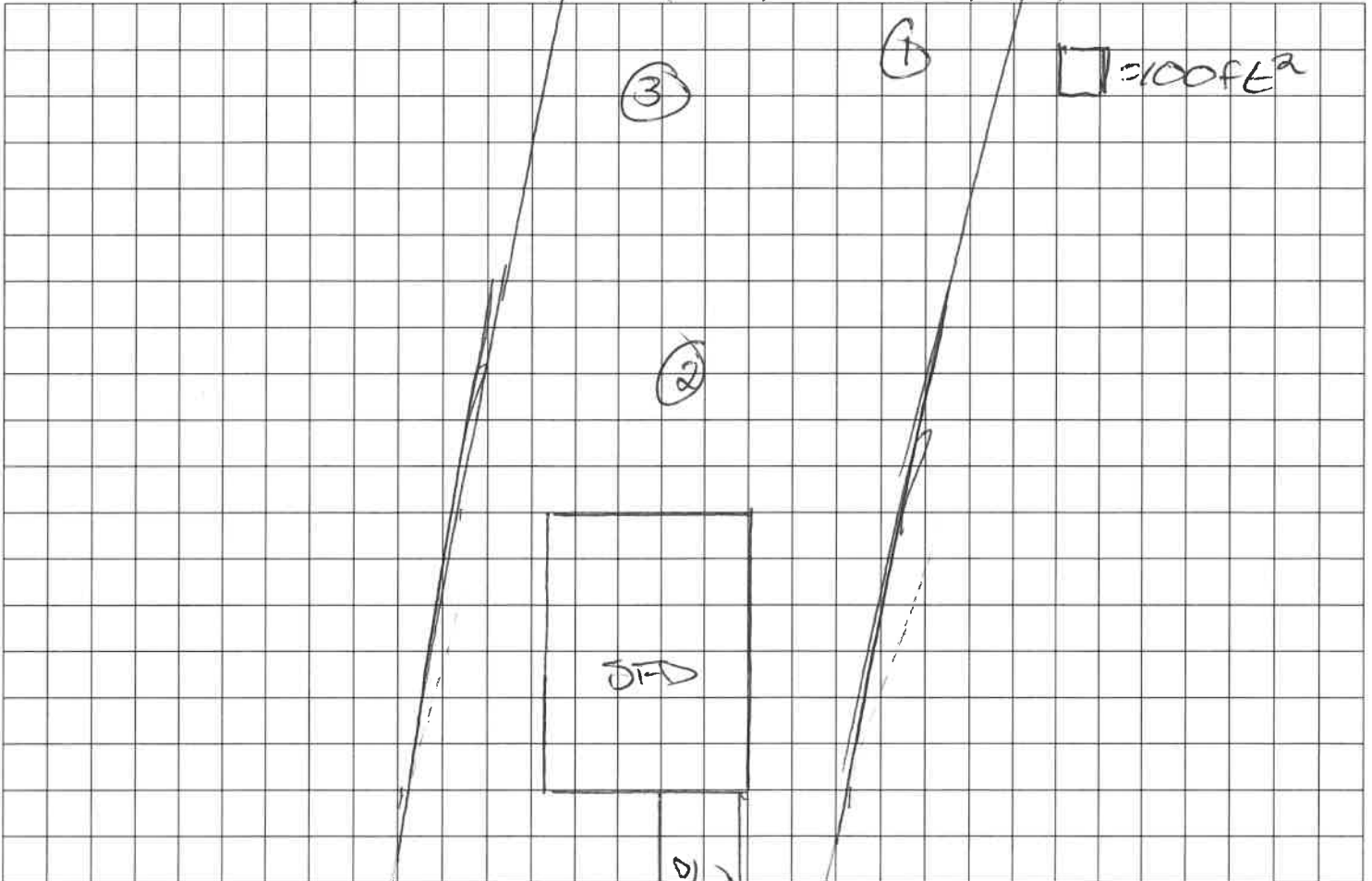

WINDY FARM DR.