

Highland Grove
4-Bedroom Septic Proposal
Lot #29

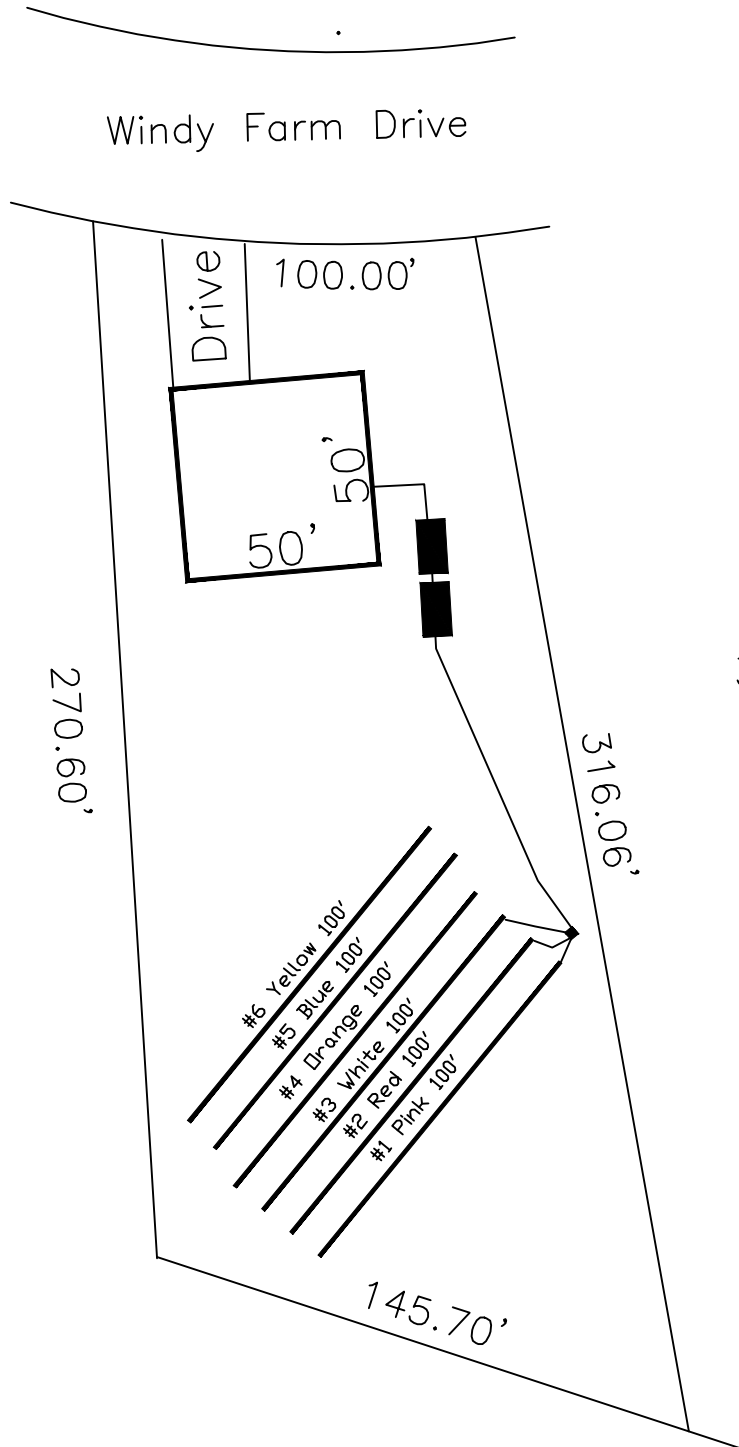

29

33,461 SQ.FT.

System: Pump to D-Box
Lines: 1-3 (300')
0.4 LTAR
24" Trench Bottom
Accepted Status System
Repair: Pump to D-Box
Lines: 4-7 (300')
0.4 LTAR
24" Trench Bottom
Accepted Status System

This drawing represents a preliminary septic plan made prior to final construction activities. A revised plan may need to be reworked at time of permitting.

GRAPHIC SCALE
1" = 50'



Adams
Soil Consulting
919-414-6761
Job #561