



ECS Southeast, LLP

6151 Raeford Road, Suite A
Fayetteville, NC 28304
9104013288
9103230539

LETTER OF TRANSMITTAL

May 3, 2021
Precision Custom Homes

Fayetteville, NC 28301
ATTN: Mr. Allen Peterson

RE: **Summerlin Lot 58**
ECS Job # **33:5464-F**

Permits:
Location: **111 Summerlin Dr**
Sanford, NC 27332

| | | | |
|-------|---|--|--|
| | <input checked="" type="checkbox"/> Field Reports | <input checked="" type="checkbox"/> For your use | <input checked="" type="checkbox"/> As requested |
| CC: | Precision Custom Homes - Brittany Trevino | Precision Custom Homes - Shaun Gardner | |
| ENCL: | Field Report # 1 | 4/30/2021 | |

Jack Edgar Cowsert, P.E.
Senior Project Engineer

Donny Johnson
Field Services Manager

Disclaimer

- 1. This report (and any attachments) shall not be reproduced except in full without prior written approval of ECS.*
- 2. The information in this report relates only to the activities performed on the report date.*
- 3. Where appropriate, this report includes statements as to compliance with applicable project drawings, and specifications for the activities, performed on this report date.*
- 4. Incomplete or non-conforming work will be reported for future resolution.*
- 5. The results of samples and/or specimens obtained or prepared for subsequent laboratory testing will be presented in separate reports/documents.*



ECS Southeast, LLP
 6151 Raeford Road, Suite A
 Fayetteville, NC 28304
 (910) 401-3288 [Phone]
 (910) 323-0539 [Fax]

FIELD REPORT

Project **Summerlin Lot 58**
 Location **Sanford, NC**
 Client **Precision Custom Homes**
 Contractor **Precision Custom Homes**

Project No. **33:5464-F**
 Report No. **1**
 Day & Date **Friday 4/30/2021**
 Weather **73 °/ Sunny**
 On-Site Time **1.75**
 Lab Time **0.00**
 Travel Time* **0.00**
 Total **1.75**
 Re Obs Time **0.00**

Remarks

| | | | | |
|------------------|----------------|----------|-----------------|--------------|
| Trip Charges* | Tolls/Parking* | Mileage* | Time of Arrival | Departure |
| Chargeable Items | | | 7:15A | 9:00A |

* Travel time and mileage will be billed in accordance with the contract.

Summary of Services Performed (field test data, locations, elevations & depths are estimates) & Individuals Contacted.

An ECS representative arrived on site, as requested, to check the bearing capacity of soils via hand auger/DCP for residential stem wall backfill and lug footings.

Please see the attached sketch for location details.

A hand auger was used to advance the boreholes to different depths noted on the boring logs. Dynamic Cone Penetrometer (DCP) test were performed in the hand auger boreholes by a 1.5 inch diameter cone driven into the soil by a 15 pound ring weight with a free fall of 20 inches. The number of blows required to drive the cone into the soil a distance of 1.75 inches is termed the DCP Value and is indicated for each test on the hand auger.

A total of 3 hand auger/DCP evaluations were performed to a depth of approximately 3 feet below the current sub grade elevation. Tests indicate that soils, at the areas and elevations tested, should be capable of supporting a foundation designed for a net allowable bearing capacity of 2000 psf.

The Contractor was notified of results at the time of testing, prior to departure from site.

ECS will return, as requested, to perform additional services.

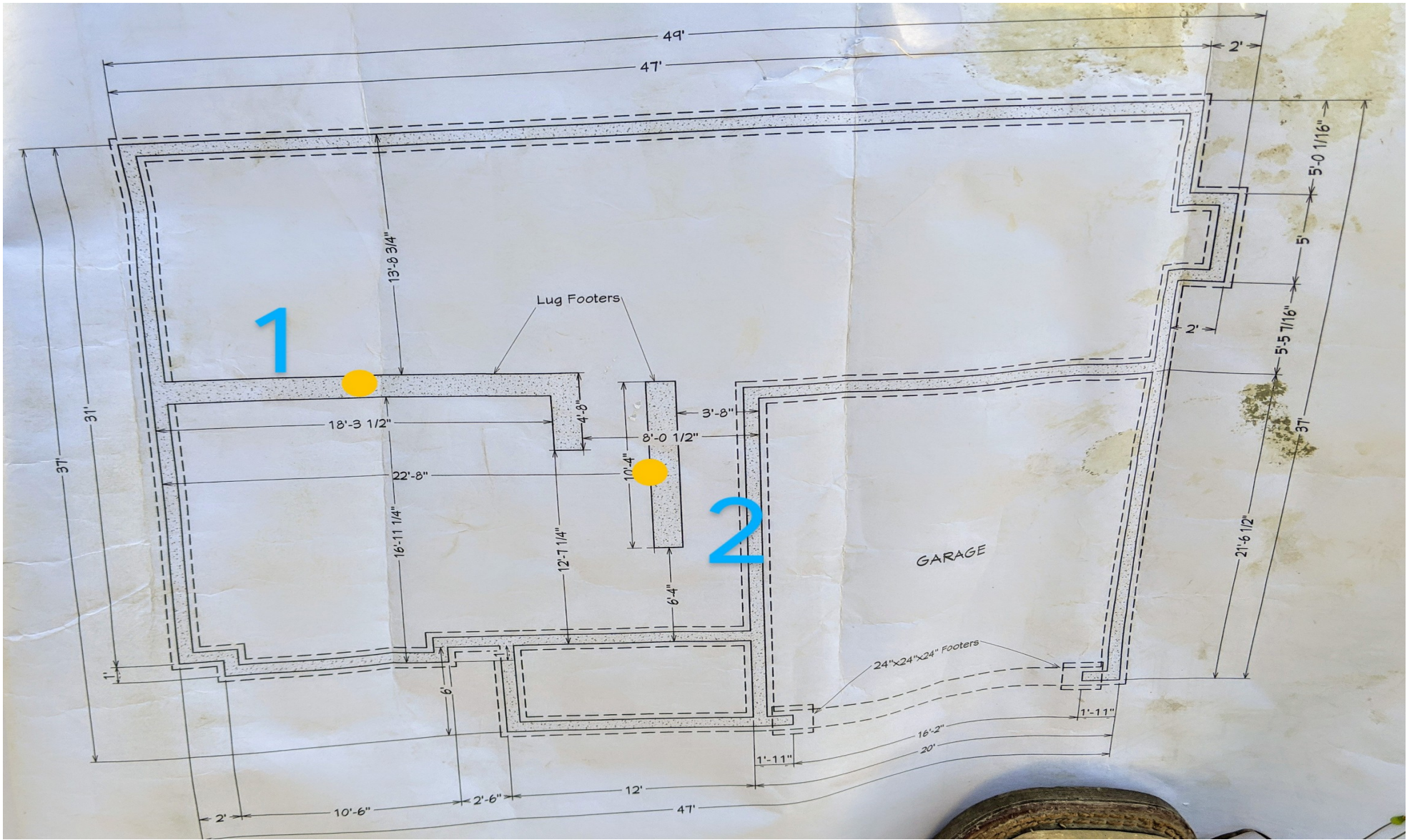

Kyra Mueller
 4/30/2021
 Summerlin Lot
 Proj # 5464-F
 W/O # 60934

Key (NTS)

DCP Test Locations



NORTH





Report of Spread Footing - Foundation Observations

Project: Summerlin Lot 58
 Location: 111 Summerlin Dr
 Sanford - Lee - NC - 27332
 Contractor: Precision Custom Homes

Project No.: 33:5464-F
 Day/Date: 4/30/2021

| Footing Number | Location | Size (W x H x L) | | Footing Bottom Elevation | | Description of Steel Placed | Description of Subgrade Material | Required Blow Counts | Design Bearing Pressure |
|----------------|-------------------|------------------|--------|--------------------------|------------------------|-----------------------------|----------------------------------|------------------------|-------------------------|
| | | Design | Actual | Design ** | Depth of Undercut (in) | | | # of Blows / Increment | |
| 1 | west lug footer | x x | x x | N/A | 0 | | orange clay sand | 6 5,5,5 | 2000 |
| 1 | west lug footer | x x | x x | N/A | -1 | | orange clay sand | 6 12,14,18 | 2000 |
| 1 | west lug footer | x x | x x | N/A | -2 | | brown clay sand | 6 17,19,16 | 2000 |
| 1 | west lug footer | x x | x x | N/A | -3 | | tan clay sand | 6 10,13,14 | 2000 |
| 2 | center lug footer | x x | x x | N/A | 0 | | orange clay sand | 6 7,6,5 | 2000 |
| 2 | center lug footer | x x | x x | N/A | -1 | | orange clay sand | 6 8,7,9 | 2000 |
| 2 | center lug footer | x x | x x | N/A | -2 | | orange clay sand | 6 14,18,20 | 2000 |
| 2 | center lug footer | x x | x x | N/A | -3 | | black clay sand | 6 17,17,20 | 2000 |
| 3 | northeast corner | x x | x x | N/A | 0 | | orange clay sand | 6 8,7,8 | 2000 |
| 3 | northeast corner | x x | x x | N/A | -1 | | orange clay sand | 6 8,7,10 | 2000 |
| 3 | northeast corner | x x | x x | N/A | -2 | | orange clay sand | 6 8,11,13 | 2000 |



Report of Spread Footing - Foundation Observations

Project: Summerlin Lot 58
 Location: 111 Summerlin Dr
 Sanford - Lee - NC - 27332
 Contractor: Precision Custom Homes

Project No.: 33:5464-F
 Day/Date: 4/30/2021

| | | | | | | | | | |
|---|------------------|-----|-----|-----|----|--|------------------|-------------|------|
| 3 | northeast corner | x x | x x | N/A | -3 | | orange clay sand | 6 8,8,10 | 2000 |
|---|------------------|-----|-----|-----|----|--|------------------|-------------|------|

** SGE: Subgrade Elevation to be determined by surveyor.

By: Kyra Lee Mueller

 ECS Southeast, LLP

WO: 60934