

**SOIL/SITE EVALUATION**  
**for ON-SITE WASTEWATER SYSTEM**

Owner: **-** Applicant: **DAN RYAN OLDE**  
 Address: **389 MILL ROAD** Date Evaluated: **12/17/2012**  
 Proposed Facility: **40L S/S** Design Flow (.1949): **400 GPD**  
 Location of Site: **40L S/S** Property Recorded:  
 Water Supply:  Public  Individual  Well  Spring  Other  
 Evaluation Method:  Auger Boring  Pit  Cut  
 Type of Wastewater:  Sewage  Industrial Process  Mixed

P R O F I L E #	.1940 Landscape Position/ Slope %	Horizon Depth (In.)	SOIL MORPHOLOGY .1941		OTHER PROFILE FACTORS				Profile Class & LTAR
			.1941 Structure/ Texture	.1941 Consistence Mineralogy	.1942 Soil Wetness/ Color	.1943 Soil Depth (IN.)	.1956 Sapro Class	.1944 Restr Horiz	
1/2	L 5-6%	0-12	OL LS	VM NSMP					
		12-46	OV SIL	FL SP					PS
		40+	PAVEMENT MAT	-		40			0.3
3	L 5-6%	0-12	OL LS	VM NSMP					
		12-32	OV SIL	FL SP					0/PS
		32+	PAVEMENT MAT.	-		32			0.3

Description	Initial System	Repair System	Other Factors (.1946):
Available Space (.1945)	<input checked="" type="checkbox"/>	<input checked="" type="checkbox"/>	Site Classification (.1948): <b>PROVISIONALLY SUITABLE</b>
System Type(s)	<b>25% RED</b>	<b>25% RED</b>	Evaluated By: <b>ANDREW WANNI, NEHJ</b>
Site LTAR	<b>0.3</b>	<b>0.3</b>	Others Present:

COMMENTS: \_\_\_\_\_

LANDSCAPE POSITIONS	GROUP	TEXTURES	.1955 LTAR	CONSISTENCE MOIST	WET
R-RIDGE	I	S-SAND	1.2 - 0.8	VFR-VERY FRIABLE FR-FRIABLE	NS-NON-STICKY SS-SLIGHTLY STICKY
S-SHOULDER SLOPE		LS-LOAMY SAND			
L-LINEAR SLOPE	II	SL-SANDY LOAM	0.8 - 0.6	FI-FIRM VFI-VERY FIRM	S-STICKY VS-VERY STICKY
FS-FOOT SLOPE		L-LOAM			
N-NOSE SLOPE	III	SI-SILT	0.6 - 0.3	EFI-EXTREMELY FIRM	NP-NON-PLASTIC SP-SLIGHTLY STICKY
H-HEAD SLOPE		SIL-SILT LOAM			
CC-CONCLAVE SLOPE		CL-CLAY LOAM			
CV-CONVEX SLOPE		SCL-SANDY CLAY LOAM			
T-TERRACE	IV	SIC-SILTY CLAY	0.4 - 0.1		P-PLASTIC VP-VERY PLASTIC
FP-FLOOD PLAN		C-CLAY			
		SC-SANDY CLAY			

STRUCTURE  
 SG-SINGLE GRAIN  
 M- MASSIVE  
 CR-CRUMB  
 GR-GRANULAR  
 SBK-SUBANGULAR BLOCKY  
 ABK-ANGULAR BLOCKY  
 PL-PLATY  
 PR-PRISMATIC

MINERALOGY  
 SLIGHTLY EXPANSIVE  
 EXPANSIVE

\* GLENED  
 \* NO HOUSE BOX  
 \* REFLAGG P.L.

Show profile locations and other site features (dimensions, references or benchmark, and North)

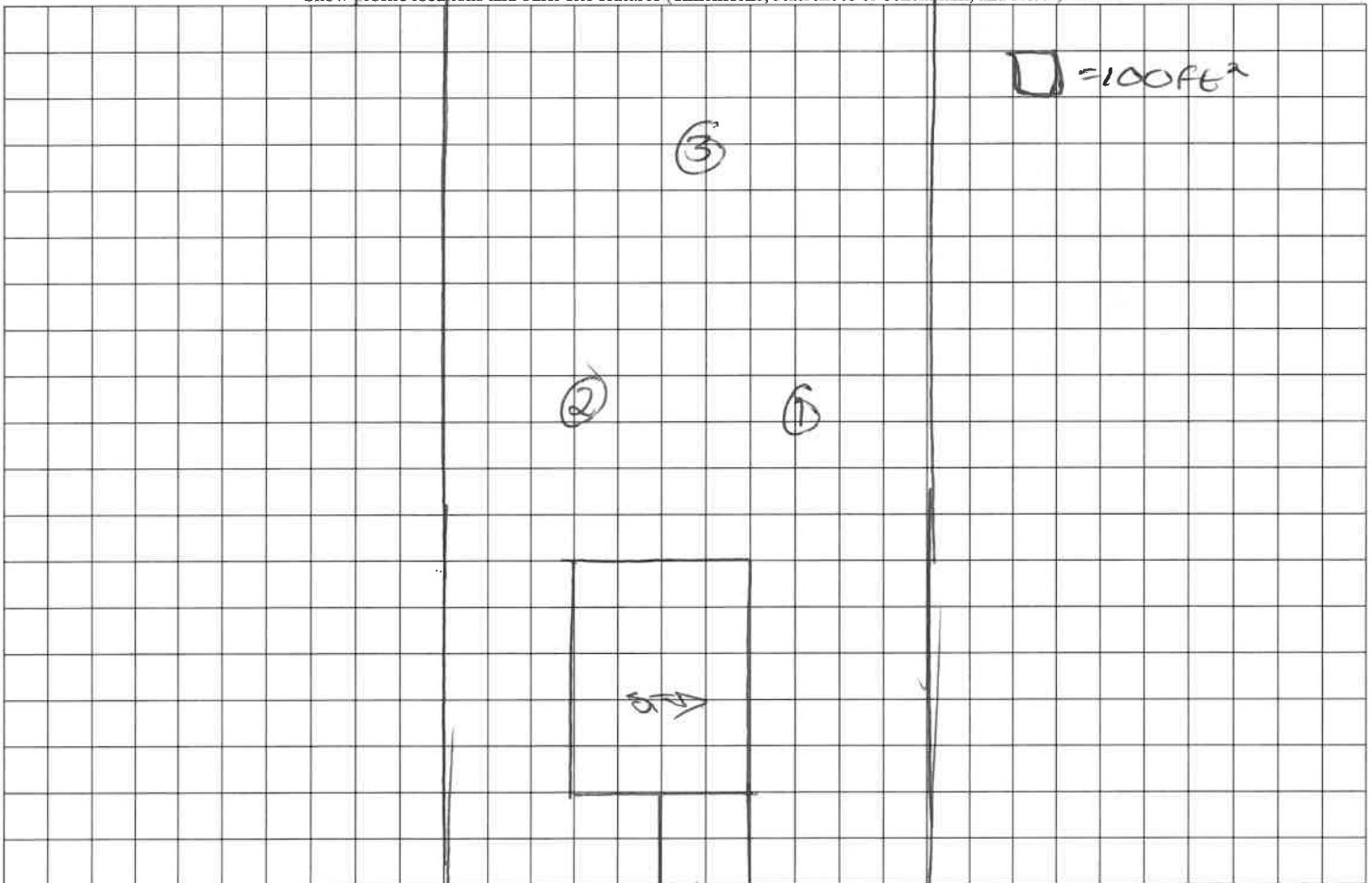

MILL BEND DIRT