

VICINITY MAP
(NO SCALE)

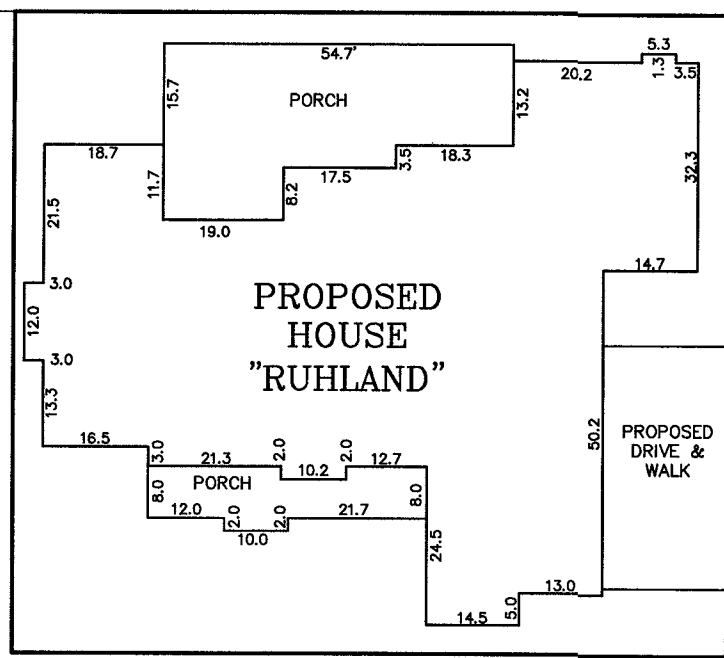

HOUSE INSERT
(1"=30')

NOTE : CONTRACTOR TO VERIFY ALL BUILDING SETBACKS PRIOR TO CONSTRUCTION.

KEITH BOUGHTON &
KELLY BOUGHTON
PIN# 0524-17-0903.000
D.B. 2337, PG. 679
P.B. 2007, PG. 78

BAUGHMAN SALLY
PIN# 0524-17-2435.000
D.B. 3808, PG. 449
P.B. 2017, PG. 218

ANDY RUHLAND
PIN# 0524-17-6389.000
D.B. 1739, PG. 420
P.B. 2005, PG. 275

KEITH BOUGHTON &
KELLY BOUGHTON
PIN# 0524-07-6417.000
D.B. 2337, PG. 679
P.B. 2015, PG. 19

5.93
ACRES
258,462 SQ. FT.

KELLIE KELLY &
PATRICK KELLY
PIN# 0524-06-8944.000
D.B. 3507, PG. 470

ANDREW SCOTT RUHLAND
PIN# 0524-16-1932.000
D.B. 2889, PG. 378

BENNY G BAREFOOT &
ANDREW RUHLAND
PIN# 0524-16-3911.000
D.B. 2703, PG. 999

ANDY RUHLAND
PIN# 0524-17-6242.000
D.B. 1739, PG. 420
P.B. 2005, PG. 275

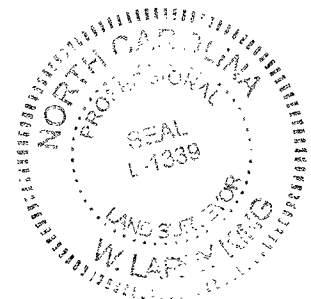

W. Larry King PLS 1339
W. LARRY KING, PLS - 1-1339

Larry King & Associates, R.L.S., P.A.
P.O. Box 53787
1333 Morganton Road, Suite 201
Fayetteville, NC 28305
Phone: (910)483-4300
Fax: (910)483-4052
www.LKandA.com
NC Firm License C-0887

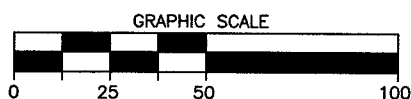

I, W. LARRY KING, CERTIFY THAT THIS MAP IS FOR THE PURPOSE OF PERMITTING ONLY, IT IS NOT A SURVEY AND NO RELIANCE MAY BE PLACED ON ITS ACCURACY. THE STRUCTURE SHOWN ON THIS PLOT PLAN IS PLACED ACCORDING TO THE INSTRUCTIONS GIVEN BY THE BUILDER. ALL DIMENSIONS AND SETBACKS SHOULD BE VERIFIED FOR COMPLIANCE WITH ZONING AND COVENANTS.

PLOT PLAN FOR: CHRIS ROBERTS
ADDRESS: 155 MOCKINGBIRD LANE
CITY OF: SPRING LAKE, NC
COUNTY OF: HARNETT

PLOT PLAN

TOWNSHIP OF: ANDERSON CREEK
REV DATE: DECEMBER 2ND, 2020
DATE: OCTOBER 23RD, 2020
SCALE: 1" = 50'

REFERENCE: 155 MOCKINGBIRD LANE
ANDREW S RUHLAND &
ANITA B RUHLAND
P.B. 2017, PG. 218

THIS MAP CAN NOT BE USED FOR RECORDATION OR ATTACHED TO A DEED TO BE RECORDED. THIS MAP IS NOT DRAWN IN ACCORDANCE WITH GS 47-30.

THE BOUNDARY AND LOT INFORMATION SHOWN ON THIS MAP IS TAKEN FROM THAT DOCUMENT DESCRIBED IN THE "REFERENCE" LINE SHOWN HEREON. THIS INFORMATION SHOULD BE CONFIRMED AS THE MOST CURRENT FOR THIS PROPERTY BEFORE ISSUANCE OF PERMITS OR COMMENCEMENT OF CONSTRUCTION. NO TITLE SEARCH WAS PERFORMED ON THIS PROPERTY BY THIS SURVEYOR.