

SFD2011-0057

SOIL/SITE EVALUATION
for ON-SITE WASTEWATER SYSTEM

Owner: - Applicant: SOUTHERSTEAD CONS. OF B.C.
 Address: 133 OLD BOYEB Date Evaluated: 12/09/2020
 Proposed Facility: CAN 15 Design Flow (.1949): 360GPD Property Size:
 Location of Site: Property Recorded:
 Water Supply: Public Individual Well Spring Other
 Evaluation Method: Auger Boring Pit Cut
 Type of Wastewater: Sewage Industrial Process Mixed

P R O F I L E #	.1940 Landscape Position/ Slope %	Horizon Depth (In.)	SOIL MORPHOLOGY .1941		OTHER PROFILE FACTORS				Profile Class & LTAR
			.1941 Structure/ Texture	.1941 Consistence Mineralogy	.1942 Soil Wetness/ Color	.1943 Soil Depth (IN.)	.1956 Sapro Class	.1944 Restr Horiz	
1	23-4%	0-18	CL LS	ML NSNP					PS
		18-48	ML SL	FL SP		48			G.35
2,3,4	23-4%	0-12	CL LS	ML NSNP					PS
		12-48	ML SL	FL SP		48			G.35

Description	Initial System	Repair System	Other Factors (.1946):
Available Space (.1945)	<input checked="" type="checkbox"/>	<input checked="" type="checkbox"/>	Site Classification (.1948): <u>PROVISIONALLY SUITABLE</u>
System Type(s)	<u>25/150</u>	<u>25/150</u>	Evaluated By: <u>ANDREW CURRINI, NERS</u>
Site LTAR	<u>G.35</u>	<u>G.35</u>	Others Present:

COMMENTS:

LANDSCAPE POSITIONS	GROUP	TEXTURES	.1955 LTAR	CONSISTENCE	MOIST	WET
R-RIDGE	I	S-SAND	1.2 - 0.8	VFR-VERY FRIABLE		NS-NON-STICKY
S-SHOULDER SLOPE		LS-LOAMY SAND		FR-FRIABLE		SS-SLIGHTLY STICKY
L-LINEAR SLOPE	II	SL-SANDY LOAM	0.8 - 0.6	FI-FIRM		S-STICKY
FS-FOOT SLOPE		L-LOAM		VFI-VERY FIRM		VS-VERY STICKY
N-NOSE SLOPE	III	SI-SILT	0.6 - 0.3	EFI-EXTREMELY FIRM		NP-NON-PLASTIC
H-HEAD SLOPE		SIL-SILT LOAM				SP-SLIGHTLY STICKY
CC-CONCLAVE SLOPE		CL-CLAY LOAM				P-PLASTIC
CV-CONVEX SLOPE		SCL-SANDY CLAY LOAM				VP-VERY PLASTIC
T-TERRACE	IV	SIC-SILTY CLAY	0.4 - 0.1			
FP-FLOOD PLAN		C-CLAY				
		SC-SANDY CLAY				

STRUCTURE
 SG-SINGLE GRAIN
 M- MASSIVE
 CR-CRUMB
 GR-GRANULAR
 SBK-SUBANGULAR BLOCKY
 ABK-ANGULAR BLOCKY
 PL-PLATY
 PR-PRISMATIC

MINERALOGY
 SLIGHTLY EXPANSIVE
 EXPANSIVE



Show profile locations and other site features (dimensions, references or benchmark, and North)

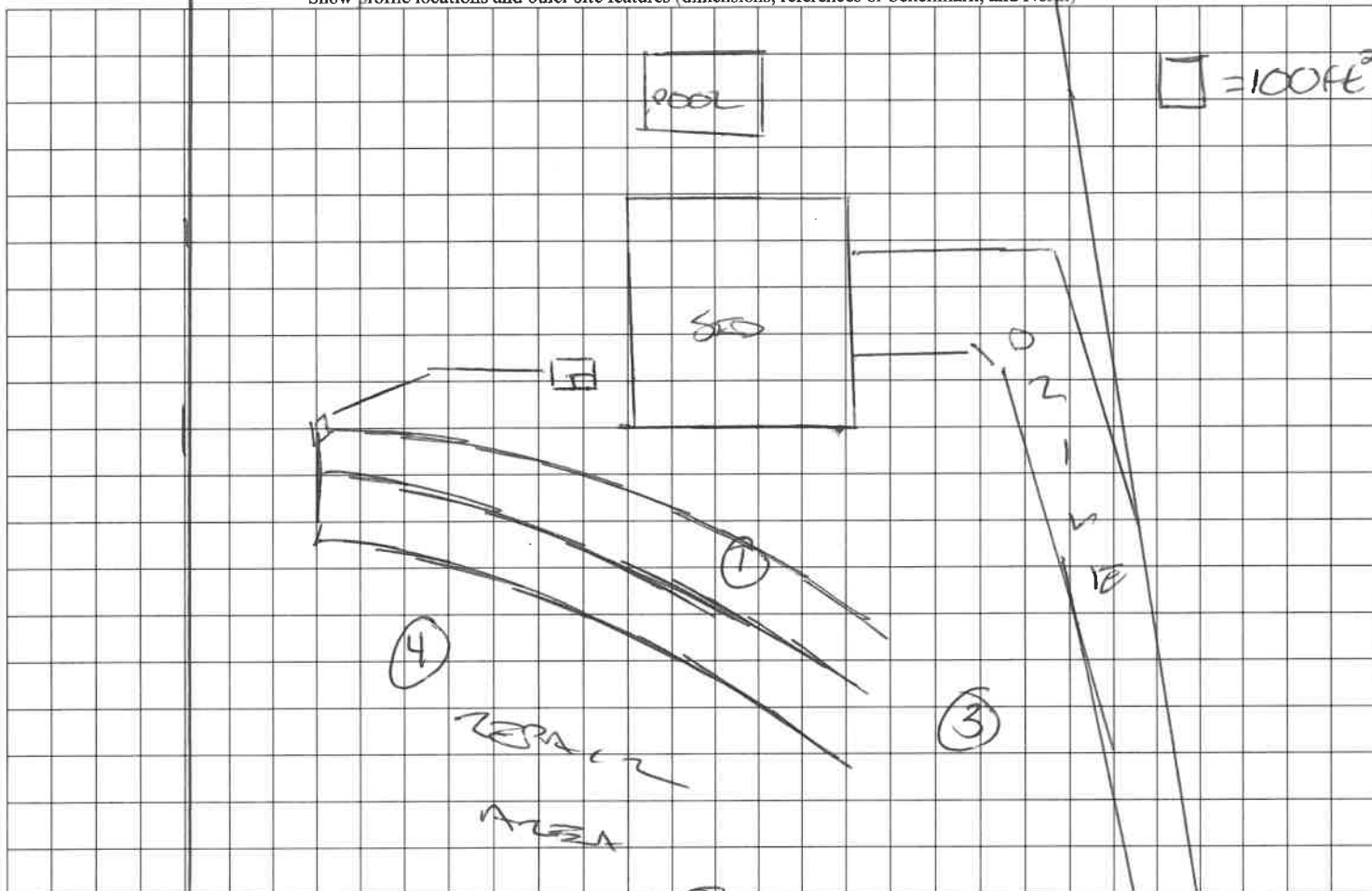

OLD BOILER CAN 10 (S21542)