

SOIL/SITE EVALUATION
for ON-SITE WASTEWATER SYSTEM

Owner: *Weaver Homes* Applicant:

Address: *941 Grametta*

Proposed Facility: *SFR*

Location of Site:

Water Supply:

Evaluation Method: Auger Boring

Type of Wastewater:

Date Evaluated:

Design Flow (.1949): *480 GAD*

Property Recorded:

Public Individual Well Spring Other

Pit Cut

Sewage Industrial Process Mixed

Property Size:

P R O F I L E #	.1940 Landscape Position/ Slope %	Horizon Depth (In.)	SOIL MORPHOLOGY .1941		OTHER PROFILE FACTORS				Profile Class & LTAR
			.1941 Structure/ Texture	.1941 Consistence Mineralogy	.1942 Soil Wetness/ Color	.1943 Soil Depth (IN.)	.1956 Sapro Class	.1944 Restr Horiz	
1	<i>L</i> <i>2-5%</i>	<i>0-2</i>	<i>LS(A) Gr</i>	<i>Fc/ns/np/nxp</i>					<i>U</i>
		<i>2-36</i>	<i>SCI SBk</i>	<i>Fc/ps/sp/sxp</i>	<i>- Parent Material</i>				
2	<i>L</i> <i>2-5%</i>	<i>0-2</i>	<i>LS(A) Gr</i>	<i>Fc/ns/np/nxp</i>					<i>U</i>
		<i>2-18</i>	<i>SL Gr</i>	<i>Fc/ns/np/nxp</i>					
		<i>18-36</i>	<i>SCI SBk</i>	<i>Fc/ps/sp/sxp</i>	<i>- Parent Material</i>				
3	<i>L</i> <i>2-5%</i>	<i>0-2</i>	<i>LS(A) Gr</i>	<i>Fc/ns/np/nxp</i>	<i>>48"</i>	<i>>48"</i>	<i>-</i>	<i>-</i>	<i>PS .5</i> <i>Group III</i>
		<i>2-28</i>	<i>SL Gr</i>	<i>Fc/ns/np/nxp</i>					
		<i>28-48</i>	<i>SCI SBk</i>	<i>Fc/ps/sp/sxp</i>					
4-5	<i>L</i> <i>2-5%</i>	<i>0-2</i>	<i>LS(A) Gr</i>	<i>Fill</i>					<i>PS .5</i> <i>Group III</i>
		<i>2-10</i>	<i>LS Gr</i>	<i>Fc/ns/np/nxp</i>	<i>>48"</i>	<i>>48"</i>			
		<i>10-14</i>	<i>LS(A) Gr</i>	<i>Fc/ns/np/nxp</i>					
		<i>14-48</i>	<i>SCI SBk</i>	<i>Fc/ps/sp/sxp</i>					

Description	Initial System	Repair System	Other Factors (.1946): Site Classification (.1948): <i>PS</i> Evaluated By: <i>M Osborne RETH</i> Others Present:
Available Space (.1945)	<i>✓</i>	<i>✓</i>	
System Type(s)	<i>25% ind</i>	<i>25% ind</i>	
Site LTAR	<i>.5</i>	<i>.5</i>	

COMMENTS: _____

LANDSCAPE POSITIONS	GROUP	TEXTURES	.1955 LTAR	CONSISTENCE MOIST	WET
R-RIDGE	I	S-SAND	1.2 - 0.8	VFR-VERY FRIABLE	NS-NON-STICKY
S-SHOULDER SLOPE		LS-LOAMY SAND		FR-FRIABLE	SS-SLIGHTY STICKY
L-LINEAR SLOPE	II	SL-SANDY LOAM	0.8 - 0.6	FI-FIRM	S-STICKY
FS-FOOT SLOPE		L-LOAM		VFI-VERY FIRM	VS-VERY STICKY
N-NOSE SLOPE	III	SI-SILT	0.6 - 0.3	EFI-EXTREMELY FIRM	NP-NON-PLASTIC
H-HEAD SLOPE		SIL-SILT LOAM			SP-SLIGHTLY STICKY
CC-CONCLAVE SLOPE		CL-CLAY LOAM			P-PLASTIC
CV-CONVEX SLOPE		SCL-SANDY CLAY LOAM			VP-VERY PLASTIC
T-TERRACE	IV	SIC-SILTY CLAY	0.4 - 0.1		
FP-FLOOD PLAN		C-CLAY			
		SC-SANDY CLAY			

STRUCTURE
 SG-SINGLE GRAIN
 M- MASSIVE
 CR-CRUMB
 GR-GRANULAR
 SBK-SUBANGULAR BLOCKY
 ABK-ANGULAR BLOCKY
 PL-PLATY
 PR-PRISMATIC

MINERALOGY
 SLIGHTLY EXPANSIVE
 EXPANSIVE

Show profile locations and other site features (dimensions, references or benchmark, and North)

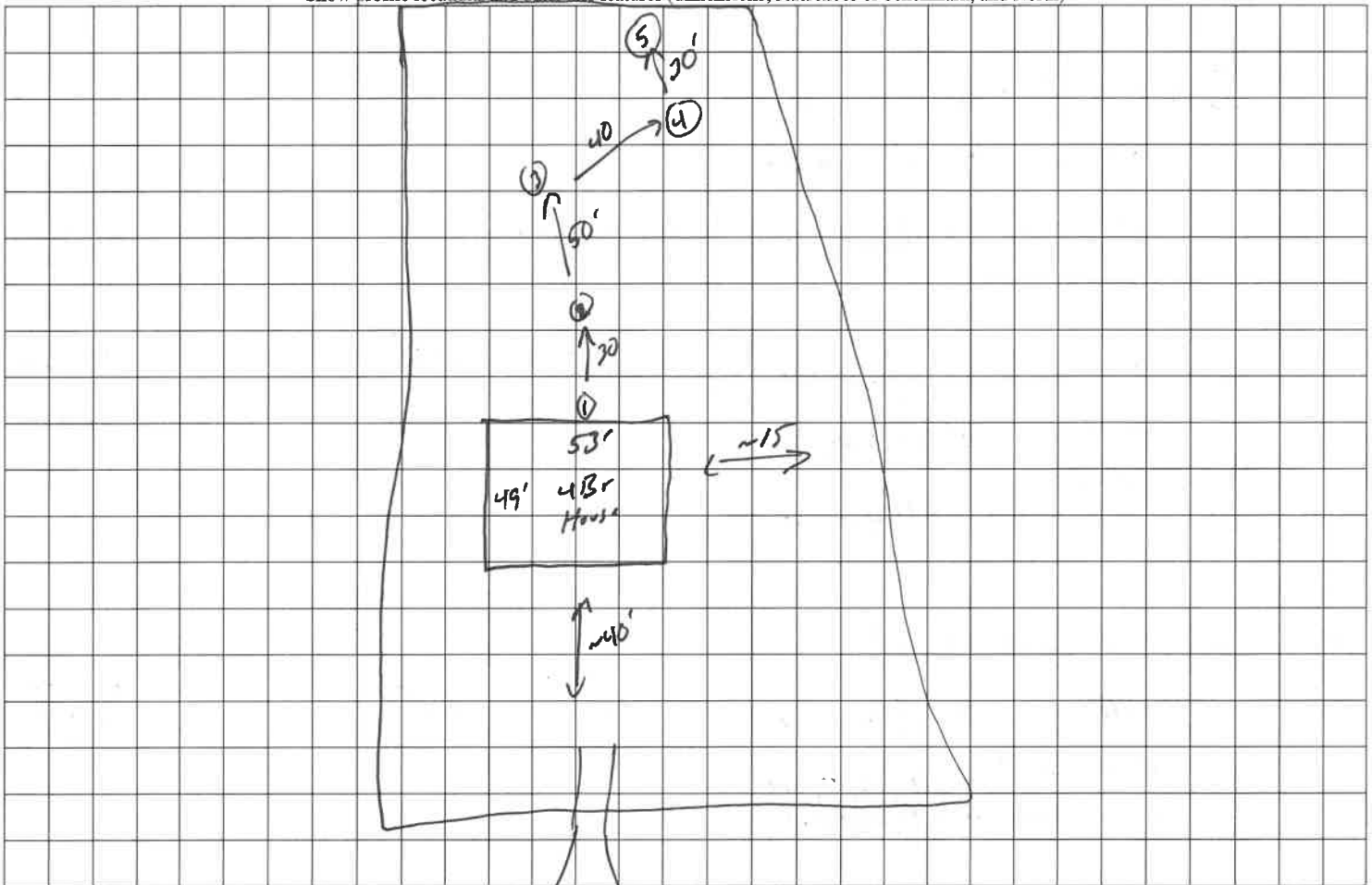

Granata Ln