

# Harnett County Department of Public Health Improvement Permit

A building permit cannot be issued with only an Improvement Permit

ISSUED TO: GARY ROBINSON HOMES PROPERTY LOCATION: 81 HAZELWOOD RD. (WELLS CREEK RD)  
 SUBDIVISION: SOUTH CREEK LOT # 66  
 NEW  REPAIR  EXPANSION   
 Type of Structure: 4-BEDROOM 62'x53' SFS  
 Proposed Wastewater System Type: 25% REDUCTION  
 Projected Daily Flow: 480 GPD  
 Number of bedrooms: 4 Number of Occupants: 8 max  
 Basement  Yes  No  
 Pump Required:  Yes  No  May be required based on final location and elevations of facilities  
 Type of Water Supply:  Community  Public  Well Distance from well NA feet Permit valid for:  Five years  
 No expiration  
 Permit conditions: \_\_\_\_\_

Authorized State Agent: [Signature] Date: 12/03/2020 SEE ATTACHED SITE SKETCH  
 The issuance of this permit by the Health Department in no way guarantees the issuance of other permits. The permit holder is responsible for checking with appropriate governing bodies in meeting their requirements. This site is subject to revocation if the site plan, plat, or the intended use changes. The Improvement Permit shall not be affected by a change in ownership of the site. This permit is subject to compliance with the provisions of the Laws and Rules for Sewage Treatment and Disposal and to conditions of this permit.

## Construction Authorization

(Required for Building Permit)

The construction and installation requirements of Rules .1950, .1952, .1954, .1955, .1956, .1957, .1958, and .1959 are incorporated by references into this permit and shall be met. Systems shall be installed in accordance with the attached system layout.

ISSUED TO: GARY ROBINSON HOMES PROPERTY LOCATION: 81 HAZELWOOD RD (WELLS CREEK RD)  
 SUBDIVISION: SOUTH CREEK LOT # 66  
 Facility Type: 4-BR 62'x53' SFS  New  Expansion  Repair  
 Basement?  Yes  No Basement Fixtures?  Yes  No  
 Type of Wastewater System\*\* PUMP TO 25% REDUCTION SFS. (Initial) Wastewater Flow: 480 GPD  
 (See note below, if applicable   
PUMP TO 25% REDUCTION (Repair)

Installation Requirements/Conditions  
 Septic Tank Size 1000 gallons Exact length of each trench 156 feet Trench Spacing: 9 Feet on Center  
 Pump Tank Size 1000 gallons Trenches shall be installed on contour at a Soil Cover: 8 inches  
 Maximum Trench Depth of: 20 inches (Maximum soil cover shall not exceed 36" above the trench bottom)  
 (Trench bottoms shall be level to +/- 1/4" in all directions)  
 Pump Requirements: \_\_\_\_\_ ft. TDH vs. \_\_\_\_\_ GPM Aggregate Depth: NA inches below pipe  
NA inches above pipe  
 Conditions: PUMP TO MEDIUM D-BOX REQUIRED NA inches total

WATER LINES (INCLUDING IRRIGATION) MUST BE 10FT. FROM ANY PART OF SEPTIC SYSTEM OR REPAIR AREA.  
NO UTILITIES ALLOWED IN INITIAL OR REPAIR DRAIN FIELD AREA.

\*\*If applicable: I understand the system type specified is different from the type specified on the application. I accept the specifications of this permit.

Owner/Legal Representative Signature: \_\_\_\_\_ Date: \_\_\_\_\_

This Construction Authorization is subject to revocation if the site plan, plat, or the intended use changes. The Construction Authorization shall not be transferred when there is a change in ownership of the site. This Construction Authorization is subject to compliance with the provisions of the Laws and Rules for Sewage Treatment and Disposal and to the conditions of this permit. SEE ATTACHED SITE SKETCH

Authorized State Agent: [Signature] Date: 12/03/2020  
ANDREW WILKIN Construction Authorization Expiration Date: 12/03/2025

Application # SFD 2010-002

## Harnett County Department of Public Health Site Sketch

Property Location: 81 HAZELWOOD ROAD (NEILLS CREEK ROAD)  
Issued To: GARY ROBINSON HOMES Subdivision SOUTH CREEK Lot # 66

Authorized State Agent: *Andrew Curran* Date: 12/03/2020  
ANDREW CURRAN

\* PUMP TO MEDIUM O-BOX REQUIRED

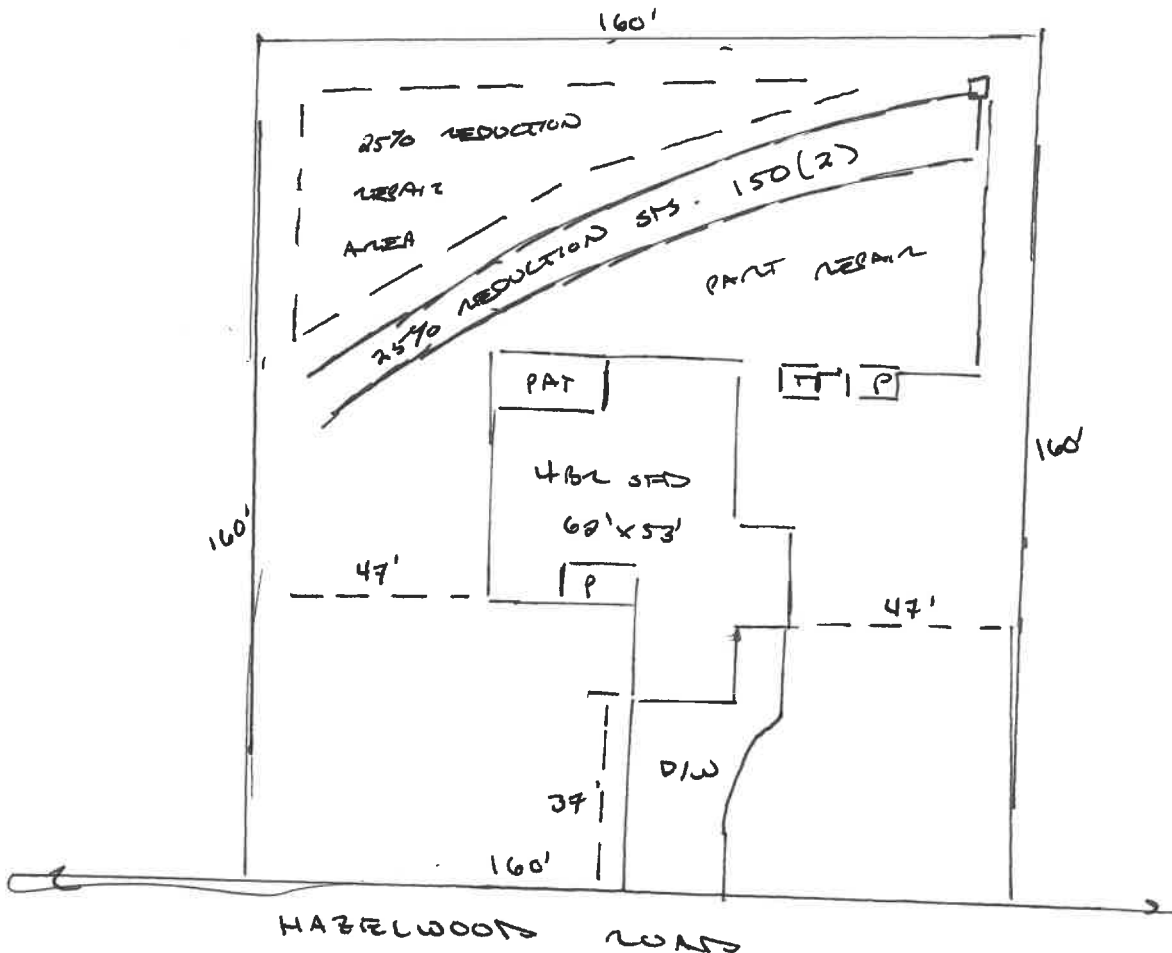

This drawing is for illustrative purposes only. System installation must meet all pertinent laws, rules, and regulations.