

VICINITY MAP (NTS)

- LEGEND**
- AC=AIR CONDITIONING UNIT
  - AG=ABOVE GROUND
  - BOC=BACK OF CURB
  - BG=BELOW GROUND
  - CATV=CABLE TV
  - CB=CATCH BASIN
  - CVRD=COVERED
  - DW=CONC DRIVEWAY
  - EB=ELECTRIC BOX
  - EM=ELECTRIC METER
  - EOP=EDGE OF PAVEMENT
  - EP=ELECTRIC PEDESTAL
  - FH=FIRE HYDRANT
  - ICV=IRRIGATION CONTROL VALVE
  - LP=LIGHT POLE
  - MTR=METER
  - N/F=NOW OR FORMERLY
  - PO=PORCH
  - PP=POWER POLE
  - RCP=REINFORCED CONC PIPE
  - R/W=RIGHT OF WAY
  - SCO=CLEANOUT
  - SW=SIDEWALK
  - TP=TELEPHONE PEDESTAL
  - TF=TRANSFORMER
  - WM=WATER METER
  - WV=WATER VALVE
  - EIP=EXISTING IRON PIPE
  - IRON PIPE SET
  - EIR=EXISTING IRON ROD

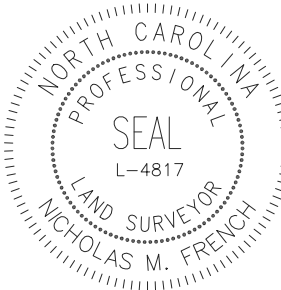

**CERTIFICATE OF ACCURACY & MAPPING**  
 I NICHOLAS M. FRENCH PLS CERTIFY THAT THIS MAP WAS DRAWN UNDER MY SUPERVISION FROM AN ACTUAL FIELD SURVEY DONE UNDER MY SUPERVISION, AND THAT THE ERROR OF CLOSURE AS COMPUTED BY CO-ORDINATES IS LESS THAN 1:10,000.

*Nicholas M. French* 05-03-2023  
 NICHOLAS M. FRENCH, PLS L-4817 DATE

THIS MAP IS ONLY INTENDED FOR THE PARTIES AND PURPOSES SHOWN. THIS MAP IS NOT FOR RECORDATION. NO TITLE REPORT PROVIDED. ANY VISIBLE ENCROACHMENTS ARE SHOWN HEREON.

THIS MAP MAY NOT BE A CERTIFIED SURVEY AND HAS NOT BEEN REVIEWED BY LOCAL GOVERNMENT AGENCY FOR COMPLIANCE WITH ANY APPLICABLE LAND DEVELOPMENT REGULATIONS AND HAS NOT BEEN REVIEWED FOR COMPLIANCE WITH RECORDING REQUIREMENTS FOR PLATS.

CURVE TABLE				
CURVE	BEARING	CHORD	RADIUS	ARC
C1	S 82°31'27" E	39.73'	50.19'	40.85'

**SETBACKS PER**  
 PB 2009 PG 96-99

FRONT 30'  
 (IF STREET R/W IS 60' OR MORE)  
 35'  
 (IF STREET R/W IS LESS THAN 60')

SIDE 10'  
 REAR 25'  
 SIDE STREET 20'

**IMPERVIOUS AREA**

HOUSE 1,726 SQ.FT.  
 DRIVE TO R/W 1,147 SQ.FT.  
 WALK 81 SQ.FT.  
 DECK 140 SQ.FT.  
 AC PAD 9 SQ.FT.

TOTAL 3,103 SQ.FT.

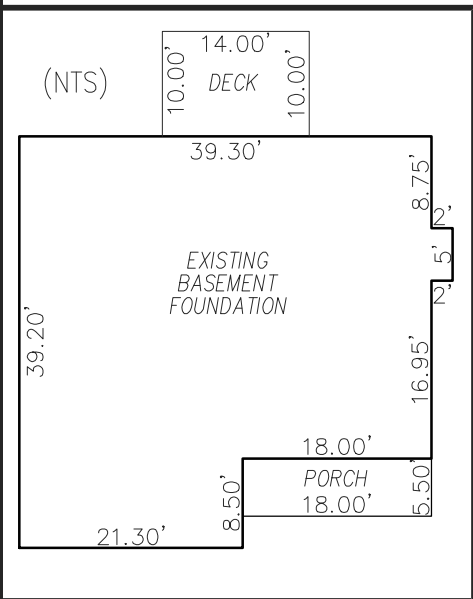

**GENERAL NOTES:**

1. ALL DISTANCES ARE HORIZONTAL GROUND DISTANCES IN U.S. SURVEY FEET UNLESS OTHERWISE NOTED.
2. AREAS SHOWN HEREON WERE COMPUTED USING THE COORDINATE METHOD.
3. LINES NOT SURVEYED ARE SHOWN AS DASHED LINES FROM INFORMATION REFERENCED ON THE FACE OF THIS SURVEY.
4. PROPERTY MAY BE SUBJECT TO ANY/ALL EASEMENTS AND RESTRICTIONS OF RECORD. THIS SURVEY IS A CORRECT REPRESENTATION OF THE LAND PLATTED AND OR DEEDED AND HAS BEEN PREPARED WITHOUT THE BENEFIT OF A TITLE REPORT. A NORTH CAROLINA LICENSED ATTORNEY-AT-LAW SHOULD BE CONSULTED REGARDING CORRECT OWNERSHIP, WIDTH AND LOCATION OF EASEMENTS, AND OTHER TITLE QUESTIONS REVEALED BY TITLE EXAMINATION.
5. THIS MAP MAY NOT BE A CERTIFIED SURVEY AND HAS NOT BEEN REVIEWED BY A LOCAL GOVERNMENT AGENCY FOR COMPLIANCE WITH ANY APPLICABLE LAND DEVELOPMENT REGULATIONS AND HAS NOT BEEN REVIEWED FOR COMPLIANCE WITH RECORDING REQUIREMENTS FOR PLATS.
6. WETLANDS SHOWN HEREON SCALED FROM PB 2009 PGS 96-99
7. THIS PARCEL IS NOT LOCATED WITHIN A FLOOD HAZARD ZONE AS INDICATED ON CID NO. 370328 PANEL 9546, SUFFIX L HARNETT COUNTY WITH AN EFFECTIVE DATE OF 10/17/2006.

**NOTE: WETLANDS**  
 LOCATION & WETLANDS SETBACK SHOWN HEREON ARE APPROXIMATE AND HAVE BEEN SCALED FROM PB 2009, PG 96-99. NOT TO BE USED FOR STAKING PURPOSES.

MARGERY S. OVERTON  
 PIN: 9567-11-0259  
 DB.PG.: 2196/579  
 MB.PG.: 2006/93

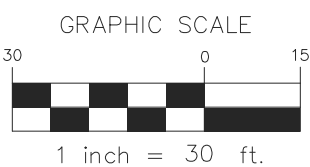
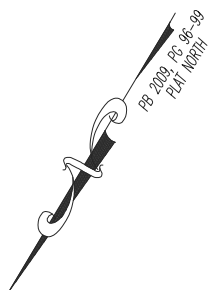

**FOUNDATION SURVEY**

<b>STAGE</b>	PROJECT: RES. PROJ. 21-002 CAROLINA SEASONS
	DRAWN BY: SSH/SEER
	SURVEYED BY: C. NARRON
	SCALE: 1"=30'
	FIELD WORK: 04-27-2023    DWG DATE: 05-03-2023

FOR  
**NICOLAS ALVAREZ**  
 11 SPRING FLOWERS DRIVE  
 LOT 10 CAROLINA SEASONS SUBDIVISION PH 2  
 JOHNSONVILLE TWP., HARNETT CO., NC  
 P.B. 2009, PG. 96-99

**ECLS**  
 GLOBAL, INC.  
 U.S. VETERAN-OWNED  
 19 N MCKINLEY ST  
 COATS, NC 27521  
 910.897.3257 ECLSGLOBALINC.COM  
 910.897.2329 (FAX) CO#C-4175