

FOUNDATION PLAN CRAWL SPACE OPTION

$1/4" = 1'-0"$

TO PER BUILDER

45'-6"

SEE DETAIL FOR REPAIR
OF FOOTINGS WHERE
PIER IS NOT IN CENTER
8" OF FOOTING, TYP
THROUGHOUT PLANS

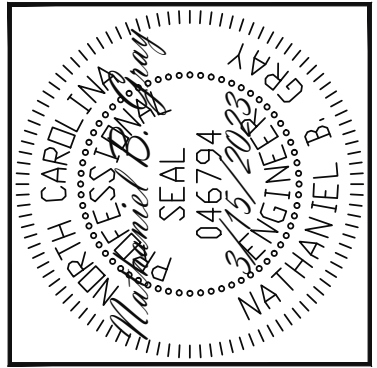
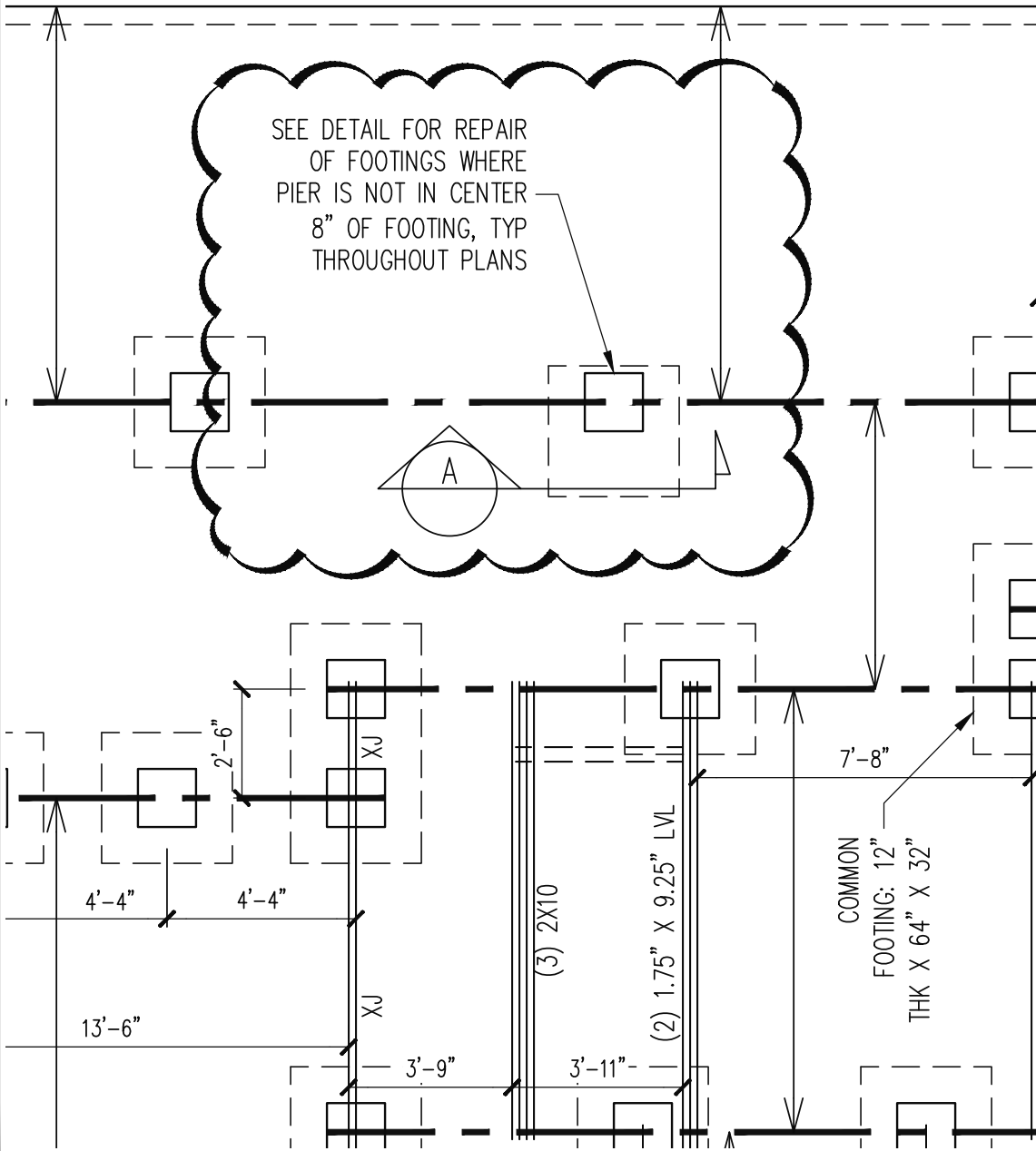

Engineering
Lech
ASSOCIATES, P.A.

STRUCTURAL ENGINEERS
License No. C-3870
318 W Millbrook Rd. Unit 201
Raleigh, North Carolina 27609
Phone (919) 844-1661

ADAMS HOMES			
SCOPE	FOOTIN PROJECTION REPAIR	REV #	REF PROJ #
LOC	9 CAROLINA SEASON	DATE	

ENG: **NBC**
DATE: **3/15/2023**

PARENT
22-18-069

PROJECT NO.
23-75-253

SHEET NO.
SL1

1 of 2

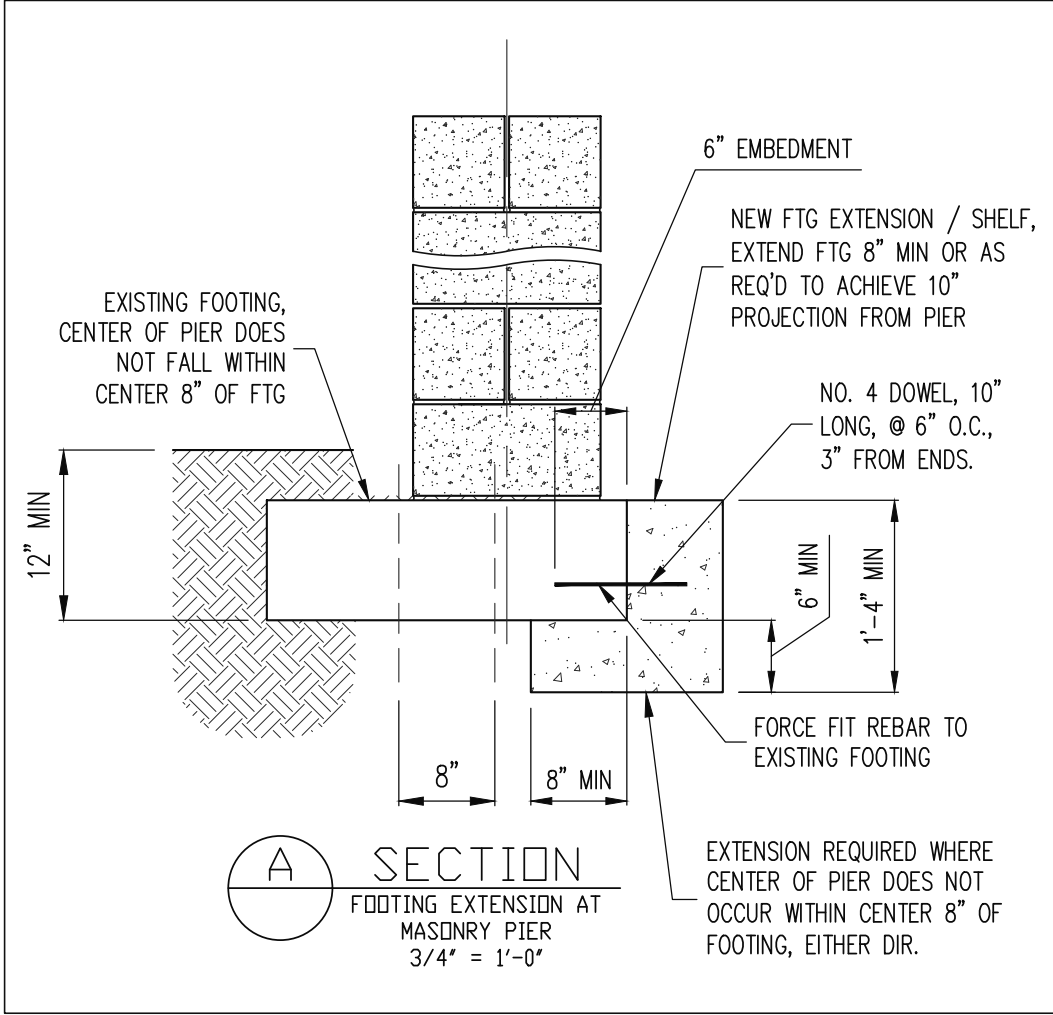
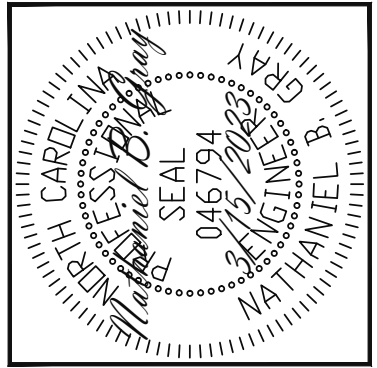

Engineering
Lech
ASSOCIATES, P.A.

STRUCTURAL ENGINEERS
License No. C-3870
318 W Millbrook Rd. Unit 201
Raleigh, North Carolina 27609
Phone (919) 844-1661

ADAMS HOMES		REV #	REF PROJ #	DATE
SCOPE	FOOTING PROJECTION REPAIR			
LOC	9 CAROLINA SEASON			

ENG: **NBC**
DATE: **3/15/2023**

PARENT
22-18-069

PROJECT NO.
23-75-253

SHEET NO.
SL2