

Harnett County Department of Public Health Improvement Permit

A building permit cannot be issued with only an Improvement Permit

ISSUED TO: Adams Homes PROPERTY LOCATION: 514 Green Links Dr
 SUBDIVISION Carolina Seasons LOT # 3

NEW REPAIR EXPANSION Site Improvements required prior to Construction Authorization Issuance:

Type of Structure: SFR (46'x51')

Proposed Wastewater System Type: 50% Reduction

Projected Daily Flow: 360 GPD

Number of bedrooms: 3 Number of Occupants: 6 max

Basement Yes No

Pump Required: Yes No May be required based on final location and elevations of facilities

Type of Water Supply: Community Public Well Distance from well _____ feet

Permit valid for: Five years
 No expiration

Permit conditions: _____

Authorized State Agent: Mark J. Potts Date: 11-18-2020 SEE ATTACHED SITE SKETCH

The issuance of this permit by the Health Department in no way guarantees the issuance of other permits. The permit holder is responsible for checking with appropriate governing bodies in meeting their requirements. This site is subject to revocation if the site plan, plat, or the intended use changes. The Improvement Permit shall not be affected by a change in ownership of the site. This permit is subject to compliance with the provisions of the Laws and Rules for Sewage Treatment and Disposal and to conditions of this permit.

Construction Authorization

(Required for Building Permit)

The construction and installation requirements of Rules .1950, .1952, .1954, .1955, .1956, .1957, .1958, and .1959 are incorporated by references into this permit and shall be met. Systems shall be installed in accordance with the attached system layout.

ISSUED TO: Adams Homes PROPERTY LOCATION: 514 Green Links Dr
 SUBDIVISION Carolina Seasons LOT # 3

Facility Type: SFR (46'x51') New Expansion Repair

Basement? Yes No Basement Fixtures? Yes No

Type of Wastewater System** 50% Reduction (PPB) (Initial) Wastewater flow: 360 GPD
 (See note below, if applicable)

50% Reduction (Repair)

Installation Requirements/Conditions

Septic Tank Size <u>1000</u> gallons	Number of trenches <u>3</u>	Trench Spacing: <u>9</u> Feet on Center
Pump Tank Size <u>1000</u> gallons	Exact length of each trench <u>40</u> feet	Soil Cover: <u>6</u> inches
	Trenches shall be installed on contour at a	(Maximum soil cover shall not exceed
	Maximum Trench Depth of: <u>18-26</u> inches	<u>36"</u> above the trench bottom)
	(Trench bottoms shall be level to $\pm 1/4"$	
	in all directions)	

Pump Requirements: _____ ft. TDH vs. _____ GPM

Aggregate Depth: _____ inches below pipe
 _____ inches above pipe
 _____ inches total

Conditions: _____

**WATER LINES (INCLUDING IRRIGATION) MUST BE 10FT. FROM ANY PART OF SEPTIC SYSTEM OR REPAIR AREA.
 NO UTILITIES ALLOWED IN INITIAL OR REPAIR DRAIN FIELD AREA.**

**If applicable: I understand the system type specified is different from the type specified on the application. I accept the specifications of this permit.

Owner/Legal Representative Signature: _____ Date: _____

This Construction Authorization is subject to revocation if the site plan, plat, or the intended use changes. The Construction Authorization shall not be transferred when there is a change in ownership of the site. This Construction Authorization is subject to compliance with the provisions of the Laws and Rules for Sewage Treatment and Disposal and to the conditions of this permit. SEE ATTACHED SITE SKETCH

Authorized State Agent: Mark J. Potts Date: 11-18-2020
 Construction Authorization Expiration Date: 11-18-2025

Application # SFD2010-0033 R

Harnett County Department of Public Health Site Sketch

Property Location: 514 Green Links Dr.

Issued To: Adams Homes Subdivision Carolina Seasons Lot # 3

Authorized State Agent: [Signature] Date: 11-18-2020

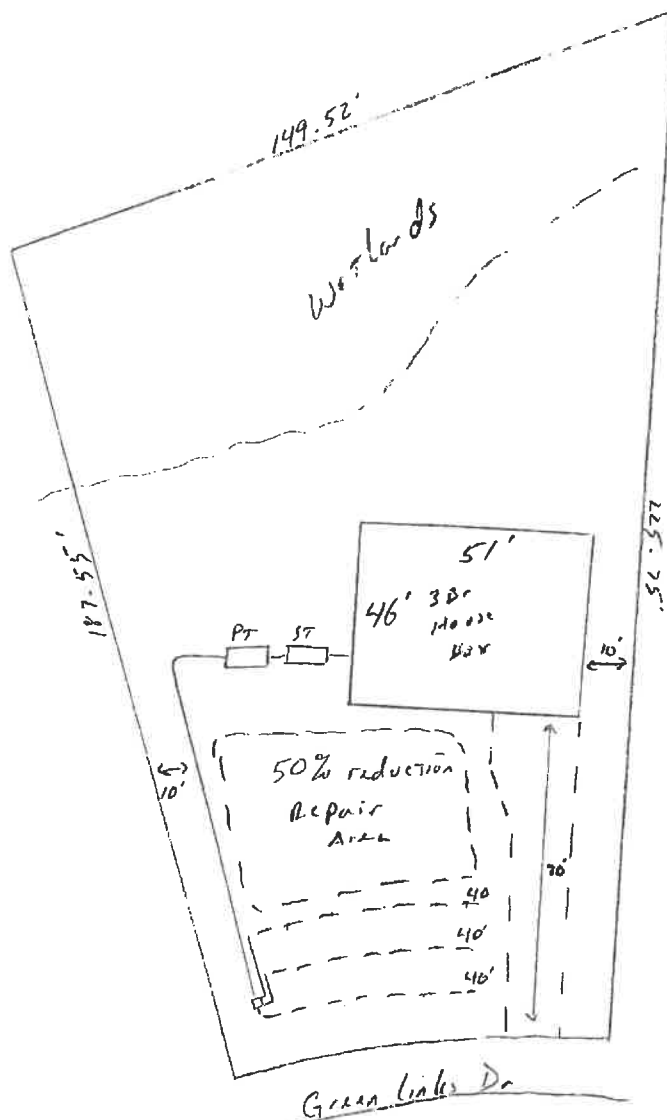

This drawing is for illustrative purposes only. System installation must meet all pertinent laws, rules, and regulations.