

HAL OWEN & ASSOCIATES, INC.

SOIL & ENVIRONMENTAL SCIENTISTS

P.O. Box 400, Lillington NC 27546-0400
Phone (910) 893-8743 / Fax (910) 893-3594
www.halowensoil.com

8 November 2019

Mr. David Jackson
857 Mann Rd
Coats, NC 27521

Reference: Preliminary Soil Investigation
Par B David Lendon Jackson Jr MAP#2019-328; NC PIN 1519-07-5673

Dear Mr. Jackson,

It was my pleasure to meet you at the referenced property to investigate the ability of the soils to support a subsurface sewage waste disposal system and repair area for a typical three or four bedroom home. All soil ratings and determinations were made in accordance with "Laws and Rules for Sewage Treatment and Disposal Systems, 15A NCAC 18A .1900". It is my understanding that a septic system and public water supply will be utilized at this site. However it appears that adequate space exists on the property to site a well if you want or need.

A little over an acre of this property was investigated and found to be underlain by provisionally suitable soils for subsurface sewage waste disposal. These provisionally suitable soils were observed to be friable sandy clay loams to greater than 30 inches and appear adequate to support long term acceptance rates of 0.4 gal/day/sqft. In other words, you should expect that about 80 to 100 feet of conventional drainline will be required for each proposed bedroom in the home. It appears that the soils on this property are adequate to support a conventional septic system and repair area for at least one residence.

I appreciate the opportunity to provide this service and hope to be allowed to assist you again in the future. If you have any questions or need additional information, please contact me at your convenience.



Sincerely,

Hal Owen
Licensed Soil Scientist

Preliminary Soil Investigation
Par B David Lendon Jackson Jr MAP#2019-328; NC PIN 1519-07-5673
8 November 2019

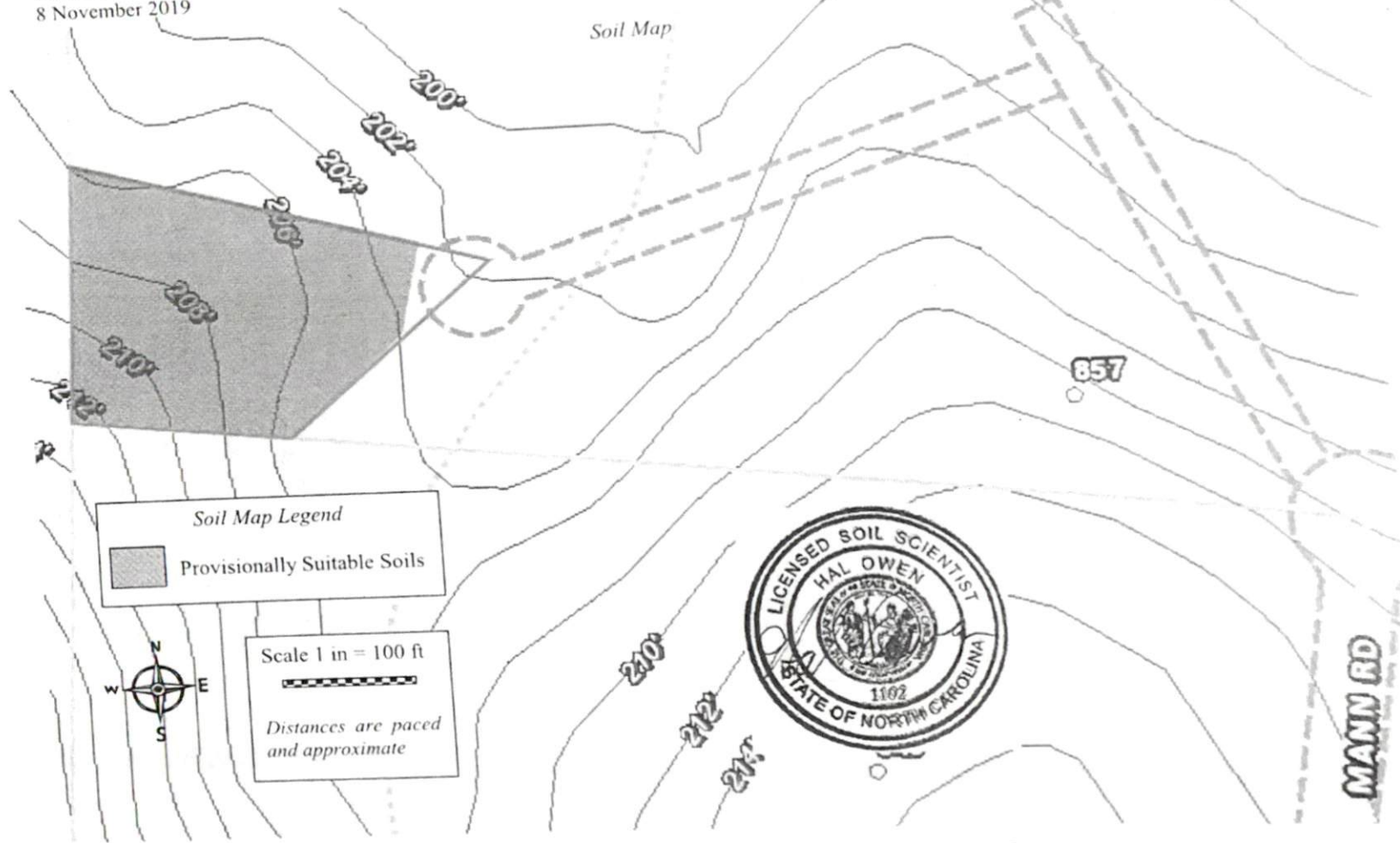

MANN RD