

**SOIL/SITE EVALUATION
 for ON-SITE WASTEWATER SYSTEM**

Owner: - Applicant: BANETOOK BLDG CO.
 Address: 2655 E Date Evaluated: 10/15/2020
 Proposed Facility: Design Flow (.1949): Property Size:
 Location of Site: 3255 Property Recorded: 3606PD
 Water Supply: Public Individual Well Spring Other
 Evaluation Method: Auger Boring Pit Cut
 Type of Wastewater: Sewage Industrial Process Mixed

| P R O F I L E # | .1940 Landscape Position/ Slope % | Horizon Depth (In.) | SOIL MORPHOLOGY .1941 | | OTHER PROFILE FACTORS | | | | Profile Class & LTAR |
|--------------------------------------|--|---------------------------|--------------------------------|------------------------------------|------------------------------------|------------------------------|-------------------------|-------------------------|----------------------------|
| | | | .1941 Structure/ Texture | .1941 Consistence Mineralogy | .1942 Soil Wetness/ Color | .1943 Soil Depth (IN.) | .1956 Sapro Class | .1944 Restr Horiz | |
| | | | | | | | | | |
| 1,4 | L 3-5% | 0-12 | CL LS | VEL NSNP | | | | | PS |
| | | 12-48 | CL SLL | FI SP | | 48 | | | 0.35 |
| | | | | | | | | | |
| 2 | L 3-5% | 0-12 | CL LS | VEL NSNP | | | | | |
| | | 12-44 | CL SLL | FI SP | | | | | PS |
| | | 44+ | PARENT MGT | - | | 44 | | | 0.35 |
| | | | | | | | | | |
| 3 | L 3-5% | 0-12 | CL LS | VEL NSNP | | | | | PS |
| | | 12-48 | CL SLL | FI SP | | 48 | | | 0.35 |
| | | | | | | | | | |
| | | | | | | | | | |
| | | | | | | | | | |
| | | | | | | | | | |
| | | | | | | | | | |
| | | | | | | | | | |
| | | | | | | | | | |
| | | | | | | | | | |
| | | | | | | | | | |

| | | | |
|-------------------------|-------------------------------------|-------------------------------------|--|
| Description | Initial System | Repair System | Other Factors (.1946): |
| Available Space (.1945) | <input checked="" type="checkbox"/> | <input checked="" type="checkbox"/> | Site Classification (.1948): PROVISIONALY SUITABLE |
| System Type(s) | 25% MTD | 25% MTD | Evaluated By: |
| Site LTAR | 0.35 | 0.35 | Others Present: ANDREW CURRIN, REHS |

COMMENTS: _____

| LANDSCAPE POSITIONS | GROUP | TEXTURES | .1955 LTAR | CONSISTENCE MOIST | WET |
|------------------------------------|-------|---|------------|--------------------------------|--------------------------------------|
| R-RIDGE | I | S-SAND | 1.2 - 0.8 | VFR-VERY FRIABLE FR-FRIABLE | NS-NON-STICKY SS-SLIGHTLY STICKY |
| S-SHOULDER SLOPE L-LINEAR SLOPE | | LS-LOAMY SAND | | | |
| FS-FOOT SLOPE | II | SL-SANDY LOAM | 0.8 - 0.6 | FI-FIRM VFI-VERY FIRM | S-STICKY VS-VERY STICKY |
| N-NOSE SLOPE H-HEAD SLOPE | | L-LOAM | | | |
| CC-CONCLAVE SLOPE | III | SI-SILT | 0.6 - 0.3 | EFI-EXTREMELY FIRM | NP-NON-PLASTIC SP-SLIGHTLY STICKY |
| CV-CONVEX SLOPE | | SIL-SILT LOAM | | | |
| T-TERRACE FP-FLOOD PLAN | | CL-CLAY LOAM SCL-SANDY CLAY LOAM | | | |
| | IV | SIC-SILTY CLAY C-CLAY SC-SANDY CLAY | 0.4 - 0.1 | | |

- STRUCTURE
 SG-SINGLE GRAIN
 M-MASSIVE
 CR-CRUMB
 GR-GRANULAR
 SBK-SUBANGULAR BLOCKY
 ABK-ANGULAR BLOCKY
 PL-PLATY
 PR-PRISMATIC

- MINERALOGY
 SLIGHTLY EXPANSIVE
 EXPANSIVE

Show profile locations and other site features (dimensions, references or benchmark, and North)

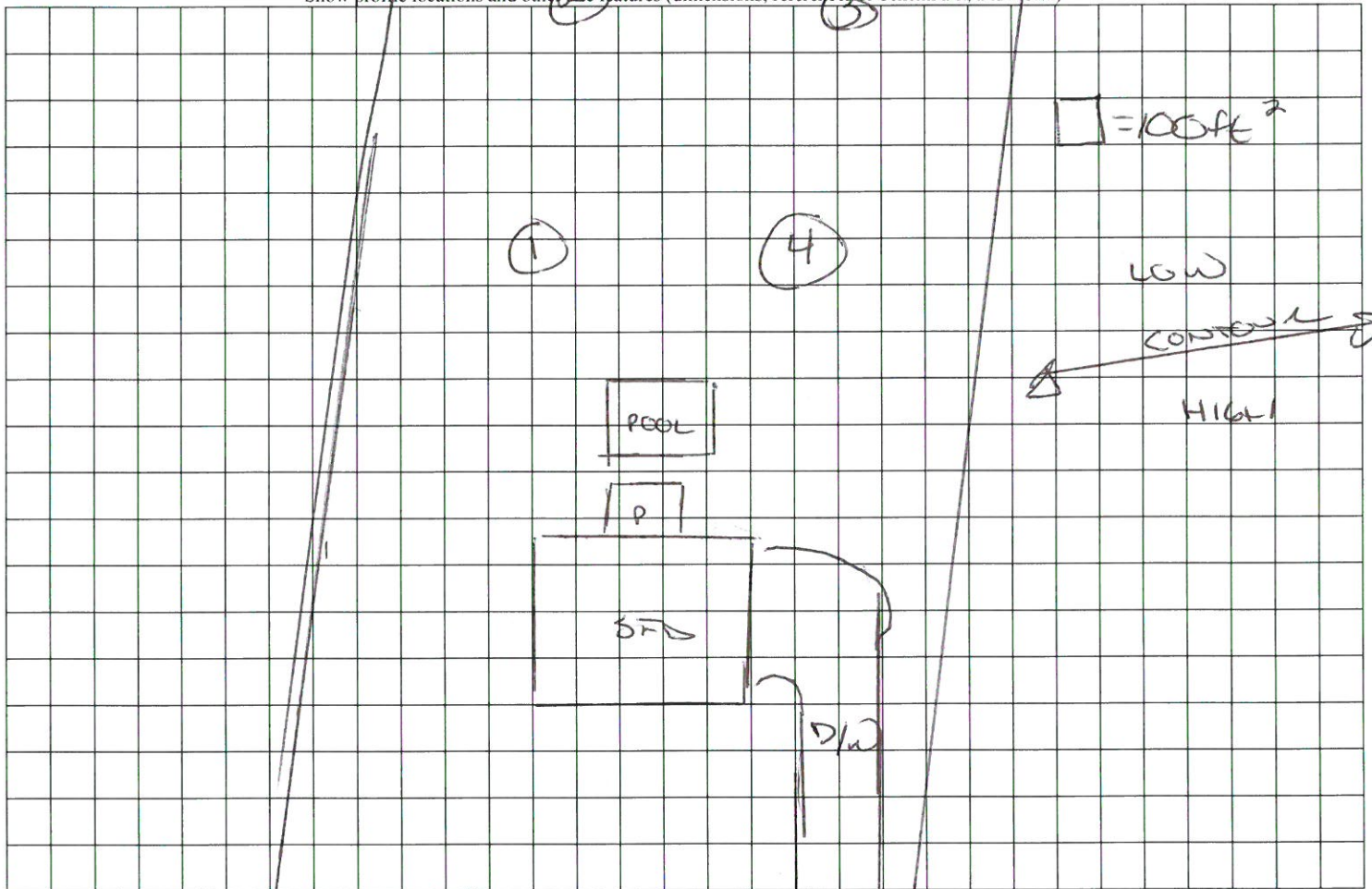

N C S S E