

## Harnett County Department of Public Health Improvement Permit

A building permit cannot be issued with only an Improvement Permit

PROPERTY LOCATION: 219 Harvell Road (SR 2008)

ISSUED TO: STE General Contractors, LLC SUBDIVISION \_\_\_\_\_ LOT # \_\_\_\_\_

NEW  REPAIR  EXPANSION  Site Improvements required prior to Construction Authorization Issuance: \_\_\_\_\_

Type of Structure: 48x90 sfd, 3 beds 3 baths

Proposed Wastewater System Type: 25% Reduction System

Projected Daily Flow: 360 GPD

Number of bedrooms: 3 Number of Occupants: 6 max

Basement  Yes  No

Pump Required:  Yes  No  May be required based on final location and elevations of facilities

Type of Water Supply:  Community  Public  Well Distance from well NA feet Permit valid for:  Five years  No expiration

Permit conditions: \_\_\_\_\_

Authorized State Agent: [Signature] Date: 09/28/2020 SEE ATTACHED SITE SKETCH

The issuance of this permit by the Health Department in no way guarantees the issuance of other permits. The permit holder is responsible for checking with appropriate governing bodies in meeting their requirements. This site is subject to revocation if the site plan, plat, or the intended use changes. The Improvement Permit shall not be affected by a change in ownership of the site. This permit is subject to compliance with the provisions of the Laws and Rules for Sewage Treatment and Disposal and to conditions of this permit.

## Construction Authorization

(Required for Building Permit)

The construction and installation requirements of Rules .1950, .1952, .1954, .1955, .1956, .1957, .1958, and .1959 are incorporated by references into this permit and shall be met. Systems shall be installed in accordance with the attached system layout.

ISSUED TO: STE General Contractors, LLC PROPERTY LOCATION: 219 Harvell Road (SR 2008)

SUBDIVISION \_\_\_\_\_ LOT # \_\_\_\_\_

Facility Type: 48x90 sfd, 3 beds 3 baths  New  Expansion  Repair

Basement?  Yes  No Basement Fixtures?  Yes  No

Type of Wastewater System\*\* 25% Reduction System (Initial) Wastewater Flow: 360 GPD

(See note below, if applicable ) Pump to 25% Reduction (Repair)

Installation Requirements/Conditions	Number of trenches <u>3</u>	
Septic Tank Size <u>1000</u> gallons	Exact length of each trench <u>80</u> feet	Trench Spacing: <u>9</u> Feet on Center
Pump Tank Size _____ gallons	Trenches shall be installed on contour at a Maximum Trench Depth of: <u>28</u> inches (Trench bottoms shall be level to +/-1/4" in all directions)	Soil Cover: <u>16</u> inches (Maximum soil cover shall not exceed 36" above the trench bottom)
Pump Requirements: _____ ft. TDH vs. _____ GPM		Aggregate Depth: <u>NA</u> inches below pipe <u>NA</u> inches above pipe <u>NA</u> inches total

Conditions: Gravity to D-Box Equal Distribution Required

**WATER LINES (INCLUDING IRRIGATION) MUST BE 10FT. FROM ANY PART OF SEPTIC SYSTEM OR REPAIR AREA.  
NO UTILITIES ALLOWED IN INITIAL OR REPAIR DRAIN FIELD AREA.**

\*\*If applicable: I understand the system type specified is different from the type specified on the application. I accept the specifications of this permit.

Owner/Legal Representative Signature: \_\_\_\_\_ Date: \_\_\_\_\_

This Construction Authorization is subject to revocation if the site plan, plat, or the intended use changes. The Construction Authorization shall not be transferred when there is a change in ownership of the site. This Construction Authorization is subject to compliance with the provisions of the Laws and Rules for Sewage Treatment and Disposal and to the conditions of this permit. SEE ATTACHED SITE SKETCH

Authorized State Agent: [Signature] Date: 09/28/2020 11/18/2020  
ANDREW WAIN Construction Authorization Expiration Date: 06/28/2025 11/18/2025

# Harnett County Department of Public Health Site Sketch

Property Location: 219 Harvell Road (SR 2008)

Issued To: STE General Contractors, LLC Subdivision \_\_\_\_\_ Lot # \_\_\_\_\_

Authorized State Agent: *[Signature]* Date: 11/18/2020

ANDREW LAMIN

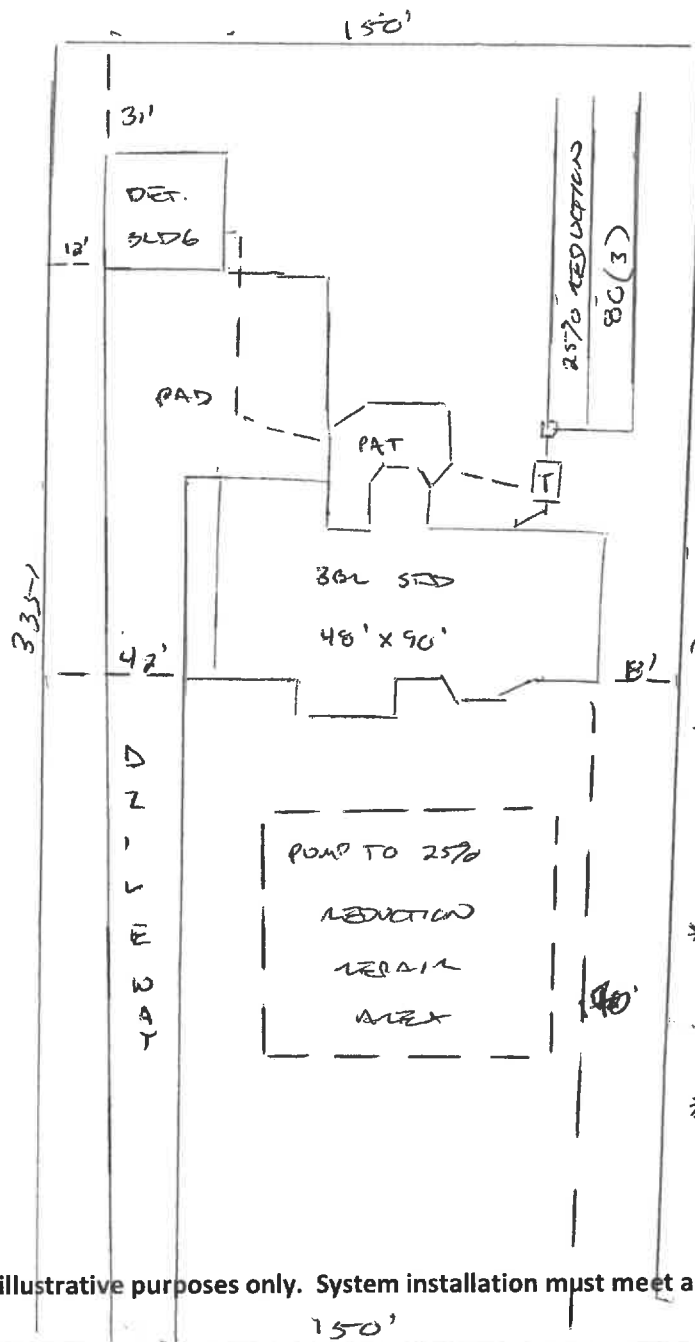

- \* GRAVITY TO D-BOX EQUAL DISTRIBUTION
- \* REVIEW PLUMBING TALL REQUIREMENTS PRE-INSTALL
- \* INSTALL AS TIGHT DOWNHILL AS ALLOWS
- \* INSTALL DEEP TO SHALLOW (210 IN)

- \* PLUMBING RECOMMENDATION - DO NOT RUN PLUMBING FROM SLDG THRU MIDDLE OF LOT
- \* CONCRETE LISTERS MAY BE REQUIRED IF TANK DEEPER THAN 6 IN
- \* ROUTE UTILITIES ALONG PROPERTY LINE FOR REPAIR

This drawing is for illustrative purposes only. System installation must meet all pertinent laws, rules, and regulations.

150'  
Harvell Road (SR 2008)