

TRUSS TO WALL CONNECTIONS, IF SHOWN, ARE FOR UPLIFT ONLY AND DO NOT CONSIDER LATERAL LOADS. ALL CONNECTORS ON THIS PROJECT ARE TO BE INSTALLED PER THE CONNECTOR MANUFACTURER'S SPECIFICATIONS. ALL CONNECTORS SHOWN THAT ARE NOT "TRUSS TO TRUSS" ARE SUGGESTIONS ONLY AND ARE TO BE VERIFIED BY THE BUILDING DESIGNER OR ENGINEER OF RECORD FOR SUITABILITY TO THIS PARTICULAR PROJECT. UFP MID-ATLANTIC, LLC. ACCEPTS NO RESPONSIBILITY FOR THE SPECIFIC APPLICATION OR SUITABILITY OF ANY CONNECTOR THAT IS NOT "TRUSS TO TRUSS" AS THEY APPLY TO THIS SPECIFIC STRUCTURE.

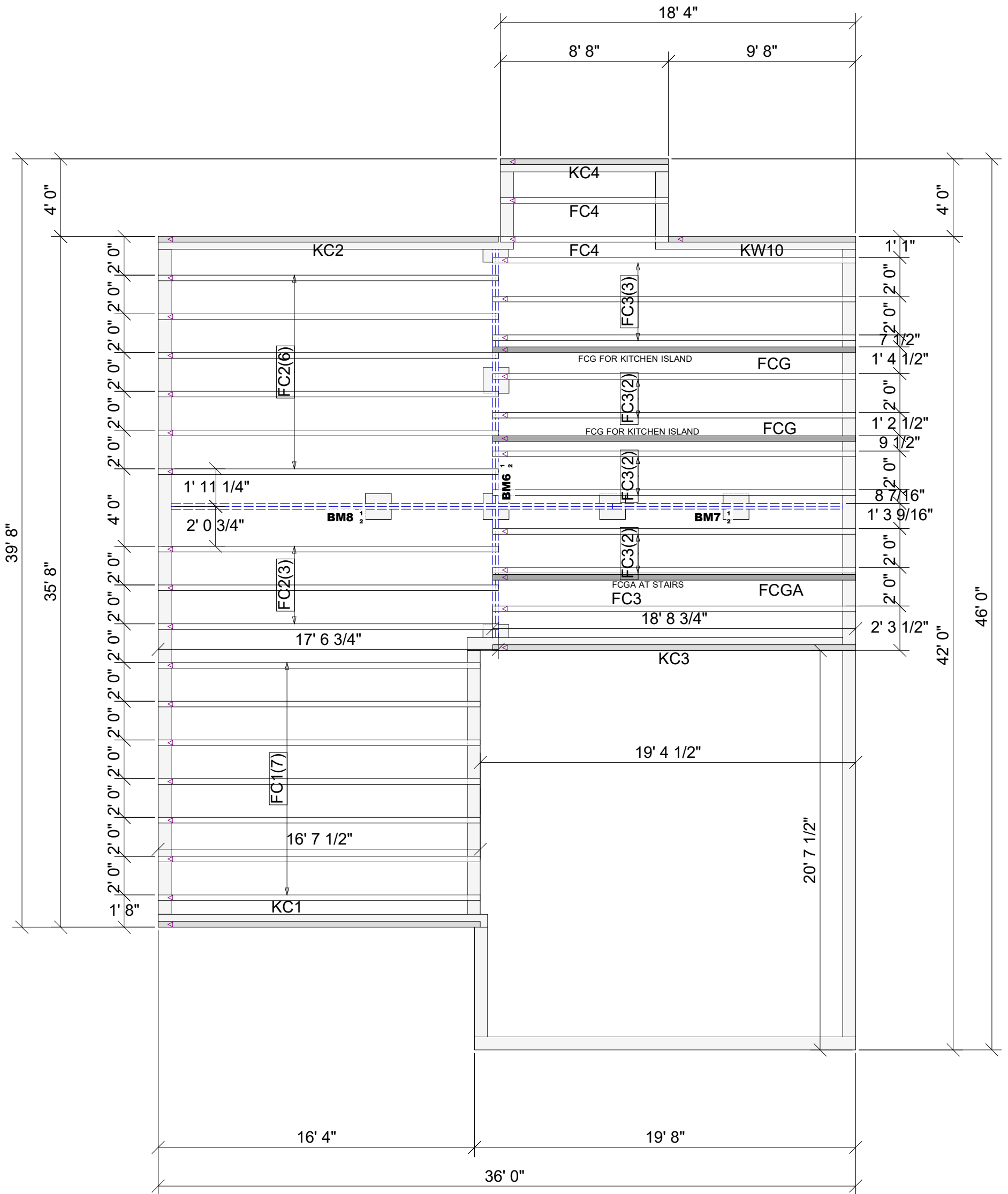

Products					
PlotID	Length	Product	Plies	Net Qty	Fab Type
BM6	22' 0"	1 3/4" x 9 1/4" 2.0E Microllam® LVL	2	2	MFD
BM8	24' 0"	1 3/4" x 14" 2.0E Microllam® LVL	2	2	MFD
BM7	12' 0"	1 3/4" x 14" 2.0E Microllam® LVL	2	2	MFD

### LOT 1126 ACC NELSON EURO CRAWL SPACE LAYOUT

ROOF AREA: 2460 \_ RIDGE LINE: 71.28 \_ VALLEY LINES: 59.59 \_ HIP LINES: 55.56 \_  $\triangle$  Indicates Left End of Truss

Customer  
**MCKEE HOMES**

Job Name  
**LOT 1126 ACC NELSON EURO  
LH LAYOUT**

Date: 9/3/2020  
Scale: NTS  
Revision Date 1:  
Revision Date 2:

Quality Products for Quality Builders



**UFP MID-ATLANTIC, LLC**  
A UFP INDUSTRIES COMPANY

BURLINGTON, NC PHONE (800) 476-9356  
CHESAPEAKE, VA PHONE (800) 476-3190  
CLINTON, NC PHONE (910) 590-3220  
CONWAY, SC PHONE (800) 397-9572  
JEFFERSON, GA PHONE (800) 648-4038  
LOCUST, NC PHONE (704) 888-0920  
LIBERTY, NC PHONE (800) 648-4038  
OOLTEWAH, TN PHONE (844) 497-0056  
PEARISBURG, VA PHONE (800) 397-9571

NOTES: THIS DRAWING IS THE PROPERTY OF UFP MID-ATLANTIC, LLC AND IS NOT TO BE USED FOR ANY PURPOSE DETRIMENTAL TO THE INTEREST OF UFP MID-ATLANTIC, LLC. THIS DRAWING MUST BE USED IN CONJUNCTION WITH ALL OTHER TECHNICAL DRAWINGS SUPPLIED BY UFP MID-ATLANTIC, LLC AND BRACING WOOD TRUSSES: COMMENTARY AND RECOMMENDATIONS AS PUBLISHED BY THE TRUSS PLATE INSTITUTE FOR INDUSTRY STANDARDS IN ERECTING TRUSSES. (TPI) IS LOCATED AT 583 D'ONOFRIO DR. SUITE 200 MADISON, WI 53719 (608) 833-5900

1. TEMPORARY BRACING TO BE INSTALLED w/T.P.I. STANDARD BCSI-B1.
2. SEE ENGINEERED DRAWING FOR PERMANENT BRACING MINIMUM REQUIREMENTS.
3. FRAMER TO VERIFY ALL DIMENSIONS, DROP, & RISE LOCATIONS PRIOR TO TRUSS PLACEMENT.
4. BLDR/FRAMER RESPONSIBLE FOR ADJUSTMENT OF TRUSS SPACING TO MISS PLUMBING DROPS, UNLESS NOTED OTHERWISE.
5. THIS LAYOUT IS NOT AN ENGINEERED DRAWING. THIS DRAWING WAS CREATED TO ESTABLISH TRUSS PLACEMENT ONLY. IT IS THE RESPONSIBILITY OF THE BUILDER TO PROVIDE ADEQUATE SUPPORT FOR ALL THE ELEMENTS SHOWN IN THIS DRAWING.