



2160 Satellite Blvd., Suite 450
Duluth, GA 30097
888-613-5078



Dealer
84 Lumber-Fayetteville #2307

Dealer Address
620 Belt Road
Fayetteville, NC 28301
(910) 867-9185

Project
CL2310 CP GL

Created
October 01, 2014

Layout Name
CL2310 CP GL

Description
Civness Land
CL2310 CP GL

Designer
Kyle Miltner

Revised
May 26, 2020

2nd Floor
Design Method
ASD (USA)

Floor
Design Method
IBC-IRC 2015

Dead
40

Deflection Joint
10

LL Span 1/

LL Span 2/

LL Cant 1/

LL Cant 2/

LL Span 1/

LL Span 2/

LL Cant 1/

LL Cant 2/

Decking
OSB

23/32 APA Rated Sturd-
F Floor

Fastener
Nailed & Glued

Legend

Point Load Support

Load from Above

3.5" Non-Brg Wall

5.5" Non-Brg Wall

Wall

Partition Wall (Non-Load-Bearing)

Wall Opening

1.5" APA Rated OSB 1.125 X 14

1.5" OSB 14

1.5" OSB 14

1.5" OSB 14

1.5" OSB 14

1.5" OSB 14

1.5" OSB 14

1.5" OSB 14

1.5" OSB 14

1.5" OSB 14

1.5" OSB 14

1.5" OSB 14

1.5" OSB 14

1.5" OSB 14

1.5" OSB 14

1.5" OSB 14

1.5" OSB 14

1.5" OSB 14

1.5" OSB 14

1.5" OSB 14

1.5" OSB 14

1.5" OSB 14

1.5" OSB 14

1.5" OSB 14

1.5" OSB 14

1.5" OSB 14

1.5" OSB 14

1.5" OSB 14

1.5" OSB 14

1.5" OSB 14

1.5" OSB 14

1.5" OSB 14

1.5" OSB 14

1.5" OSB 14

1.5" OSB 14

1.5" OSB 14

1.5" OSB 14

1.5" OSB 14

1.5" OSB 14

1.5" OSB 14

1.5" OSB 14

1.5" OSB 14

1.5" OSB 14

1.5" OSB 14

1.5" OSB 14

1.5" OSB 14

1.5" OSB 14

1.5" OSB 14

1.5" OSB 14

1.5" OSB 14

1.5" OSB 14

1.5" OSB 14

1.5" OSB 14

1.5" OSB 14

1.5" OSB 14

1.5" OSB 14

1.5" OSB 14

1.5" OSB 14

1.5" OSB 14

1.5" OSB 14

1.5" OSB 14

1.5" OSB 14

1.5" OSB 14

1.5" OSB 14

1.5" OSB 14

1.5" OSB 14

1.5" OSB 14

1.5" OSB 14

1.5" OSB 14

1.5" OSB 14

1.5" OSB 14

1.5" OSB 14

1.5" OSB 14

1.5" OSB 14

1.5" OSB 14

1.5" OSB 14

1.5" OSB 14

1.5" OSB 14

1.5" OSB 14

1.5" OSB 14

1.5" OSB 14

1.5" OSB 14

1.5" OSB 14

1.5" OSB 14

1.5" OSB 14

1.5" OSB 14

1.5" OSB 14

1.5" OSB 14

1.5" OSB 14

1.5" OSB 14

1.5" OSB 14

1.5" OSB 14

1.5" OSB 14

1.5" OSB 14

1.5" OSB 14

1.5" OSB 14

1.5" OSB 14

1.5" OSB 14

1.5" OSB 14

1.5" OSB 14

1.5" OSB 14

1.5" OSB 14

1.5" OSB 14

1.5" OSB 14

1.5" OSB 14

1.5" OSB 14

1.5" OSB 14

1.5" OSB 14

1.5" OSB 14

1.5" OSB 14

1.5" OSB 14

1.5" OSB 14

1.5" OSB 14

1.5" OSB 14

1.5" OSB 14

1.5" OSB 14

1.5" OSB 14

1.5" OSB 14

1.5" OSB 14

1.5" OSB 14

1.5" OSB 14

1.5" OSB 14

1.5" OSB 14

1.5" OSB 14

1.5" OSB 14

1.5" OSB 14

1.5" OSB 14

1.5" OSB 14

1.5" OSB 14

1.5" OSB 14

1.5" OSB 14

1.5" OSB 14

1.5" OSB 14

1.5" OSB 14

1.5" OSB 14

1.5" OSB 14

1.5" OSB 14

1.5" OSB 14

1.5" OSB 14

1.5" OSB 14

1.5" OSB 14

1.5" OSB 14

1.5" OSB 14

1.5" OSB 14

1.5" OSB 14

1.5" OSB 14

1.5" OSB 14

1.5" OSB 14

1.5" OSB 14

1.5" OSB 14

1.5" OSB 14

1.5" OSB 14

1.5" OSB 14

1.5" OSB 14

1.5" OSB 14

1.5" OSB 14

1.5" OSB 14

1.5" OSB 14

1.5" OSB 14

1.5" OSB 14

1.5" OSB 14

1.5" OSB 14

1.5" OSB 14

1.5" OSB 14

1.5" OSB 14

1.5" OSB 14

1.5" OSB 14

1.5" OSB 14

1.5" OSB 14

1.5" OSB 14

1.5" OSB 14

1.5" OSB 14

1.5" OSB 14

1.5" OSB 14

1.5" OSB 14

1.5" OSB 14

1.5" OSB 14

1.5" OSB 14

1.5" OSB 14

1.5" OSB 14

1.5" OSB 14

1.5" OSB 14

1.5" OSB 14

1.5" OSB 14

1.5" OSB 14

1.5" OSB 14

1.5" OSB 14

1.5" OSB 14

1.5" OSB 14

1.5" OSB 14

1.5" OSB 14

1.5" OSB 14

1.5" OSB 14

1.5" OSB 14

1.5" OSB 14

1.5" OSB 14

1.5" OSB 14

1.5" OSB 14

1.5" OSB 14

1.5" OSB 14

1.5" OSB 14

1.5" OSB 14

1.5" OSB 14

1.5" OSB 14

1.5" OSB 14

1.5" OSB 14

1.5" OSB 14

1.5" OSB 14

1.5" OSB 14

1.5" OSB 14

1.5" OSB 14

1.5" OSB 14

1.5" OSB 14

1.5" OSB 14

1.5" OSB 14

1.5" OSB 14

1.5" OSB 14

1.5" OSB 14

1.5" OSB 14

1.5" OSB 14

1.5" OSB 14

1.5" OSB 14

1.5" OSB 14

1.5" OSB 14

**THIS LAYOUT IS INTENDED FOR THE PURPOSE OF TRUSS LOCATION AND PLACEMENT ONLY.
REFER TO THE BUILDING PLANS FOR ACTUAL BUILDING CONSTRUCTION.**

GENERAL NOTES:
 DO NOT CUT OR MODIFY TRUSSES
 TRUSSES ARE SPACED 24" ON CENTER UNLESS NOTED OTHERWISE.
 REFER TO THE INDIVIDUAL TRUSS DESIGN DRAWINGS FOR THE LOCATION OF LATERAL BRACING AND MULTI-PLY CONNECTION REQUIREMENTS.
 PER ANSI TPI 1-2002 THE TRUSS ENGINEER IS RESPONSIBLE FOR TRUSS TO TRUSS CONNECTIONS AND TRUSS PLY TO PLY CONNECTIONS. THIS TRUSS LAYOUT PLAN RECOMMENDS TRUSS TO BEARING CONNECTIONS AND TRUSS TO BEAM CONNECTIONS WHICH SHALL BE REVIEWED BY THE BUILDING DESIGNER. IT IS THE RESPONSIBILITY OF THE BUILDING DESIGNER TO RESOLVE ALL ROOF FORCES ADEQUATELY TO THE FOUNDATION.

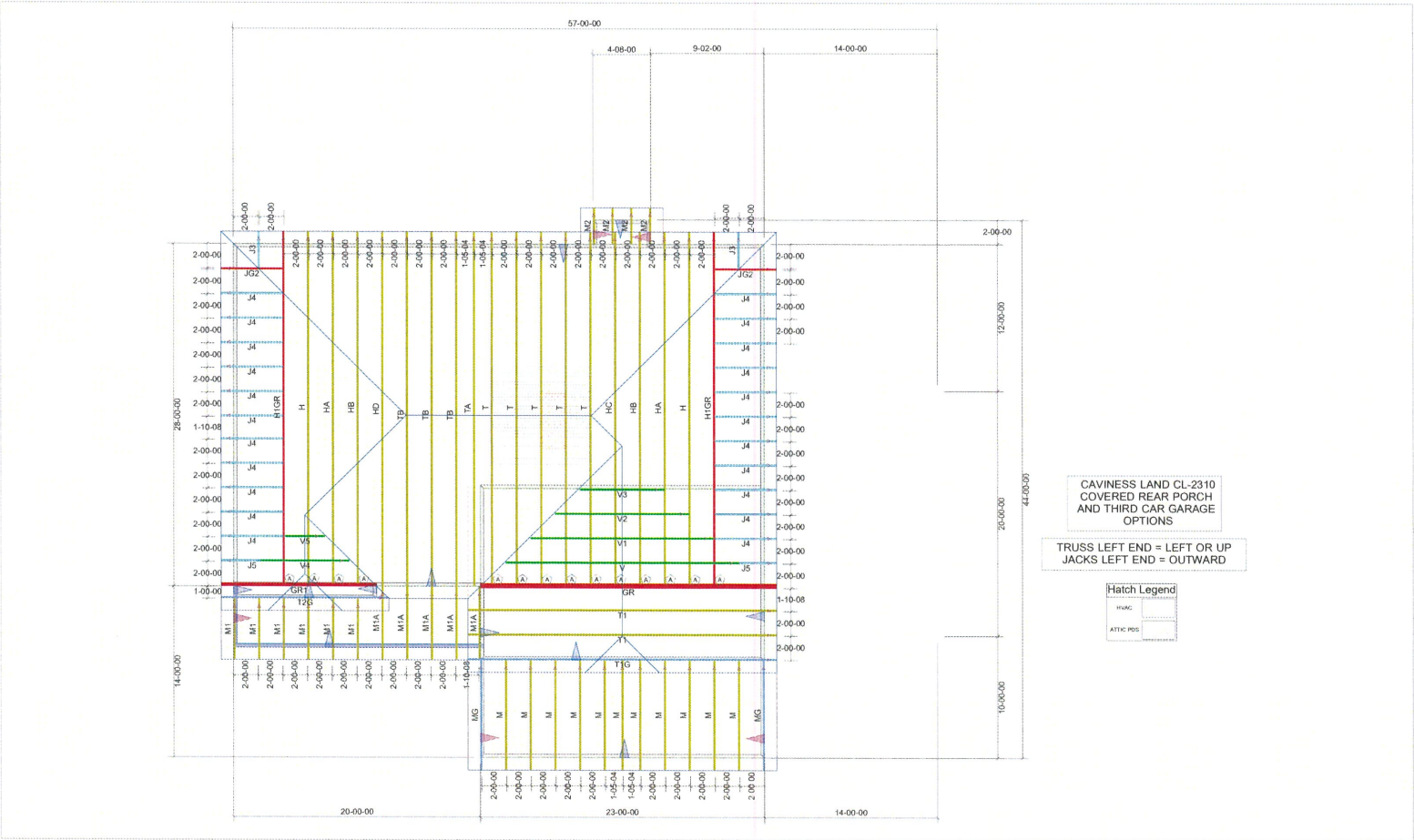

CAVINESS LAND CL-2310
 COVERED REAR PORCH
 AND THIRD CAR GARAGE
 OPTIONS
 TRUSS LEFT END = LEFT OR UP
 JACKS LEFT END = OUTWARD

	HVAC
	ATTIC FLOOR

Hardware List:		
A	14	HUS26

ROOF LOADING:
TOP LIVE: 20 PSF
TOP DEAD: 10 PSF
BOTTOM DEAD: 10 PSF
WIND SPEED: 115 MPH



DEDICATED TO QUALITY AND EXCELLENCE
 200 EMMETT ROAD
 DUNN, NORTH CAROLINA 28334
 PHONE: 910-892-8400

PROJECT:	Caviness Land		
CUSTOMER:	CL-2310 CP GOR		
MODEL:	SCALE:	P.O. NUMBER:	ORDER:
	NOT TO SCALE	31500	11470
DRAWN BY:	PRINT DATE:	REV:	SHIP DATE:
JK	/ /	7/18/16	