

Harnett County Department of Public Health

Improvement Permit

A building permit cannot be issued with only an Improvement Permit

ISSUED TO: ALAN CANADY GLDS PROPERTY LOCATION: 786 LENNIE SMITH ROAD (S21428)
 SUBDIVISION _____ LOT # _____
 NEW REPAIR EXPANSION
 Type of Structure: 3-BEDROOM 65' X 68' SFD
 Proposed Wastewater System Type: 25% REDUCTION SYS.
 Projected Daily Flow: 360 GPD
 Number of bedrooms: 3 Number of Occupants: 6 max
 Basement Yes No
 Pump Required: Yes No May be required based on final location and elevations of facilities
 Type of Water Supply: Community Public Well Distance from well NA feet
 Permit valid for: Five years No expiration
 Permit conditions: _____
 Authorized State Agent: [Signature] Date: 11/12/2020 SEE ATTACHED SITE SKETCH

The issuance of this permit by the Health Department in no way guarantees the issuance of other permits. The permit holder is responsible for checking with appropriate governing bodies in meeting their requirements. This site is subject to revocation if the site plan, plat, or the intended use changes. The Improvement Permit shall not be affected by a change in ownership of the site. This permit is subject to compliance with the provisions of the Laws and Rules for Sewage Treatment and Disposal and to conditions of this permit.

Construction Authorization

(Required for Building Permit)

The construction and installation requirements of Rules .1950, .1952, .1954, .1955, .1956, .1957, .1958, and .1959 are incorporated by references into this permit and shall be met. Systems shall be installed in accordance with the attached system layout.

ISSUED TO: ALAN CANADY GLDS PROPERTY LOCATION: 786 LENNIE SMITH RD. (S21428)
 SUBDIVISION _____ LOT # _____
 Facility Type: 302 65' X 68' SFD New Expansion Repair
 Basement? Yes No Basement Fixtures? Yes No
 Type of Wastewater System** 25% REDUCTION SYSTEM (Initial) Wastewater Flow: 360 GPD
 (See note below, if applicable 25% REDUCTION SYS. (Repair)
 Installation Requirements/Conditions
 Septic Tank Size 1200 gallons
 Pump Tank Size 1200 gallons
 Number of trenches 3
 Exact length of each trench 90 feet
 Trenches shall be installed on contour at a Maximum Trench Depth of: 24 inches
 (Trench bottoms shall be level to +/- 1/4" in all directions)
 Trench Spacing: 9 Feet on Center
 Soil Cover: 12 inches
 (Maximum soil cover shall not exceed 36" above the trench bottom)
 Pump Requirements: _____ ft. TDH vs. _____ GPM
 Aggregate Depth: NA inches below pipe
NA inches above pipe
NA inches total
 Conditions: GRAVITY TO D-BOX EQUAL DISTRIBUTION

**WATER LINES (INCLUDING IRRIGATION) MUST BE 10FT. FROM ANY PART OF SEPTIC SYSTEM OR REPAIR AREA.
 NO UTILITIES ALLOWED IN INITIAL OR REPAIR DRAIN FIELD AREA.**

***If applicable: I understand the system type specified is different from the type specified on the application. I accept the specifications of this permit.*

Owner/Legal Representative Signature: _____ Date: _____

This Construction Authorization is subject to revocation if the site plan, plat, or the intended use changes. The Construction Authorization shall not be transferred when there is a change in ownership of the site. This Construction Authorization is subject to compliance with the provisions of the Laws and Rules for Sewage Treatment and Disposal and to the conditions of this permit. SEE ATTACHED SITE SKETCH

Authorized State Agent: [Signature] Date: 11/12/2020
ANDREW CURRAN Construction Authorization Expiration Date: 11/12/2025

Application # SFD 2009-000411

Harnett County Department of Public Health Site Sketch

Property Location: 786 LENNIE SMITH ROAD (S11428)

Issued To: ALAN CANADY BUDS Subdivision _____ Lot # _____

Authorized State Agent: [Signature] Date: 11/10/2020

ADDRESS CORRIDOR

11/12/2020

* GRAVITY TO B-BOX
(EQUAL DISTRIBUTION)

OWNER REQUEST

GARBAGE DISPOSAL:

* RISERS SHALL BE PRESENT ON
BOTH ENDS OF TANK [REQUIRED]

* NO NON-FOOD WASTE DOWN DISPOSAL

* TANK MAY REQUIRE PUMPING MORE
THAN STANDARD; MANUFACTURER
RECOMMENDATION [3.5 TDS]

* GARBAGE DISPOSAL IS NOT
ADVISED BUT PERMISSIBLE

* LARGER TANK [250 GAL] REQUIRED
TO INCREASE CAPACITY

LINE

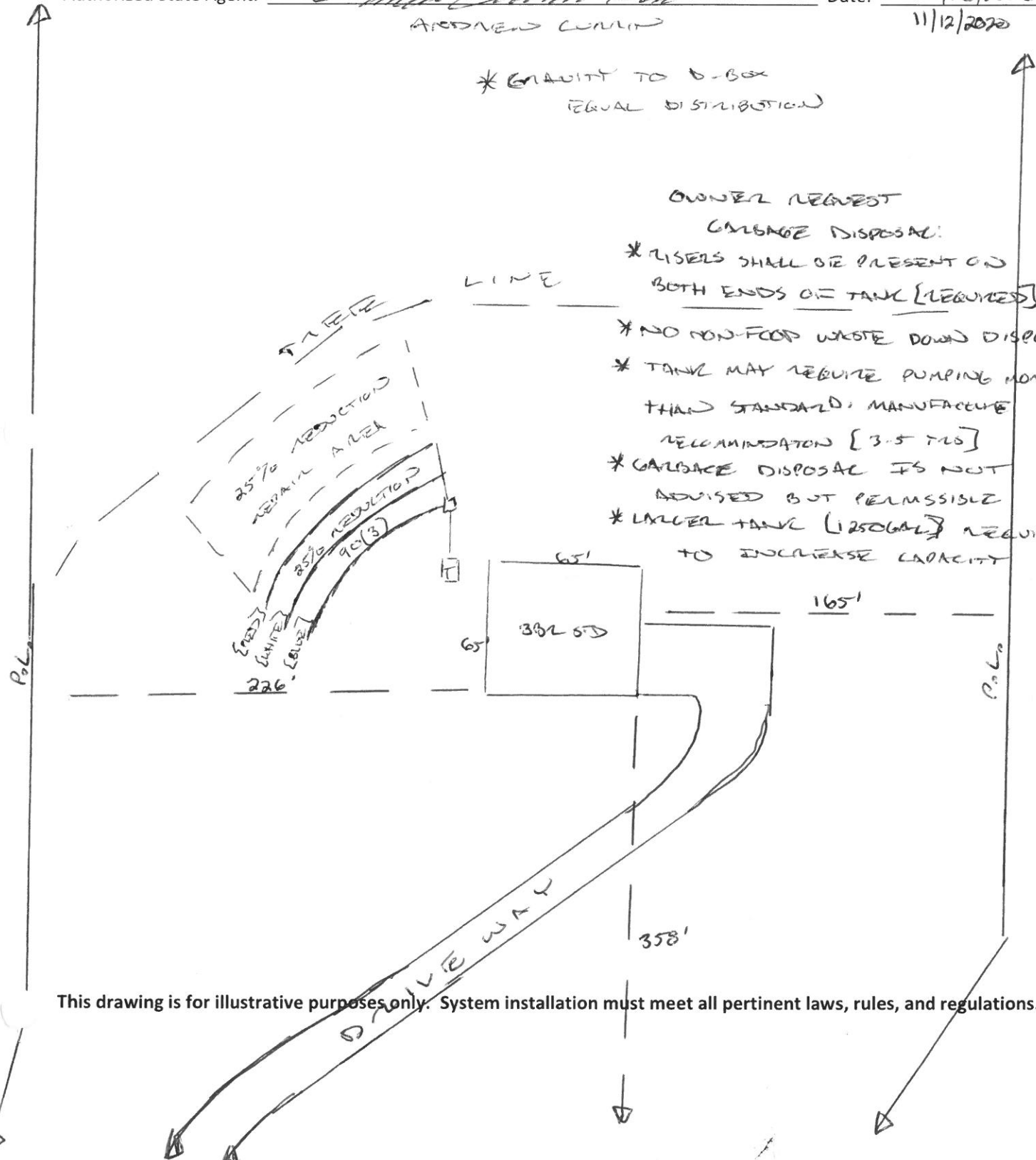

This drawing is for illustrative purposes only. System installation must meet all pertinent laws, rules, and regulations.