

Harnett County Department of Public Health Improvement Permit

A building permit cannot be issued with only an Improvement Permit

ISSUED TO: Dan Ryan Builders - North Carolina, L SUBDIVISION Olde Mill Village LOT # 27
 PROPERTY LOCATION: 433 Village Bend Dr. (Rawls Ch. Rd. - SR
 NEW REPAIR EXPANSION Site Improvements required prior to Construction Authorization Issuance:
 Type of Structure: 40x60 sfd, 4 beds 3 baths
 Proposed Wastewater System Type: 25% Reduction System
 Projected Daily Flow: 480 GPD
 Number of bedrooms: 4 Number of Occupants: 8 max
 Basement Yes No
 Pump Required: Yes No May be required based on final location and elevations of facilities
 Type of Water Supply: Community Public Well Distance from well NA feet Permit valid for: Five years
 Permit conditions: No expiration

Authorized State Agent: [Signature] Date: 09/24/2020 SEE ATTACHED SITE SKETCH
 The issuance of this permit by the Health Department in no way guarantees the issuance of other permits. The permit holder is responsible for checking with appropriate governing bodies in meeting their requirements. This site is subject to revocation if the site plan, plat, or the intended use changes. The Improvement Permit shall not be affected by a change in ownership of the site. This permit is subject to compliance with the provisions of the Laws and Rules for Sewage Treatment and Disposal and to conditions of this permit.

Construction Authorization

(Required for Building Permit)

The construction and installation requirements of Rules 1950, 1952, 1954, 1955, 1956, 1957, 1958 and 1959 are incorporated by references into this permit and shall be met. Systems shall be installed in accordance with the attached system layout.

ISSUED TO: Dan Ryan Builders - North Carolina PROPERTY LOCATION: 433 Village Bend Dr. (Rawls Ch. Rd. - S
 SUBDIVISION Olde Mill Village LOT # 27
 Facility Type: 40x60 sfd, 4 beds 3 baths New Expansion Repair
 Basement? Yes No Basement Fixtures? Yes No
 Type of Wastewater System** 25% Reduction System (Initial) Wastewater Flow: 480 GPD
 (See note below, if applicable
25% Reduction System (Repair)
Installation Requirements/Conditions
 Septic Tank Size 1000 gallons Exact length of each trench 100 feet Trench Spacing: 9 Feet on Center
 Pump Tank Size _____ gallons Trenches shall be installed on contour at a Soil Cover: 12 inches
 Maximum Trench Depth of: 24 inches (Maximum soil cover shall not exceed
 (Trench bottoms shall be level to +/-1/4" 36" above the trench bottom)
 in all directions)
 Pump Requirements: _____ ft. TDH vs. _____ GPM Aggregate Depth: NA inches below pipe
 _____ inches above pipe
 Conditions: Gravity to D-Box Equal Dist.; Proposal by Adams Soil Consulting NA inches total

**WATER LINES (INCLUDING IRRIGATION) MUST BE 10FT. FROM ANY PART OF SEPTIC SYSTEM OR REPAIR AREA.
 NO UTILITIES ALLOWED IN INITIAL OR REPAIR DRAIN FIELD AREA.**

**If applicable: I understand the system type specified is different from the type specified on the application. I accept the specifications of this permit.

Owner/Legal Representative Signature: _____ Date: _____

This Construction Authorization is subject to revocation if the site plan, plat, or the intended use changes. The Construction Authorization shall not be transferred when there is a change in ownership of the site. This Construction Authorization is subject to compliance with the provisions of the Laws and Rules for Sewage Treatment and Disposal and to the conditions of this permit. SEE ATTACHED SITE SKETCH

Authorized State Agent: [Signature] Date: 09/24/2020
ANDREW CORWIN Construction Authorization Expiration Date: 09/24/2025

Application # SFD2008-0083

Harnett County Department of Public Health Site Sketch

Property Location: 433 Village Bend Dr (Rawls Ch. Rd. - SR 1415)

Issued To: Dan Ryan Builders - North Carolina, LLC Subdivision Olde Mill Village Lot # 27

Authorized State Agent: *Andrew Curran* Date: 09/24/2020
ANDREW CURRAN

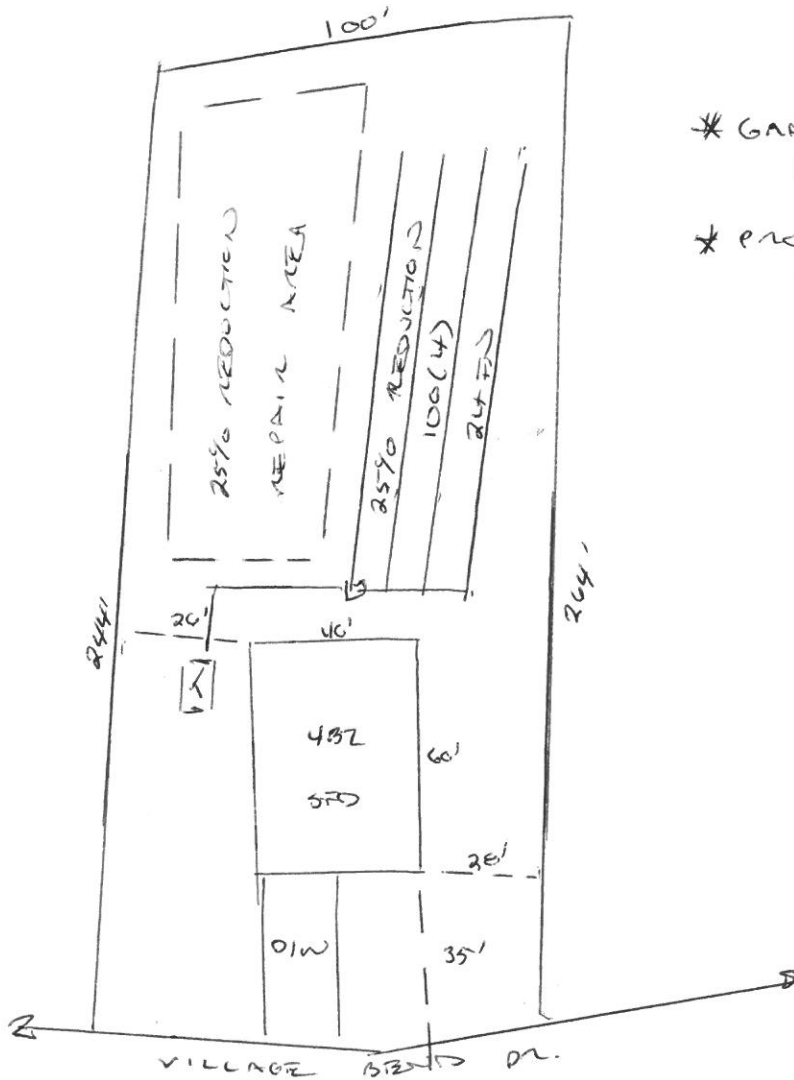

- * GRAVITY TO D-BOX
EQUAL DISTRIBUTION
- * PROPOSAL BY ADAMS
SOIL CONSULTING

This drawing is for illustrative purposes only. System installation must meet all pertinent laws, rules, and regulations.

Olde Mill Village 4-Bedroom Septic Proposal Lot #27

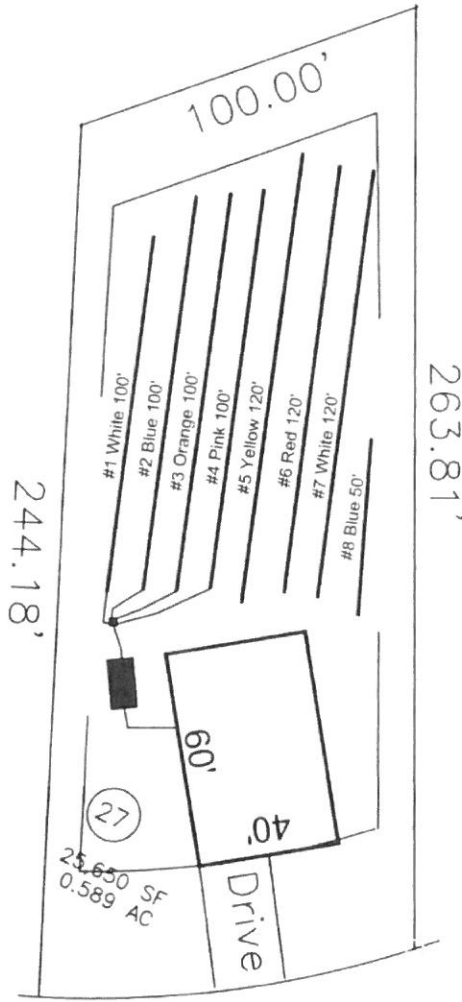

If plumbing is not sufficient a pump and tank may be required to septic drain field.

*Preliminary Design
Not a Permit

System: Pressure Manifold
Lines: 1-4 (400')
0.3 LTAR
24" Trench Bottom
Accepted Status System
Repair: Pressure Manifold
Lines: 5-8 (400')
0.3 LTAR
24" Trench Bottom
Accepted Status System

Village Bend Drive
50' Public R/W

GRAPHIC SCALE
1" = 50'



Adams
Soil Consulting
919-414-6761
Job #699