

# Olde Mill Village 4-Bedroom Septic Proposal Lot #21

System: Gravity to D-Box  
 Lines: 1-3 (405')  
 0.3 LTAR  
 24" Trench Bottom  
 Accepted Status System  
 Repair: Gravity to D-Box  
 Lines: 4-6 (400')  
 0.4 LTAR  
 18" Trench Bottom  
 Accepted Status System

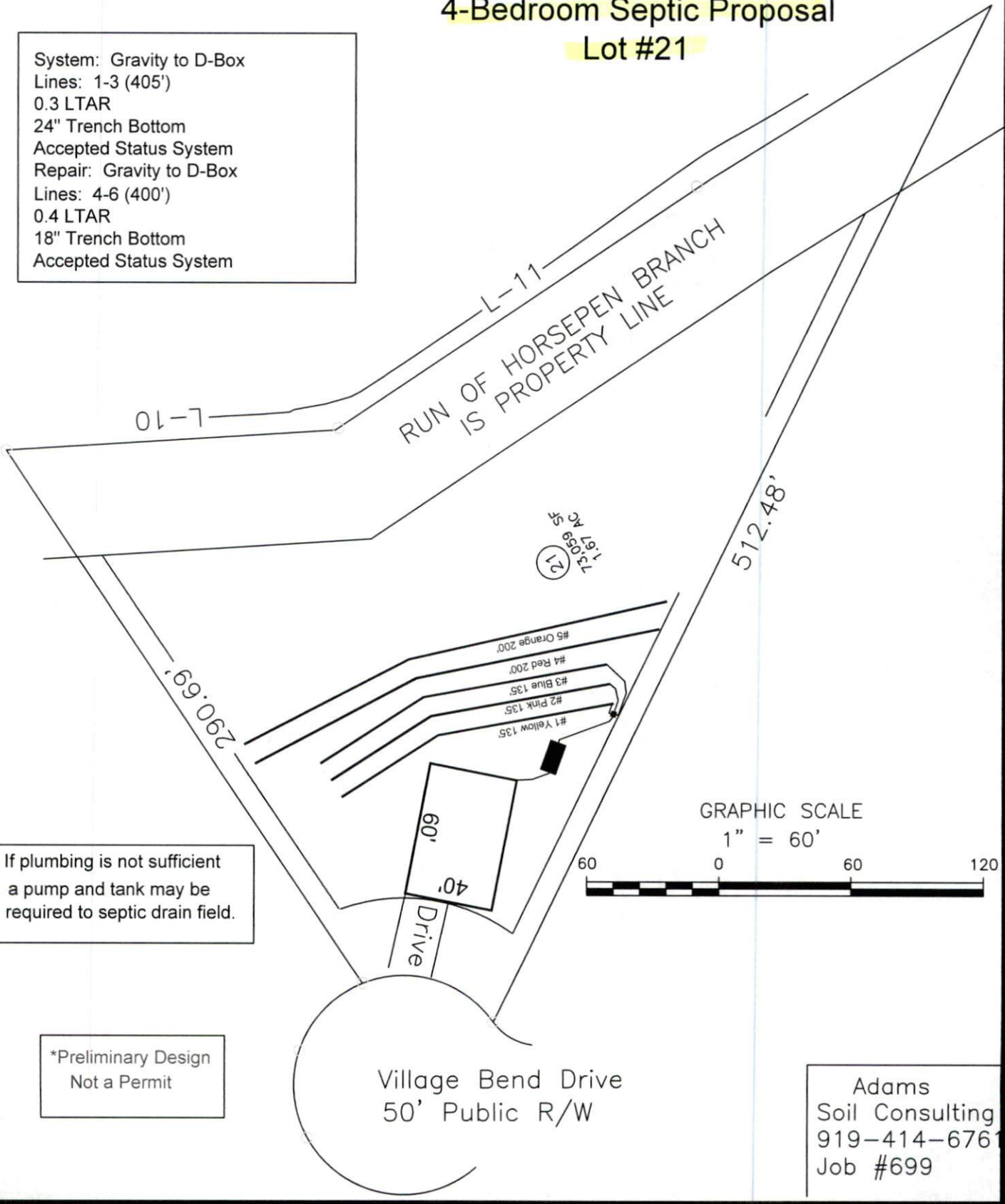

If plumbing is not sufficient  
 a pump and tank may be  
 required to septic drain field.

\*Preliminary Design  
 Not a Permit

Adams  
 Soil Consulting  
 919-414-6761  
 Job #699