

Harnett County Department of Public Health Improvement Permit

A building permit cannot be issued with only an Improvement Permit

PROPERTY LOCATION: 436 Village Bend Dr. (Rawls Ch. Rd. - SR

ISSUED TO: Dan Ryan Builders - North Carolina, L SUBDIVISION Olde Mill Village LOT # 18

NEW ^{54' x 51'} REPAIR EXPANSION
Type of Structure: 40x60 sfd, 4 beds 3 baths

Site Improvements required prior to Construction Authorization Issuance:

Proposed Wastewater System Type: 25% Reduction System

Projected Daily Flow: 480 GPD

Number of bedrooms: 4 Number of Occupants: 8 max

Basement Yes No

Pump Required: Yes No May be required based on final location and elevations of facilities

Type of Water Supply: Community Public Well Distance from well NA feet

Permit valid for: Five years
 No expiration

Permit conditions: _____

Authorized State Agent: _____

Date: 03/05/2021
~~10/12/2020~~ ^{AK}

SEE ATTACHED SITE SKETCH

The issuance of this permit by the Health Department in no way guarantees the issuance of other permits. The permit holder is responsible for checking with appropriate governing bodies in meeting their requirements. This site is subject to revocation if the site plan, plat, or the intended use changes. The Improvement Permit shall not be affected by a change in ownership of the site. This permit is subject to compliance with the provisions of the Laws and Rules for Sewage Treatment and Disposal and to conditions of this permit.

Construction Authorization

(Required for Building Permit)

The construction and installation requirements of Rules .1950, .1952, .1954, .1955, .1956, .1957, .1958, and .1959 are incorporated by references into this permit and shall be met. Systems shall be installed in accordance with the attached system layout.

ISSUED TO: Dan Ryan Builders - North Carolina

PROPERTY LOCATION: 436 Village Bend Dr. (Rawls Ch. Rd. - S

SUBDIVISION Olde Mill Village LOT # 18

Facility Type: ^{54' x 50'} 40x60 sfd, 4 beds 3 baths New Expansion Repair

Basement? Yes No Basement Fixtures? Yes No

Type of Wastewater System** 25% Reduction System (Initial) Wastewater Flow: 480 ^{AK} ~~360~~ GPD

(See note below, if applicable)

25% Reduction System (Repair)

Installation Requirements/Conditions

Septic Tank Size 1000 gallons

Pump Tank Size _____ gallons

Number of trenches 4

Exact length of each trench 100 (step) feet

Trenches shall be installed on contour at a

Maximum Trench Depth of: 45 1/8 ^{AK} inches

(Trench bottoms shall be level to +/- 1/4"

in all directions)

Trench Spacing: 9 Feet on Center

Soil Cover: 6 import ^{AK} inches

(Maximum soil cover shall not exceed

36" above the trench bottom)

Pump Requirements: _____ ft. TDH vs. _____ GPM

NA inches below pipe

Aggregate Depth: NA inches above pipe

Conditions: Gravity to D-Box Equal Dist.; Proposal by Adams Soil Consulting NA inches total

**WATER LINES (INCLUDING IRRIGATION) MUST BE 10FT. FROM ANY PART OF SEPTIC SYSTEM OR REPAIR AREA.
NO UTILITIES ALLOWED IN INITIAL OR REPAIR DRAIN FIELD AREA.**

**If applicable: I understand the system type specified is different from the type specified on the application. I accept the specifications of this permit.

Owner/Legal Representative Signature: _____

Date: _____

This Construction Authorization is subject to revocation if the site plan, plat, or the intended use changes. The Construction Authorization shall not be transferred when there is a change in ownership of the site. This

Construction Authorization is subject to compliance with the provisions of the Laws and Rules for Sewage Treatment and Disposal and to the conditions of this permit.

SEE ATTACHED SITE SKETCH

Authorized State Agent: _____

Date: AK ~~10/12/2020~~ ^{AK} 03/05/2021

ANDREW CURRAN

Construction Authorization Expiration Date: ~~10/12/2025~~ ^{AK} 03/05/2025

Application # SFD2008-0074

Harnett County Department of Public Health Site Sketch

Property Location: 436 Village Bend Dr (Rawls Ch. Rd. - SR 1415)

Issued To: Dan Ryan Builders - North Carolina, LLC Subdivision Olde Mill Village

Lot # 18

Authorized State Agent:

[Signature]
ANDREW CORWIN

Date:

~~10/2/2020~~
03/05/2021

- * GRAVITY TO D-BOX
EQUAL DISTRIBUTION
- * STEPDOWNS PRESENT
@ MIDPOINT W/
100FT TRENCH
- * PROPOSED BY ADAMS
SOIL CONSULTING

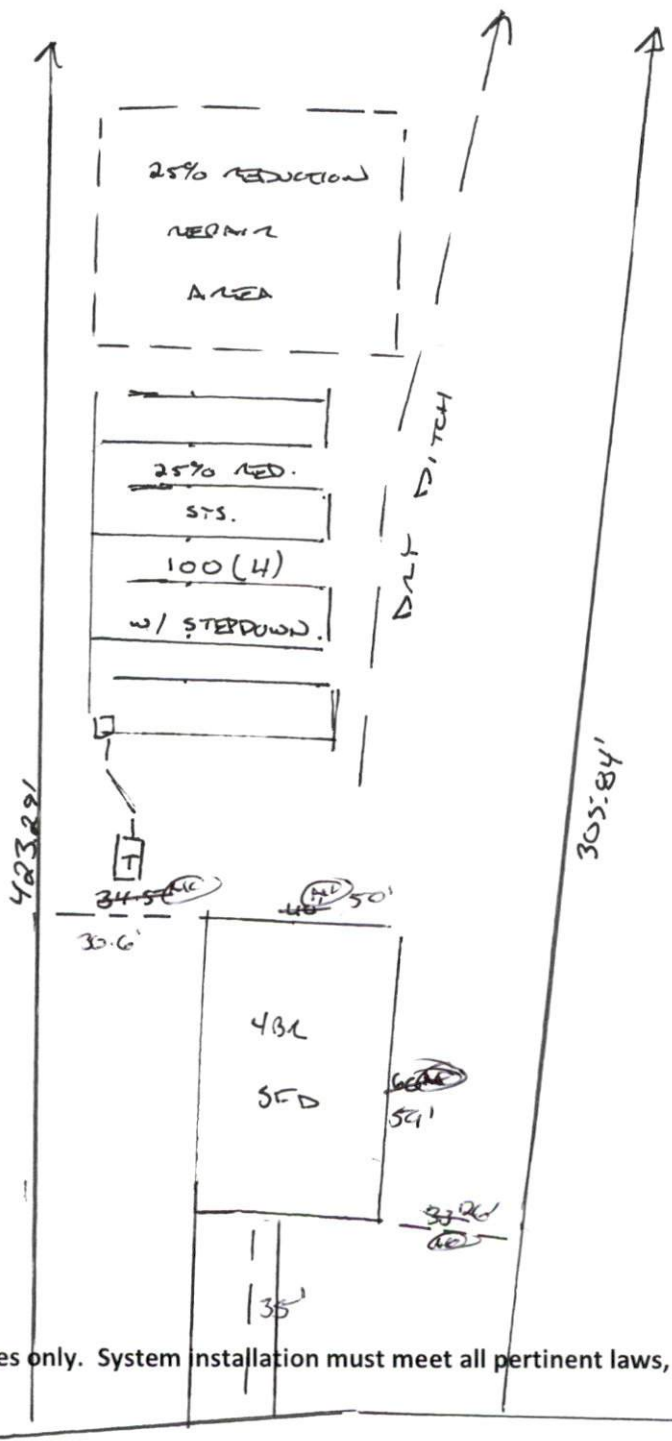

This drawing is for illustrative purposes only. System installation must meet all pertinent laws, rules, and regulations.

Olde Mill Village
 4-Bedroom Septic Proposal
 Lot #18

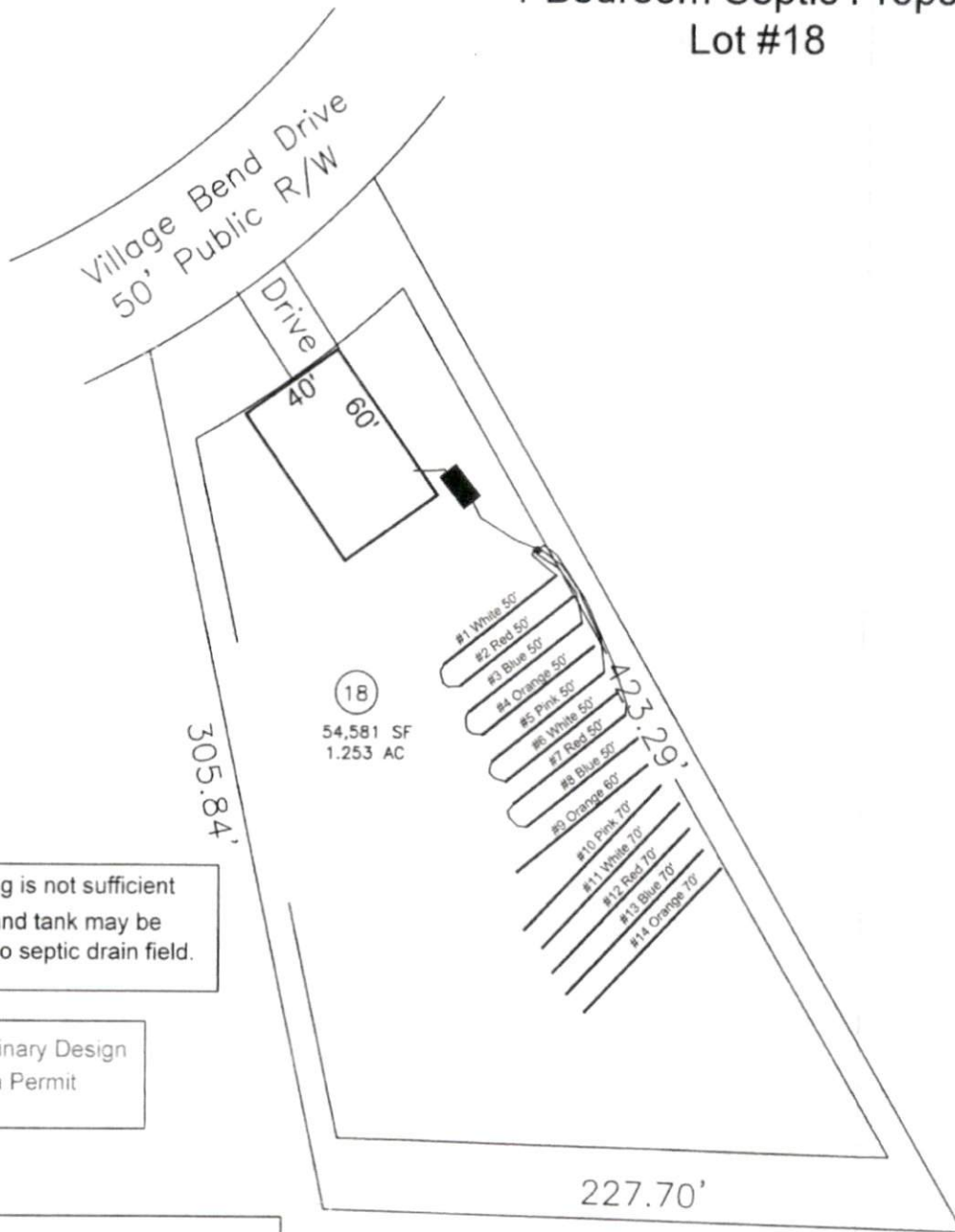

If plumbing is not sufficient
 a pump and tank may be
 required to septic drain field.

*Preliminary Design
 Not a Permit

System: Gravity to D-Box
 Lines: 1-8 (400')
 0.3 LTAR
 15" Trench Bottom
 Accepted Status System
 Repair: Pressure Manifold
 Lines: 9-14 (400')
 0.3 LTAR
 15" Trench Bottom
 Accepted Status System

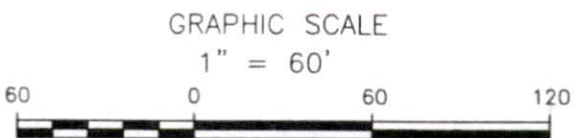

Adams
 Soil Consulting
 919-414-6761
 Job #699