

# Olde Mill Village 4-Bedroom Septic Proposal Lot #18

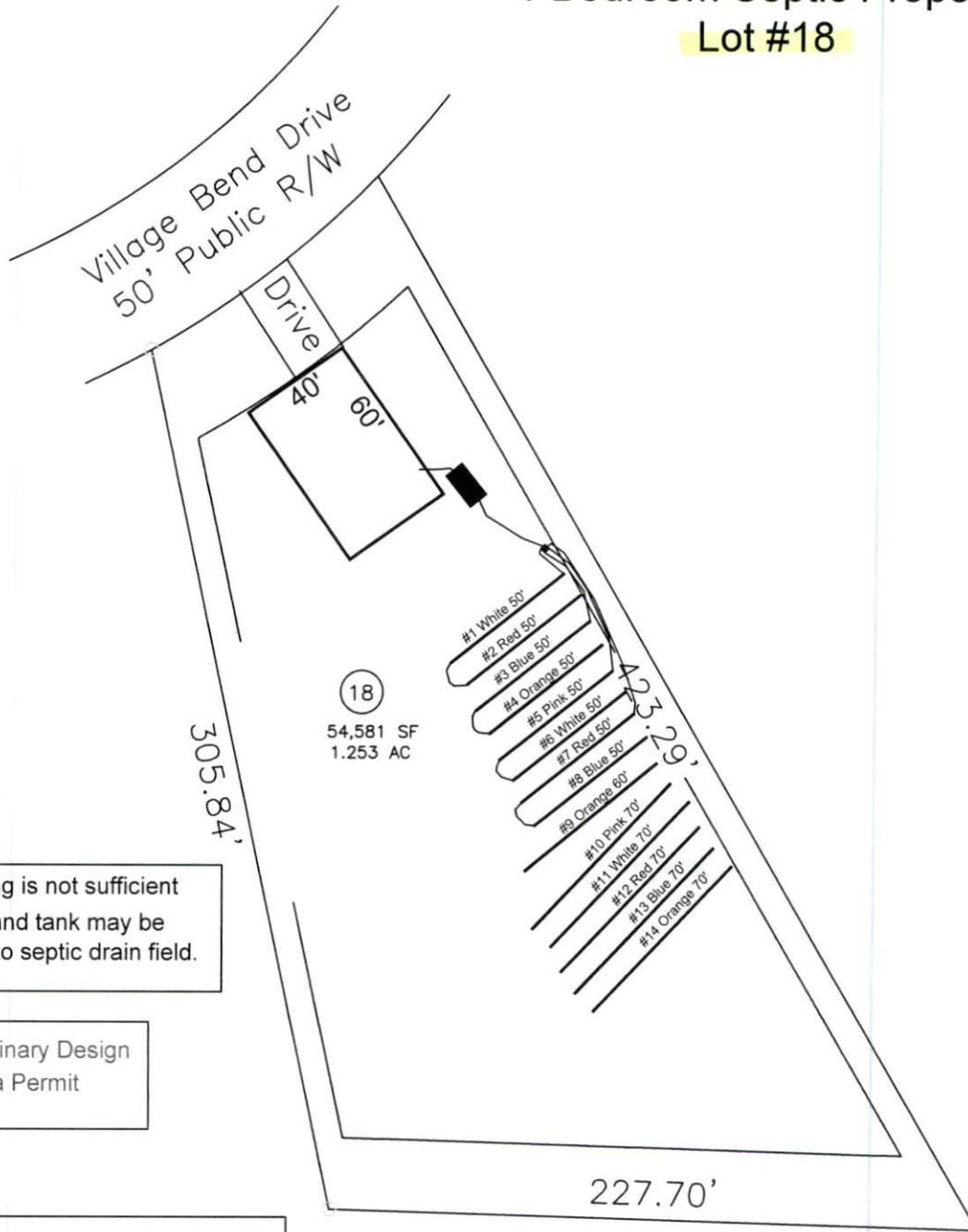

If plumbing is not sufficient  
a pump and tank may be  
required to septic drain field.

\*Preliminary Design  
Not a Permit

System: Gravity to D-Box  
Lines: 1-8 (400')  
0.3 LTAR  
15" Trench Bottom  
Accepted Status System  
Repair: Pressure Manifold  
Lines: 9-14 (400')  
0.3 LTAR  
15" Trench Bottom  
Accepted Status System

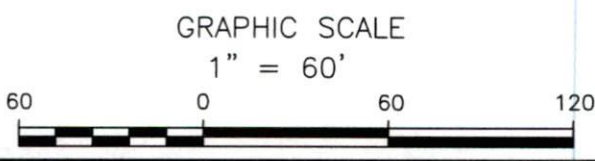

Adams  
Soil Consulting  
919-414-6761  
Job #699