

Harnett County Department of Public Health Improvement Permit

A building permit cannot be issued with only an Improvement Permit

PROPERTY LOCATION: 402 Village Bend Dr. (Rawls Ch. Rd. - SR
SUBDIVISION Olde Mill Village LOT # 16

ISSUED TO: Dan Ryan Builders - North Carolina, L

NEW REPAIR EXPANSION Site Improvements required prior to Construction Authorization Issuance: _____

Type of Structure: 40x60 sfd, 4 beds 3 baths

Proposed Wastewater System Type: 25% Reduction System

Projected Daily Flow: 480 GPD

Number of bedrooms: 4 Number of Occupants: 8 max

Basement Yes No

Pump Required: Yes No May be required based on final location and elevations of facilities

Type of Water Supply: Community Public Well Distance from well NA feet Permit valid for: Five years
 No expiration

Permit conditions: _____

Authorized State Agent:  Date: 09/22/2020 SEE ATTACHED SITE SKETCH

The issuance of this permit by the Health Department in no way guarantees the issuance of other permits. The permit holder is responsible for checking with appropriate governing bodies in meeting their requirements. This site is subject to revocation if the site plan, plat, or the intended use changes. The Improvement Permit shall not be affected by a change in ownership of the site. This permit is subject to compliance with the provisions of the Laws and Rules for Sewage Treatment and Disposal and to conditions of this permit.

Construction Authorization

(Required for Building Permit)

The construction and installation requirements of Rules 1950, 1952, 1954, 1955, 1956, 1957, 1958, and 1959 are incorporated by references into this permit and shall be met. Systems shall be installed in accordance with the attached system layout.

ISSUED TO: Dan Ryan Builders - North Carolina PROPERTY LOCATION: 402 Village Bend Dr. (Rawls Ch. Rd. - S
SUBDIVISION Olde Mill Village LOT # 16

Facility Type: 40x60 sfd, 4 beds 3 baths New Expansion Repair

Basement? Yes No Basement Fixtures? Yes No

Type of Wastewater System** 25% Reduction System (Initial) Wastewater Flow: 480 GPD
(See note below, if applicable 25% Reduction System (Repair)

Installation Requirements/Conditions

| | | | |
|--------------------------------------|---|---|---|
| Septic Tank Size <u>1000</u> gallons | Number of trenches <u>4</u> | Exact length of each trench <u>100</u> feet | Trench Spacing: <u>9</u> Feet on Center |
| Pump Tank Size _____ gallons | Trenches shall be installed on contour at a | Maximum Trench Depth of: <u>24</u> inches | Soil Cover: <u>12</u> inches |
| | (Trench bottoms shall be level to +/- 1/4" in all directions) | (Maximum soil cover shall not exceed 36" above the trench bottom) | |

Pump Requirements: _____ ft. TDH vs. _____ GPM Aggregate Depth: NA inches below pipe
NA inches above pipe
Conditions: Gravity to D-Box Equal Distribution; Proposal by Adams Soil Const NA inches total

**WATER LINES (INCLUDING IRRIGATION) MUST BE 10FT. FROM ANY PART OF SEPTIC SYSTEM OR REPAIR AREA.
NO UTILITIES ALLOWED IN INITIAL OR REPAIR DRAIN FIELD AREA.**

***If applicable: I understand the system type specified is different from the type specified on the application. I accept the specifications of this permit.*

Owner/Legal Representative Signature: _____ Date: _____

This Construction Authorization is subject to revocation if the site plan, plat, or the intended use changes. The Construction Authorization shall not be transferred when there is a change in ownership of the site. This Construction Authorization is subject to compliance with the provisions of the Laws and Rules for Sewage Treatment and Disposal and to the conditions of this permit. SEE ATTACHED SITE SKETCH

Authorized State Agent:  Date: 09/22/2020
ANDREW CURRAN Construction Authorization Expiration Date: 09/22/2025

Harnett County Department of Public Health Site Sketch

Property Location: 402 Village Bend Dr (Rawls Ch. Rd. - SR 1415)

Issued To: Dan Ryan Builders - North Carolina, LLC Subdivision Olde Mill Village Lot # 16

Authorized State Agent: *Steve Cummings, NCHS* Date: 09/22/2008

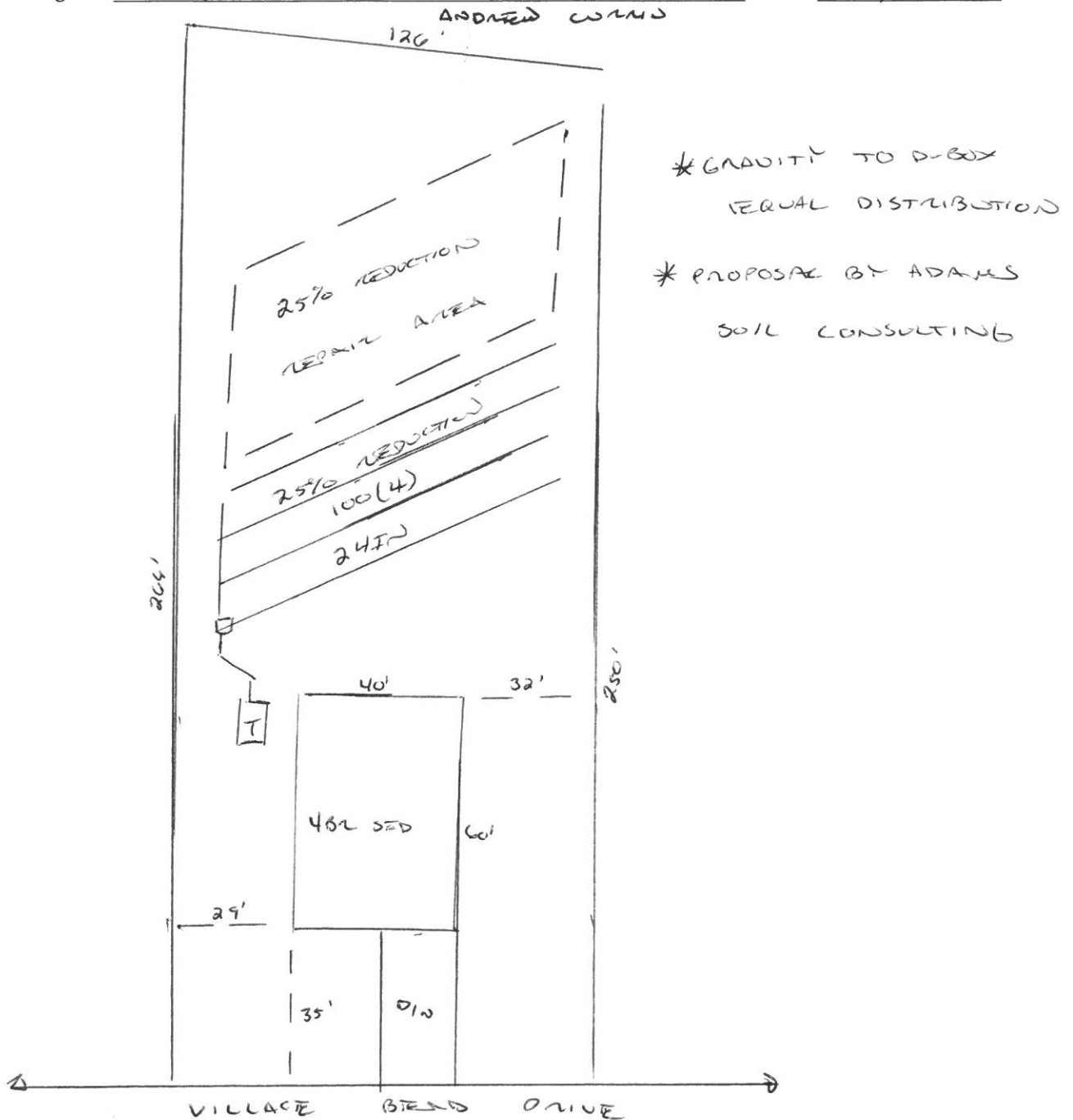

This drawing is for illustrative purposes only. System installation must meet all pertinent laws, rules, and regulations.

Olde Mill Village 4-Bedroom Septic Proposal Lot #16

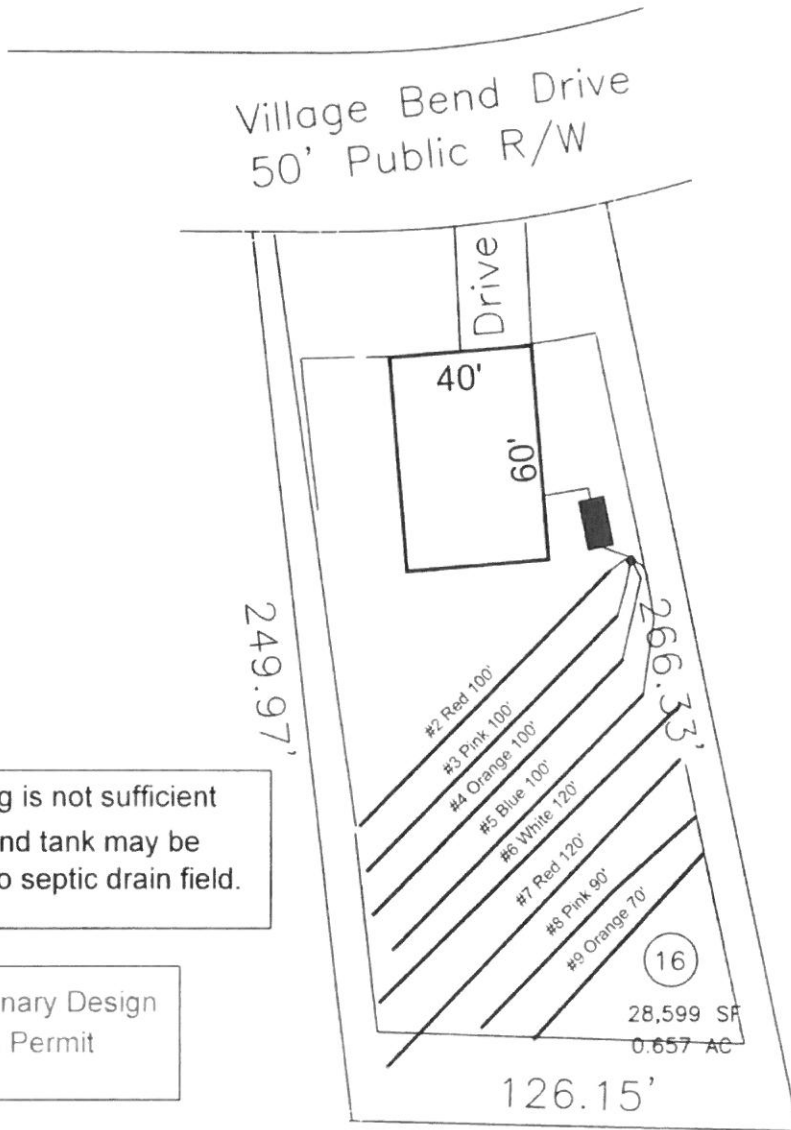

If plumbing is not sufficient
a pump and tank may be
required to septic drain field.

*Preliminary Design
Not a Permit

System: Gravity to D-Box
 Lines: 1-4 (400')
 0.3 LTAR
 24" Trench Bottom
 Accepted Status System
 Repair: Pressure Manifold
 Lines: 5-9 (400')
 0.3 LTAR
 24 Trench Bottom
 Accepted Status System

16
28,599 SF
0.657 AC

GRAPHIC SCALE
1" = 50'



Adams
Soil Consulting
919-414-6761
Job #699