

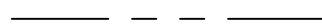



LEGEND

-  Surveyed Property Line
-  Right-of-Way Line
-  Easement Line
-  Property Line - Not Surveyed
-  EIP - Existing Iron Pipe
-  ISS - Iron Stake Set
-  EIS - Existing Iron Stake



NOF
LOT 5
EAKER/PATTERSON MAP
MB 2010, PG 815

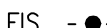
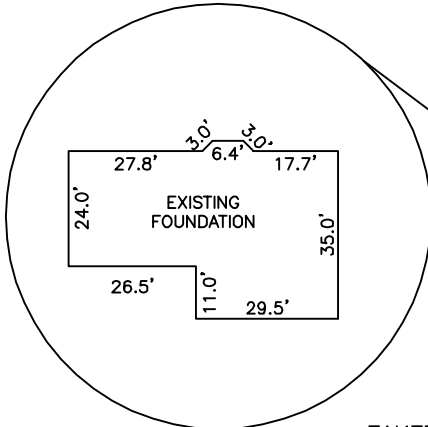
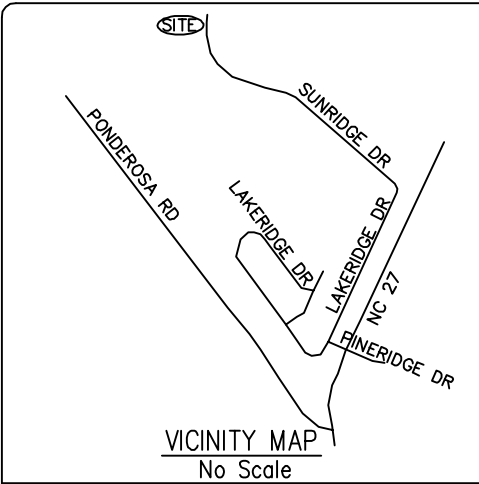
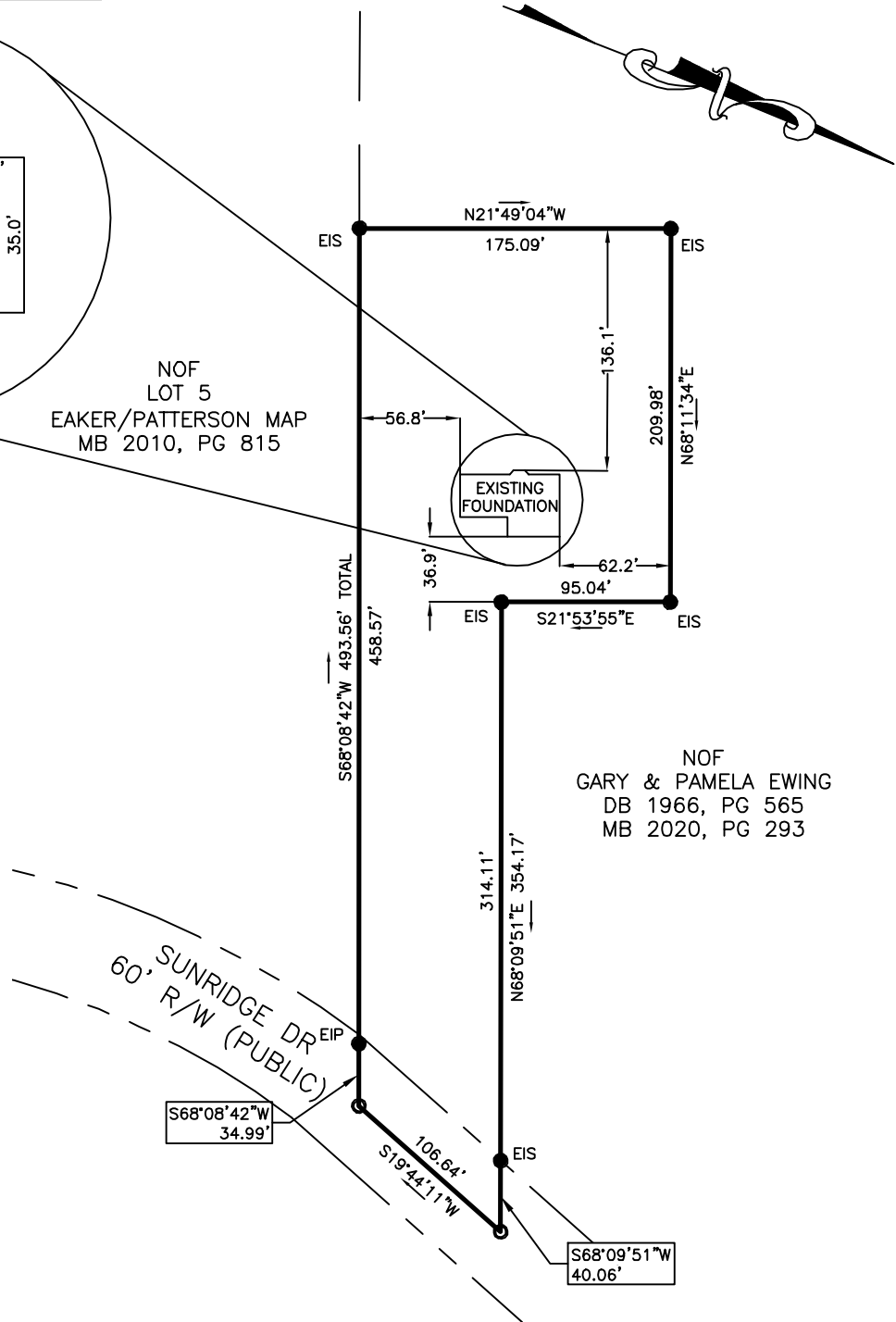

NOF
GARY & PAMELA EWING
DB 1966, PG 565
MB 2020, PG 293

FOUNDATION

BUILDER: J&R HOMES
ADDRESS: SUNRIDGE DR
COUNTY: HARNETT
DATE: February 03, 2022
SCALE: 1" = 100'
SUBDIVISION: RECOMBINATION MAP FOR
 GARY EWING & WIFE PAMELA EWING
 58.56 ACRE TRACT
 MB 2020, PG 293

This map is not for
recording and can not be
used for conveyances.

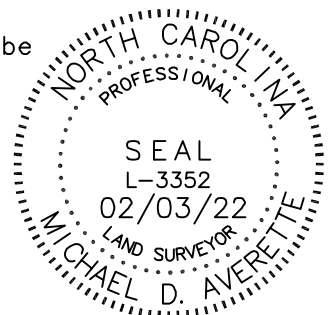

Averette Engineering Co., P.A.
 Established 1970
 CIVIL ENGINEERING
 LAND SURVEYING
 PLANNING

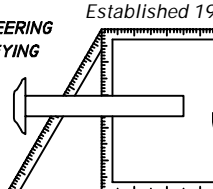

Address:
712 E. Lake Ridge Road
Raeford, NC 28376

Phone: (910) 488-5656
Fax: (910) 488-0181
License: C-0146
Web: www.averette-eng.com

Michael D. Averette
 MICHAEL D. AVERETTE L-3352
 Professional Land Surveyor

February 03, 2022
 Date

sunridge