

HARNETT DEPARTMENT OF PUBLIC HEALTH PERMIT  
TO CONSTRUCT A DRINKING WATER SUPPLY WELL

5566-53 6449.000

PIN #: \_\_\_\_\_ Parcel #: \_\_\_\_\_ Application #: \_\_\_\_\_ Subdivision: \_\_\_\_\_ Lot #: \_\_\_\_\_

Applicant Name: Patrick + ALINE Artry  
Address: \_\_\_\_\_

Type of Facility Served by Well: SFD

Sewage System: Low Profile Chamber

Permit Conditions: \_\_\_\_\_

General Permit Conditions:

- Drinking water supply well construction must meet 15A NCAC 02C.100 rules
- The permitted drinking water supply well shall be located in accordance with the **SITE PLAN**
- **ANY ALTERATION** of the site of the site (including location of structures and appurtenance) or modification in use of the well, may subject this Permit to revocation

Authorized State Agent James E. Mashout <sup>W.P. 25848</sup> Date 11-6-20

Grouting Inspection Witnessed \_\_\_\_\_ Date \_\_\_\_\_  
 Grouting self-certified by driller GW-1 provided?  Yes  No

See attachment for construction sketch

**WELL CERTIFICATE OF COMPLETION**

Date: \_\_\_\_\_ Application #: \_\_\_\_\_ Well Contractor: \_\_\_\_\_

Applicant Name: \_\_\_\_\_  
Address: \_\_\_\_\_  
Directions to Site: \_\_\_\_\_

Use of Well: \_\_\_\_\_ Date Drilled: \_\_\_\_\_ Total Depth: \_\_\_\_\_ Replacement Well?  Yes  No  
Static Water Level: \_\_\_\_\_ Top of Casing is \_\_\_\_\_ in. above surface. Yield: \_\_\_\_\_ gpm at \_\_\_\_\_ ft.  
Disinfection: Type \_\_\_\_\_ Amount \_\_\_\_\_

**Water Zone (depth)**

From \_\_\_\_\_ To \_\_\_\_\_  
From \_\_\_\_\_ To \_\_\_\_\_  
From \_\_\_\_\_ To \_\_\_\_\_

**Casing**

From \_\_\_\_\_ To \_\_\_\_\_  
Diameter: \_\_\_\_\_ Material: \_\_\_\_\_ Thickness: \_\_\_\_\_  
From \_\_\_\_\_ To \_\_\_\_\_  
Diameter: \_\_\_\_\_ Material: \_\_\_\_\_ Thickness: \_\_\_\_\_  
From \_\_\_\_\_ To \_\_\_\_\_  
Diameter: \_\_\_\_\_ Material: \_\_\_\_\_ Thickness: \_\_\_\_\_

**Grout**

From 0 To \_\_\_\_\_  
Material: \_\_\_\_\_ Method: \_\_\_\_\_  
From \_\_\_\_\_ To \_\_\_\_\_  
Material: \_\_\_\_\_ Method: \_\_\_\_\_  
From \_\_\_\_\_ To \_\_\_\_\_  
Material: \_\_\_\_\_ Method: \_\_\_\_\_

Inspector: \_\_\_\_\_ On Hold Date: \_\_\_\_\_ Release Date: \_\_\_\_\_

Remarks: \_\_\_\_\_

**Well Head Information**

Casing Height: \_\_\_\_\_ (above finished grade) Access Port: \_\_\_\_\_ Vent Stack: \_\_\_\_\_  
Well ID Tag: \_\_\_\_\_ Pump ID Tag: \_\_\_\_\_ Sampling Tap: \_\_\_\_\_ Backflow Preventer: \_\_\_\_\_  
Sample Taken?  Yes  No Well Head properly sealed: \_\_\_\_\_

Remarks: \_\_\_\_\_

Authorized State Agent \_\_\_\_\_ Date \_\_\_\_\_

See Attachment for completion sketch

SD 2008-0055

Application #:

Applicant Name:

Subdivision: \_\_\_\_\_

Lot #: \_\_\_\_\_

*Patrick + Alexis Artny*

**Well Construction Sketch**

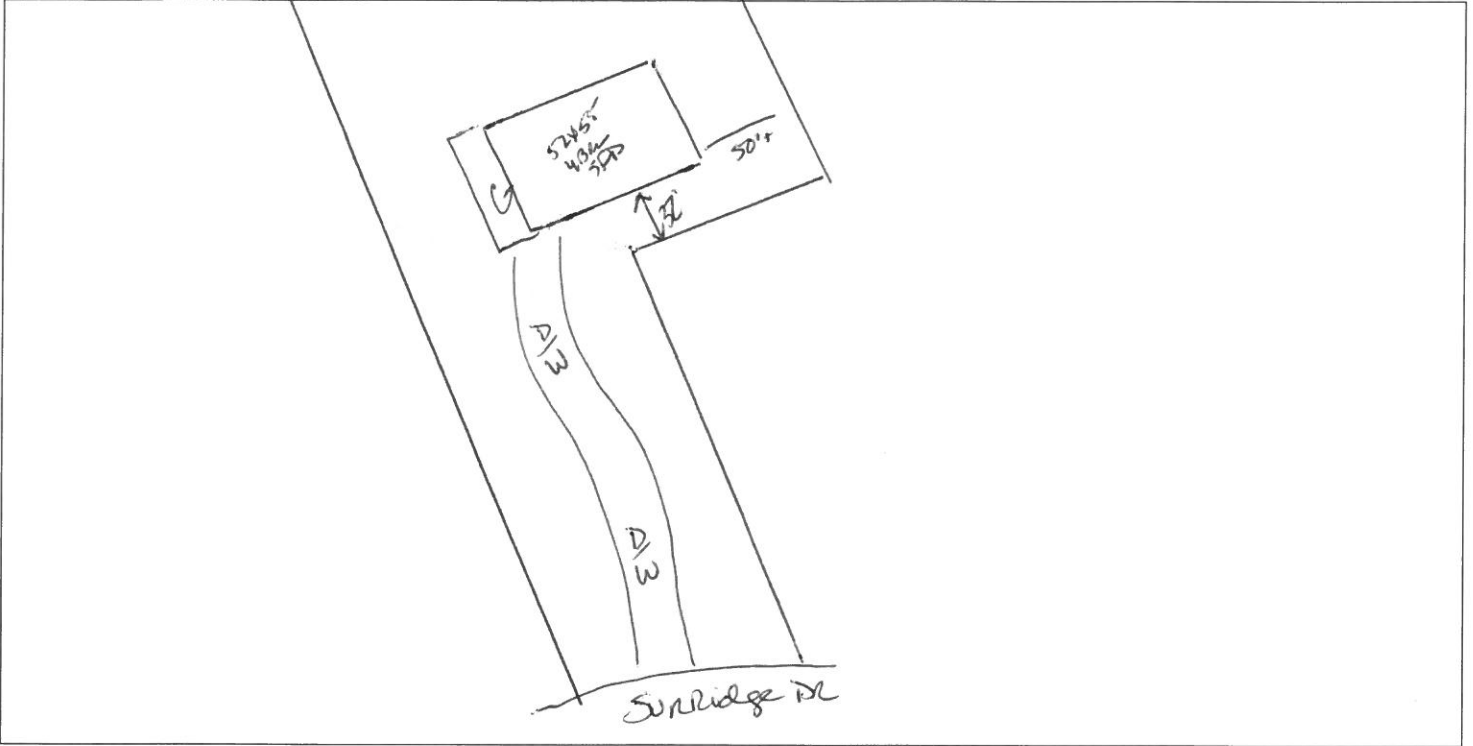

**Well Completion Sketch**

